

N 1669871.16 E 1652044.55
 STA. 0+08.06, LINE 4 =
 STA. 0+79.52 MOSLEY-S, 21.41' RT.
 1-8"x8"x8" MJ TEE
 1-8" ANCHORED GV ASS'Y (E)

N 1669863.10 E 1652044.34
 STA. 0+00.00, LINE 4 =
 STA. 0+71.47 MOSLEY-S, 21.07' RT.
 CONNECT TO EXIST. 6" MAIN
 * 1-6" TAPPING VALVE
 * 1-6"x6" TAPPING SLEEVE
 ** 1-6" VALVE BOX ASS'Y.
 VALVE BOX ELEV. 1282.25
 1-6"x8" REDUCER
 *SUPPLIED AND INSTALLED BY
 CITY OF WICHITA WATER DEPT.
 ** SUPPLIED BY C.O.W.
 INSTALLED BY CONTRACTOR

N 1669884.96 E 1652044.91
 STA. 0+21.87, LINE 4 =
 STA. 0+93.32 MOSLEY-S, 22.00' RT.
 1-8" MJ BEND 45° (VERT.)

N 1669890.96 E 1652044.82
 STA. 0+27.87, LINE 4 =
 STA. 0+99.32 MOSLEY-S, 22.00' RT.
 1-8" MJ BEND 45° (VERT.)

N 1669915.03 E 1652044.43
 STA. 0+51.94, LINE 4 =
 STA. 1+23.39 MOSLEY-S, 22.00' RT.
 1-8" MJ BEND 45° (VERT.)

N 1669932.09 E 1652044.15
 STA. 0+69.00, LINE 4 =
 STA. 1+40.45 MOSLEY-S, 22.00' RT.
 1-8" MJ BEND 45° (VERT.)

N 1669934.19 E 1652044.12
 STA. 0+71.10, LINE 4 =
 STA. 1+42.55 MOSLEY-S, 22.00' RT.
 1-8" MJ BEND 45° (VERT.)

N 1669910.96 E 1652044.49
 STA. 0+47.87, LINE 4 =
 STA. 1+19.32 MOSLEY-S, 22.00' RT.
 1-8" MJ BEND 45° (VERT.)

N 1669910.96 E 1652044.49
 STA. 0+47.87, LINE 4 =
 STA. 1+19.32 MOSLEY-S, 22.00' RT.
 1-8" MJ BEND 45° (VERT.)

WATER METER SUMMARY				
BL Station	Lt./Rt.	Service (Long or Short)	Address	As Built
1+49	Rt.	Short	2744 S. MOSLEY	
1+58	Lt.	Long	2745 S. MOSLEY	
2+02	Rt.	Short	2738 S. MOSLEY	

WATER METER SUMMARY				
BL Station	Lt./Rt.	Service (Long or Short)	Address	As Built
2+11	Lt.	Long	2739 S. MOSLEY	
2+56	Rt.	Short	2732 S. MOSLEY	
2+64	Lt.	Long	2733 S. MOSLEY	

WATER METER SUMMARY				
BL Station	Lt./Rt.	Service (Long or Short)	Address	As Built
3+22	Lt.	Long	2727 S. MOSLEY	
3+23	Rt.	Short	2726 S. MOSLEY	
3+76	Lt.	Long	2721 S. MOSLEY	

WATER METER SUMMARY				
BL Station	Lt./Rt.	Service (Long or Short)	Address	As Built
3+76	Rt.	Short	2720 S. MOSLEY	
4+30	Rt.	Short	2714 S. MOSLEY	
4+32	Lt.	Long	2715 S. MOSLEY	

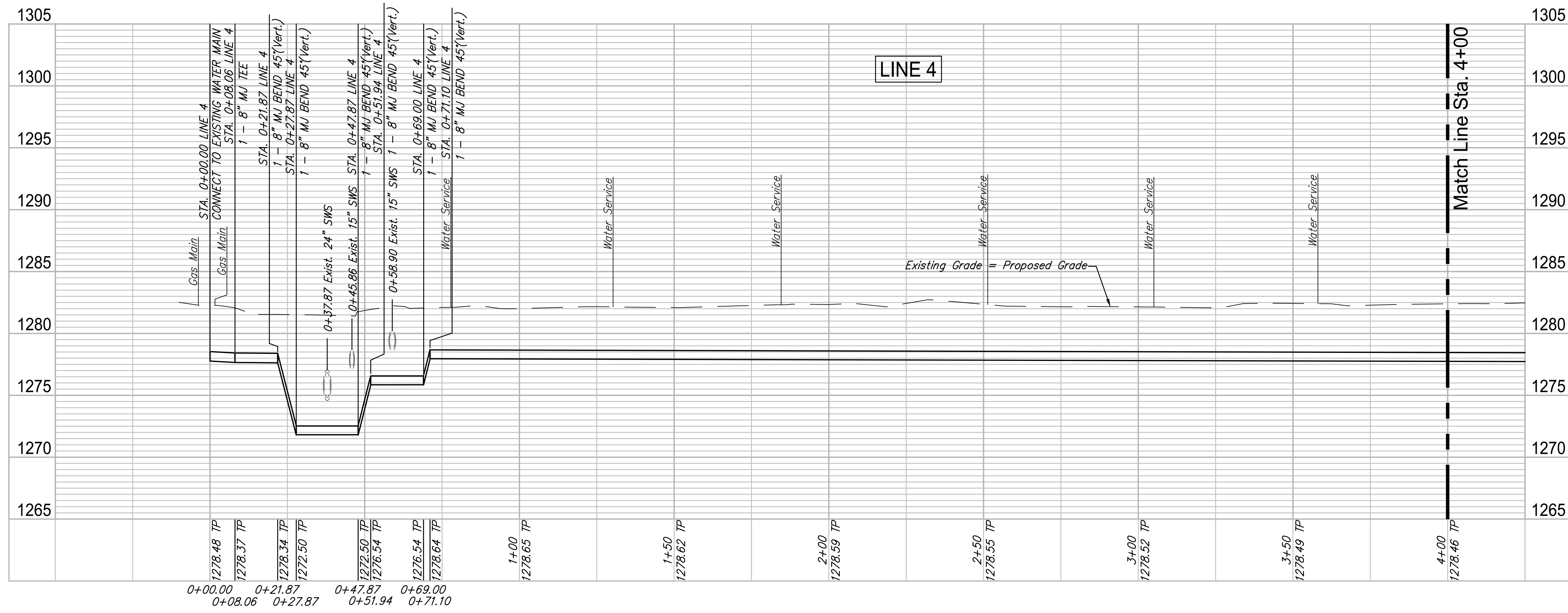

Contractor to coordinate with Westar to support pole during construction.

Replace Wheel Chair Ramp



Existing Pavement, Curb and Gutter to be Removed and Replaced as necessary for construction. No additional pay shall be made for this work, Subsidiary to other pay items.



REVIEW 12-7-16
 DATE 4/2/2018
 DESIGN CMB / RA
 DRAWING FILE DRS / RA
 PROJECT NUMBER 448-30721
 DRAWING FILE LINE 4 - Mosley 1-2

ROSE MARIE WATER - Part A
 MOSLEY - LINE 4 (1 of 3)
 Wichita, Kansas

GARVER JOB 4701W
 SHEET 17 OF 57
 © Copyright 2018, Garver

F:\Projects\Projects 4700-4799\4701W (Rose Marie waterline replacement)\LINE 4 - Mosley 1-2.dwg