

Pawnee Road
Existing AC Pavement

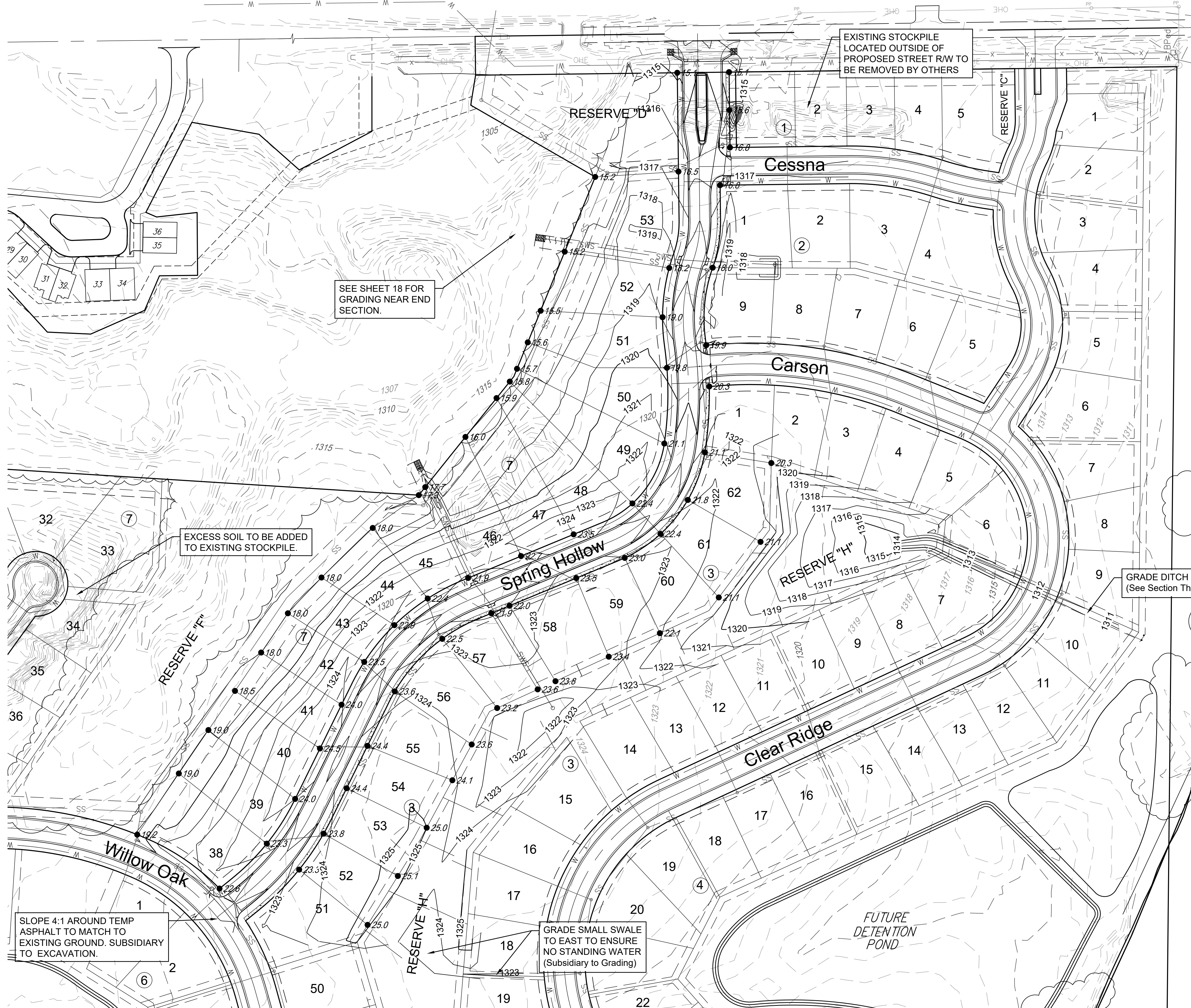

SEE SHEET 18 FOR GRADING NEAR END SECTION.

EXCESS SOIL TO BE ADDED TO EXISTING STOCKPILE.

SLOPE 4:1 AROUND TEMP ASPHALT TO MATCH TO EXISTING GROUND. SUBSIDIARY TO EXCAVATION.

GRADE SMALL SWALE TO EAST TO ENSURE NO STANDING WATER (Subsidiary to Grading)

EXISTING STOCKPILE LOCATED OUTSIDE OF PROPOSED STREET R/W TO BE REMOVED BY OTHERS

GRADE DITCH 411 LF (See Section This Sheet)

EARTHWORK QUANTITIES

Description	Cu. Yds.
Cut	15,400
Fill	12,300
Net Cut From Sanitary Sewer	2,800
Net (Cut)	(5,900)

- Notes:
- Approximately 2800 CY of excess material will be placed across lots 39-51, Block 7 during construction of sanitary sewer and water main. The contractor shall factor this in as shown in the table above as the dirt will not be reflected in the existing ground surface. The contractor shall familiarize themselves with the site as the dirt from sanitary sewer and water projects will be placed prior to bidding this project. Any moving of excess dirt from the sanitary and water will not be reflected in the pay quantities and will be subsidiary to Excavation.
 - Grades and contours on this sheet reflect the top of proposed pavement and finished grade.
 - No shrink or swell factors have been applied to the earthwork quantities shown on this project. All earthwork quantities are based on raw surface volume comparisons.
 - Excess dirt generated from installation of underground storm sewer or grading activities is to remain on site and be added to existing stockpile on Lots 27-36, Block 7. Contractor to ensure stockpiles are not placed in Zone A of FEMA flood plain.

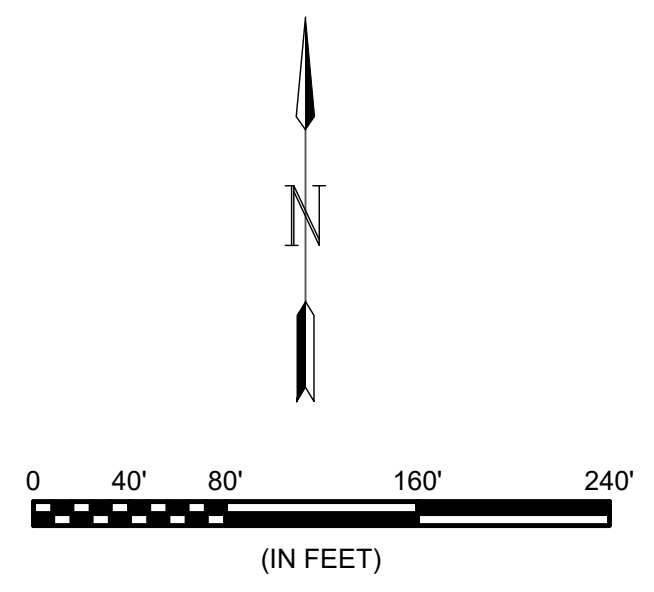
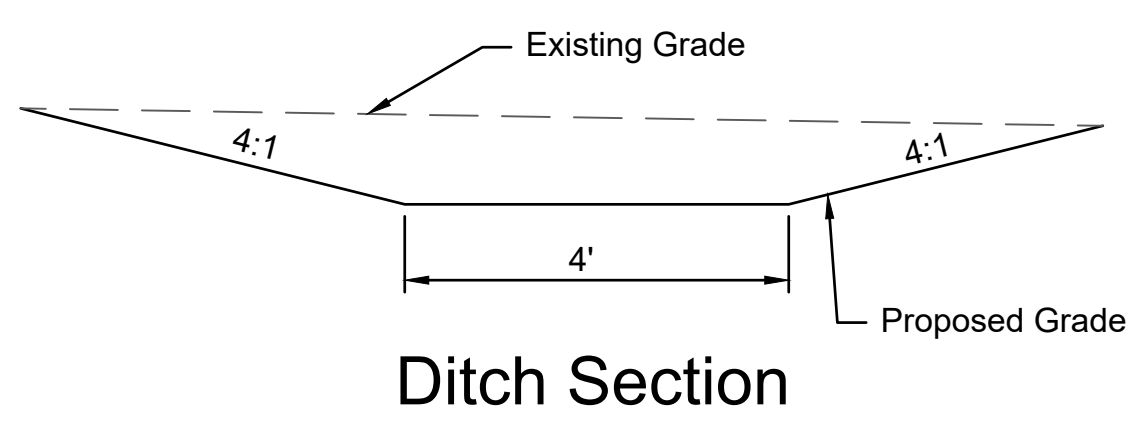

File: L:\2017\17264889 - Clear Ridge Phase 1\Drawings\C3D\Paving + Storm\21 - Grading Plan.dwg Last Save: 10/11/2018 9:19 AM Last saved by: MTDolechek
 Last plotted by: Dolechek, Mark T. Plot Date: 10/11/2018 9:31 AM Plotter used: None
 Plot Style: --- Plot Scale: 1:2,885

© 2017 GARVER, LLC
 THIS DOCUMENT, ALONG WITH THE IDEAS AND DESIGNS CONVEYED HEREIN, SHALL BE CONSIDERED INSTRUMENTS OF PROFESSIONAL SERVICE AND ARE PROPERTY OF GARVER, LLC. ANY USE, REPRODUCTION, OR DISTRIBUTION OF THIS DOCUMENT, ALONG WITH THE IDEAS AND DESIGN CONTAINED HEREIN, IS PROHIBITED UNLESS AUTHORIZED IN WRITING BY GARVER, LLC OR EXPLICITLY ALLOWED IN THE GOVERNING PROFESSIONAL SERVICES AGREEMENT FOR THIS WORK.

Mark T. Dolechek
 No. 10124
 25299
 KANSAS
 PROFESSIONAL ENGINEER

Digitally Signed 10/11/2018

BY	DATE	DESCRIPTION

CITY OF WICHITA
 WICHITA, KS
 CLEAR RIDGE ADDITION,
 PHASE 1

Grading Plan

JOB NO.: 17264889
 DATE: OCT 2018
 DESIGNED BY: MTD
 DRAWN BY: MTD/CDJ

BAR IS ONE INCH ON ORIGINAL DRAWING
 0" = 1" IF NOT ONE INCH ON THIS SHEET, ADJUST SCALES ACCORDINGLY.

DRAWING NUMBER

SHEET NUMBER **22** OF **25**