

Private Project Storm Water Sewer STORM WATER SEWER IMPROVEMENTS to serve

Lot 2, Except the South 100 feet and Except the North 205 feet of the East 160 feet, in Gilders Gardens Subdivision (SECURITY SELF STORAGE)

CITY OF WICHITA, KANSAS

James L. Armour, P.E. City Engineer

Project Number

1721 PPS (607861)

GENERAL NOTES:

- Contractor will be required to provide notice to utility companies a minimum of forty-eight (48) hours prior to any excavation, as follows:

Kansas One-Call	687-2470
-----------------	----------

The Contractor must notify the following in case of an emergency:

Cox Communications	262-4270
Kansas Gas Service	1-888-482-4950
Westar Energy	383-8650
Aquila Energy	1-888-482-4950
SBC	268-2245
City of Wichita Water Dept.	268-4563
City of Wichita Sewer Maint.	268-4024
City of Wichita Storm Sewer Maint.	268-4090
City of Wichita Traffic Maint.	268-4034
Conoco Pipeline Co.	1-800-231-2551
- Underground utility service lines and overhead utility pole lines are to be adjusted as necessary by others prior to construction unless the plans specifically call for their adjustment by the Contractor or unless the plans specifically identify a utility to be adjusted by its owner during construction. Existing utilities and their location, as shown on the plans, represent the best information obtainable for design. The Contractor will be required to work around existing utilities within the right-of-way which do not conflict with proposed construction.
- Trees and shrubs in public right-of-way which are in direct conflict with proposed new construction shall be removed by the Contractor with the Engineer's approval. Trees and shrubs which are not in direct conflict with proposed new construction shall be saved and protected from damage.
- The Contractor shall give all property owners and/or tenants of developed property abutting the construction of this project a minimum of ten (10) days advance notice prior to start of construction.
- The Contractor shall be responsible for preserving property irons. The Contractor will be required to re-establish any property irons which are damaged or destroyed by his construction operations. Such irons shall be re-established by a licensed land surveyor in accordance with state laws.
- All excavation & trenching material shall be stockpiled or spread out on site as determined by the Engineer.
- All existing and proposed erosion control measures including silt fencing, erosion control mat, straw bales, inlet barriers, and const. entrance shall be maintained throughout construction by the contractor and until project is accepted by the City of Wichita. The on-site engineer shall complete weekly reports on the status of erosion control measures. The contractor shall be required to comply with maintenance and/or replacement of erosion control measures as determined by the on-site engineer until project is accepted by City of Wichita. Maintenance and/or replacement of erosion control measures to be paid by L.S. bid item "Site Clearing & Restoration"
- Contractor shall refer to the Site Erosion Control Plan for required erosion control measures and coordinate with General Contractor as to installation and maintenance requirements.
- Site Grading Plan is for Information Only. Site Grading is NOT a bid item with this plan set.



Benchmarks
 BENCHMARK:
 □ Cut on the SW Corner of Central and Garnett.
 Elev. = 1360.34 M.S.L.

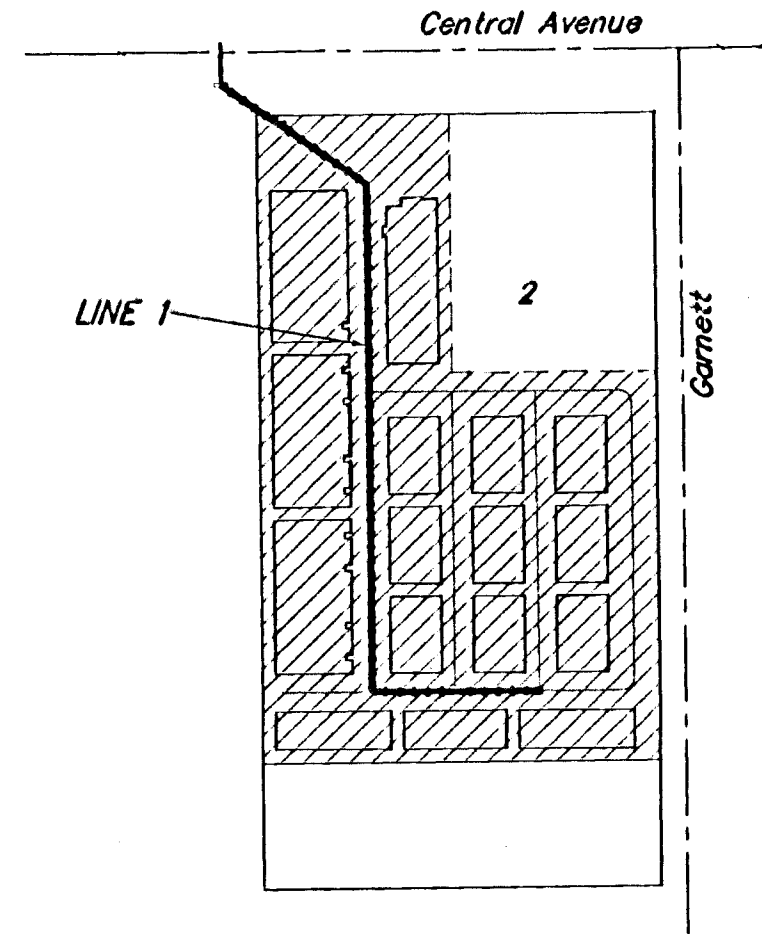

Sheet Index

Title Sheet	1
Line 1	2-3
Type 1 Curb Inlet	4
Standard Drop Inlet Detail	5
Ring & Cover Detail	6
Plot	7
Site Grading Plan (Info Only)	8
Site Erosion Control Plan	9

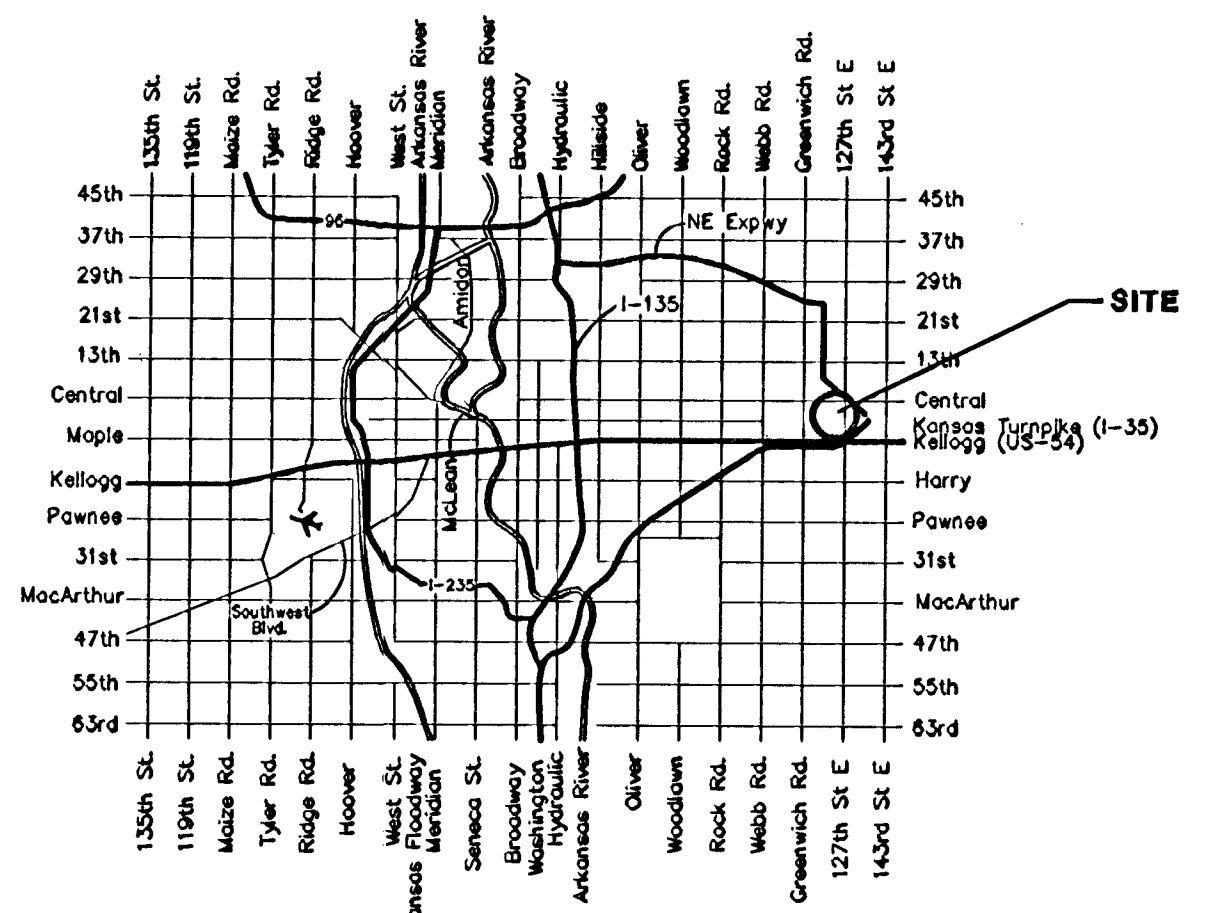

Vicinity Map

Benefit District

APPROVED AS NOTED
BY CITY ENGINEER OF WICHITA

Sanitary Sewers 11/15/06

Storm Sewers 11/15/06

Driveway Approaches _____

Water Mains _____

Paving _____

NOTE TO CONTRACTORS

Installation, inspection and testing for this project is to be provided by a Licensed Consulting Engineering Firm under contract with the Owner/Developer. Said inspection to be in accordance with the City of Wichita standard construction engineering practices and certified by a Licensed Professional Engineer. No work shall be performed in dedicated easements or public right-of-way by the Contractor without such inspection nor shall any work be commenced without written authorization by the City Engineer. All Construction and Materials shall comply with the City of Wichita Specifications and Standards (on file and available in the City Engineer's Office).

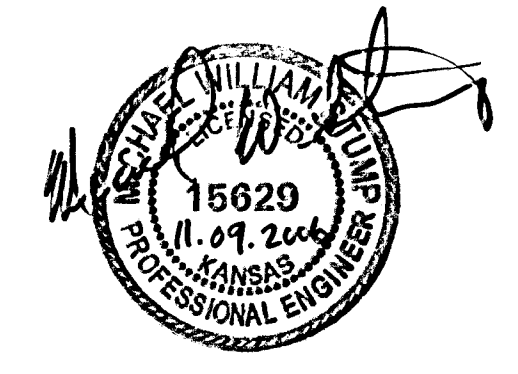
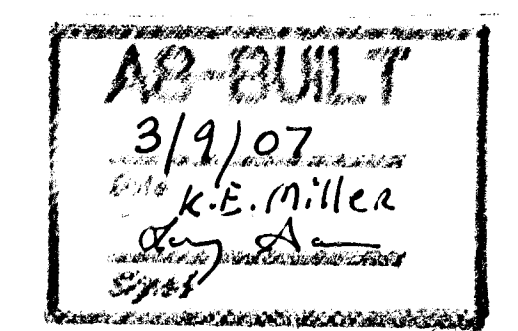

Baughman Company, P.A. 315 Ellis St. Wichita, KS 67211 P 316-262-7271 F 316-262-0194
 ENGINEERING | SURVEYING | PLANNING | LANDSCAPE ARCHITECTURE