

BENCHMARK:
CITY OF WICHITA DISC - MAIZE RD. & STERLING,
(2400 BLOCK N.), TOP OF CURB, WEST END OF
MEDIAN ON C OF STERLING.
61' E. OF C OF MAIZE RD.
ELEV. = 1353.57 NGVD29

SMALL RAILROAD SPIKE IN E. FACE OF POWER POLE,
34.6' S. & 6.9' W. OF THE NW COR. OF LOT 2,
BLOCK A.
ELEV. = 1351.99 NGVD29

SCALE:
1" = 20' HORIZONTAL
• = IRON

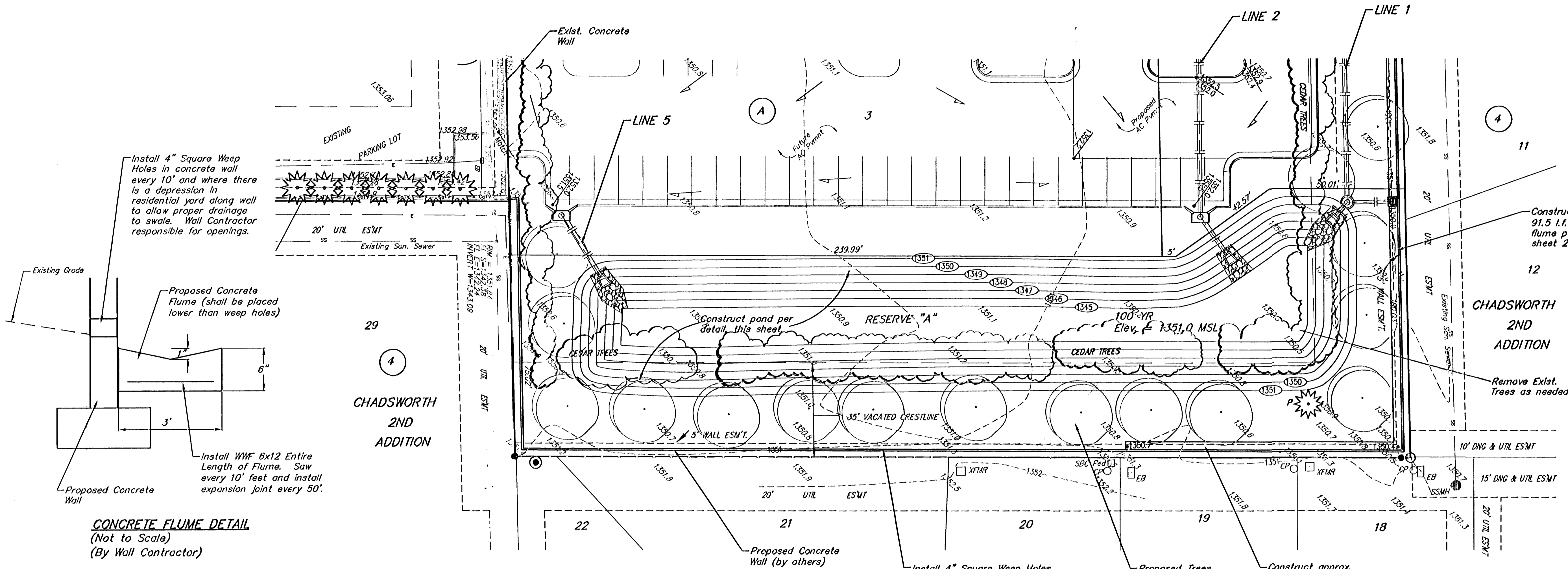

Existing Utilities on site should be disconnected prior to start of Construction. Contractor to verify and coordinate with General Contractor.

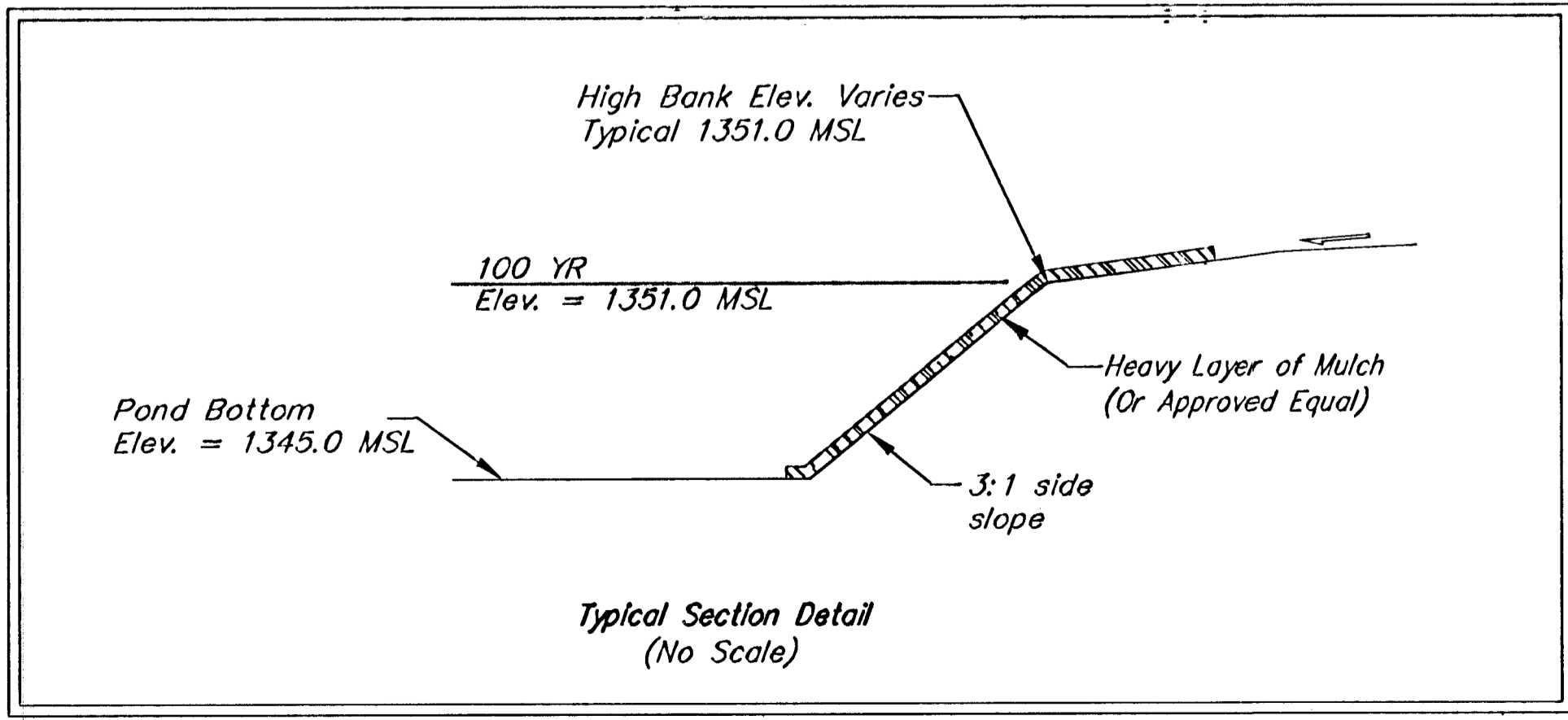

—(175)— Existing Grade
—175— Proposed Grade

NOTES:

- All of Reserve "A" including pond sides and bottom shall be seeded and mulched as follows: (Permanent Seeding)
SEED --- Fescue K-31; 8#/1000 Sq. Ft.
FERTILIZER --- 12-24-12 Ratio at 350 Lbs./Ac.
MULCH --- 2 Tons Prairie Hay / Acre (Heavier along pond side slopes)

All other disturbed areas not in Reserve "A" are to be seeded as follows: (Temporary seeding)
SEED --- Rye grass (PLS)---5#/1000 Sq. Ft.

Permanent Seeding and Temporary Seeding shall both be including in bid item "Project Seeding".

EARTH WORK TOTALS

	C.Y. Excavation	C.Y. Fill
Pond Construction	2008	26
Total	2008	26

Stockpile excess material, if any, on-site at a location determined by the Engineer out of easements and right-of-way. Earthwork quantities are for reference only. All cost associated with mass grading shall be incidental to lump sum bid item "Mass Grading".

- Contractor to stockpile enough top-soil to redistribute over Reserve 'A' above the water surface to achieve plan grade.
- Compaction of 95% shall be obtained in all street R/W's, 90% in all other areas.
- It shall be the Contractor's responsibility to protect the sanitary sewer and water distribution system during pond construction. Any damage done to these systems by Contractor or subcontractor shall be repaired at no additional cost to the project.

Baughman Chadsworth Development
Pond
Storm Water Sewer Improvements

Baughman Company, P.A. 315 Ella St. Wichita, KS 67111 P 316-262-7771 F 316-262-0149
ENGINEERING | SURVEYING | PLANNING | LANDSCAPE ARCHITECTURE

PROJECT NUMBER 1702 PPS	DESIGN MWS	DRAWN MWS
REVISIONS	APPROVED	DATE 09/06
	SCALE Noted	SHEET 2 OF 12

B:\eng\ES_Development\ssw1.dwg 06-05-E562