

**BENCHMARKS:**

BM #1: "□" Cut on T.C., 12' west of east end of N curb return on the north drive entrance of the Church of the Magdalen.  
Elev. = 190.48 (City Datum)

BM #2: RR spike on the west face of PP on the east side of 127th Street East, adjacent to the south line of The Fairmont Addition.  
Elev. = 187.25 (City Datum)

BM #3: RR spike on the east face of PP on the west side of 127th Street East, 37' N and 13' E of the NE corner of Lot 1, Block H, The Fairmont Addition.  
Elev. = 189.19 (City Datum)

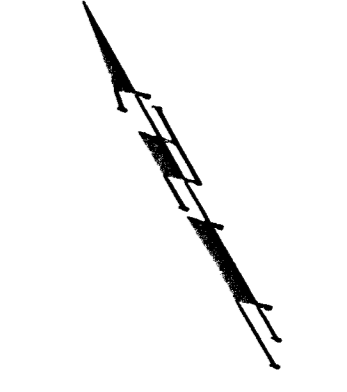

Scale: 1" = 20'  
• = Iron

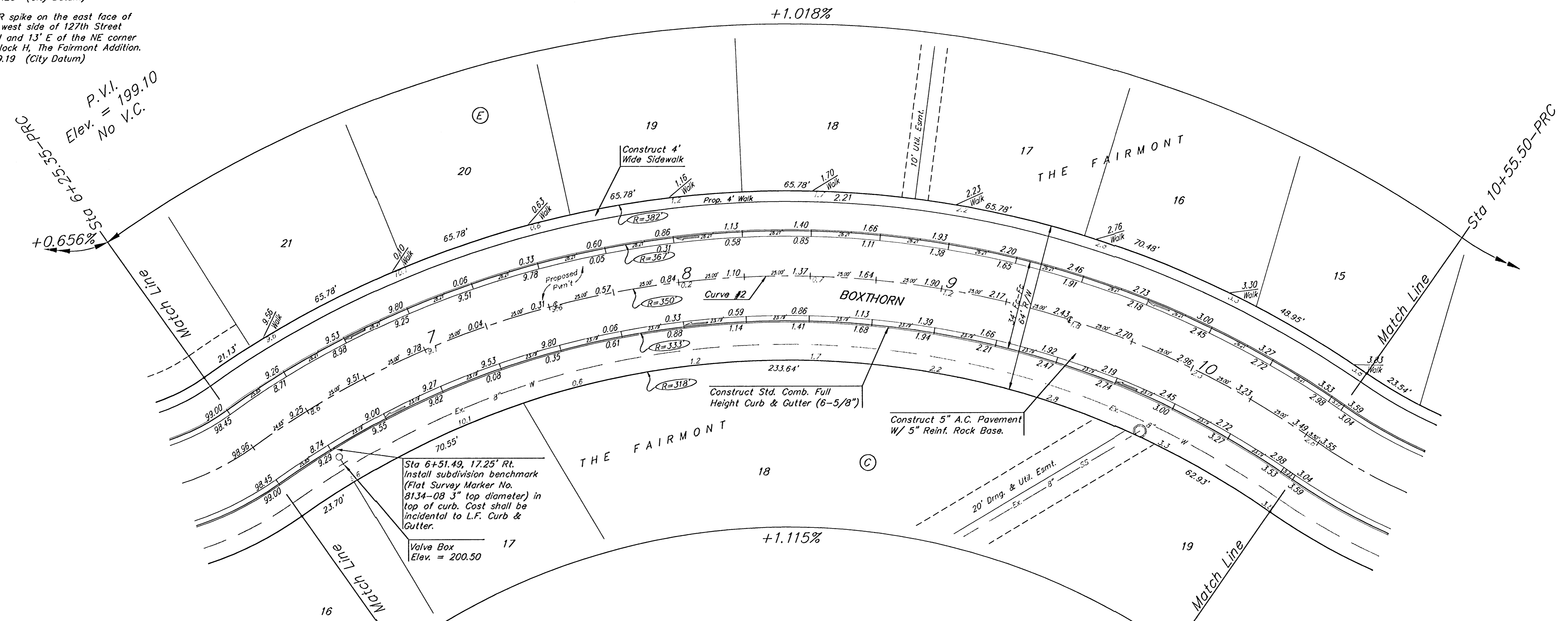

P.V.I. = 199.10  
Elev. No V.C.  
Sta 6+25.35-PRC  
+0.656%

Sta 6+51.49, 17.25' Rt.  
Install subdivision benchmark  
(Flat Survey Marker No. 8134-08 3" top diameter) in top of curb. Cost shall be incidental to L.F. Curb & Gutter.

Valve Box  
Elev. = 200.50

Curve #2  
Curve Data Based on Centerline  
Rad. = 350' Delta = 70° 24' 57" Tangent = 246.97'  
Arc = 430.15' L.C. = 403.58' Def/Ft. = 4.91102 Min.

Station	Arc	FACE CHORD LENGTHS		Defl.	T. Defl.
		8' Lt.	8' Rt.		
6+25.35	-	-	-	0°00'00"	0°00'00"
6+50.00	24.65'	26.41'	22.88'	2°01'03"	2°01'03"
6+75.00	25.00'	26.78'	23.21'	2°02'46"	4°03'50"
7+00.00	25.00'	26.78'	23.21'	2°02'46"	6°06'36"
7+25.00	25.00'	26.78'	23.21'	2°02'46"	8°09'23"
7+50.00	25.00'	26.78'	23.21'	2°02'46"	10°12'09"
7+75.00	25.00'	26.78'	23.21'	2°02'46"	12°14'56"
8+00.00	25.00'	26.78'	23.21'	2°02'46"	14°17'42"
8+25.00	25.00'	26.78'	23.21'	2°02'46"	16°20'29"
8+50.00	25.00'	26.78'	23.21'	2°02'46"	18°23'15"
8+75.00	25.00'	26.78'	23.21'	2°02'46"	20°26'02"
9+00.00	25.00'	26.78'	23.21'	2°02'46"	22°28'48"
9+25.00	25.00'	26.78'	23.21'	2°02'46"	24°31'35"
9+50.00	25.00'	26.78'	23.21'	2°02'46"	26°34'22"
9+75.00	25.00'	26.78'	23.21'	2°02'46"	28°37'08"
10+00.00	25.00'	26.78'	23.21'	2°02'46"	30°39'55"
10+25.00	25.00'	26.78'	23.21'	2°02'46"	32°42'41"
10+50.00	25.00'	26.78'	23.21'	2°02'46"	34°45'28"
10+55.50	5.50'	5.89'	5.11'	0°27'00"	35°12'28"

+0.517%  
Sta 6+25.35-PRC  
P.V.I. = 199.10  
Elev. No V.C.

+0.859%  
Sta 10+55.50-PRC  
P.V.I. = 203.59  
Elev. No V.C.

THE FAIRMONT - PHASE 2  
**BOXTHORN**  
STA 6+25.35 TO STA 10+55.50

**BAUGHMAN COMPANY P.A.**  
ENGINEERING, SURVEYING, & PLANNING  
316-262-2221 • 315 ELLIS • WICHITA, KANSAS 67211

PROJECT NUMBER  
**472-83484**

DESIGN: NBW DRAWN: TMS APPROVED: DATE: 7/23/03 SCALE: Noted

SHEET **8** OF **30**