

BENCHMARKS:

BM #1: "□" Cut on T.C., 12' west of east end of N curb return on the north drive entrance of the Church of the Magdalen.
Elev. = 190.48 (City Datum)

BM #2: RR spike on the west face of PP on the east side of 127th Street East, adjacent to the south line of The Fairmont Addition.
Elev. = 187.25 (City Datum)

BM #3: RR spike on the east face of PP on the west side of 127th Street East, 37' N and 13' E of the NE corner of Lot 1, Block H, The Fairmont Addition.
Elev. = 189.19 (City Datum)

Scale: 1" = 20'
• = Iron

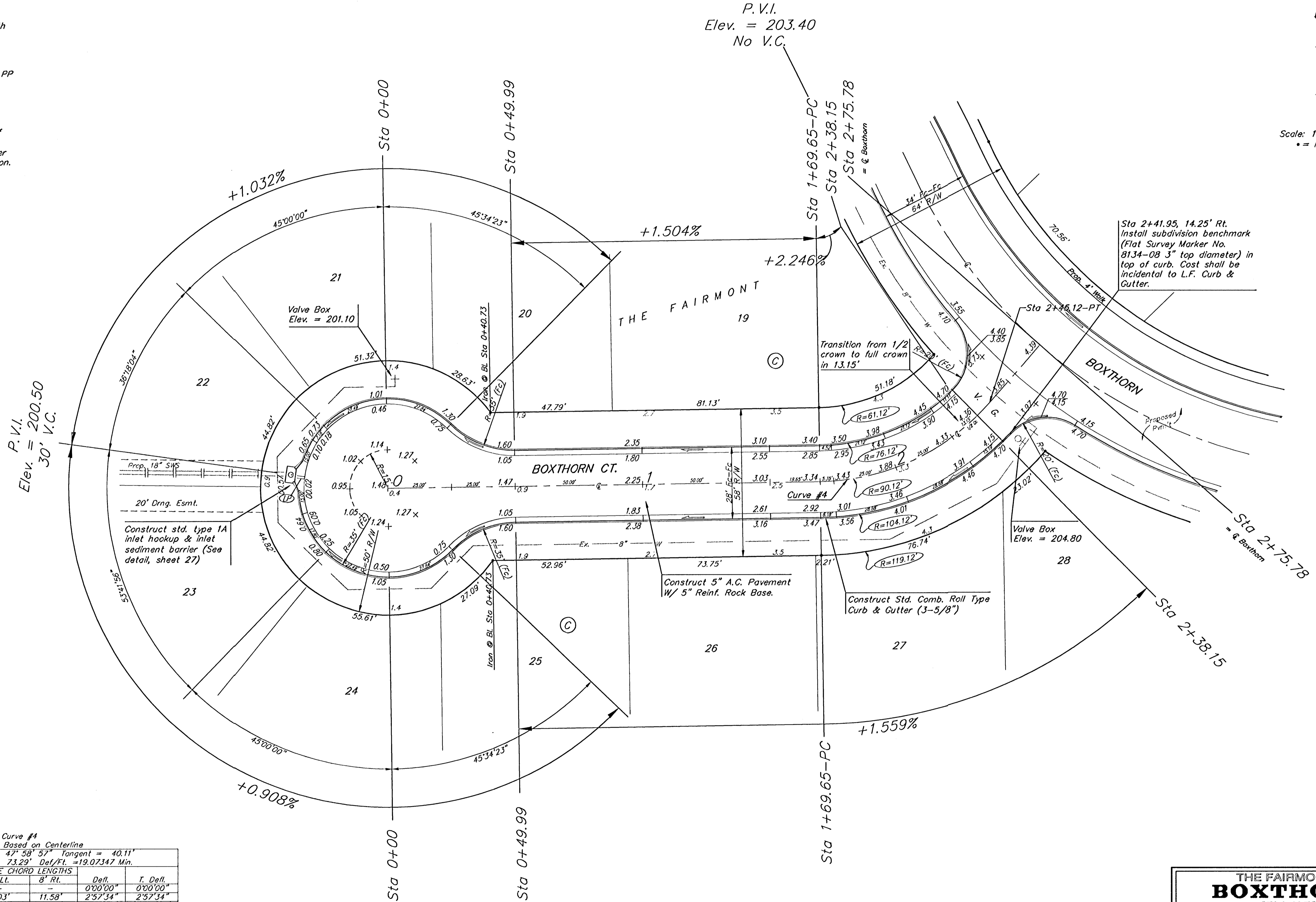

Curve #4
Curve Data Based on Centerline
Rad. = 90.12' Delta = 47° 58' 57" Tangent = 40.11'
Arc = 75.47' L.C. = 73.29' Def./Fl. = 19.07347 Min.

Station	Arc	FACE CHORD LENGTHS		Defl.	T. Defl.
		B' Lt.	B' Rt.		
1+65.69	-	-	-	0°00'00"	0°00'00"
1+75.00	9.31'	7.03'	11.58'	2°57'34"	2°57'34"
2+00.00	25.00'	18.84'	31.00'	7°56'50"	10°54'24"
2+25.00	25.00'	18.84'	31.00'	7°56'50"	18°51'15"
2+38.15	13.15'	9.93'	16.35'	4°10'49"	23°02'04"
2+41.95	3.80'	2.87'	4.73'	1°12'29"	24°14'32"
2+45.12	3.17'	2.40'	3.94'	1°00'28"	25°15'00"

NOTE: ROLL TYPE CURB & GUTTER TO BE CONSTRUCTED ON THE PAVEMENT SHOWN ON THIS SHEET. TOP OF CURB ELEVATIONS ARE GIVEN FOR FULL HEIGHT CURB.

THE FAIRMONT - PHASE 2
BOXTHORN CT.
STA 0+00 TO STA 2+75.78

BAUGHMAN COMPANY P.A.
ENGINEERING, SURVEYING, & PLANNING
316-262-7271 • 315 ELLIS • WICHITA, KANSAS 67211

PROJECT NUMBER
472-83484

DESIGN NBW DRAWN TMS APPROVED DATE 7/23/03 SCALE Noted

SHEET **10** OF **39**