

BENCHMARKS:

BM #1: "□" Cut on T.C., 12' west of east end of N curb return on the north drive entrance of the Church of the Magdalen.
Elev. = 190.48 (City Datum)

BM #2: RR spike on the west face of PP on the east side of 127th Street East, adjacent to the south line of The Fairmont Addition.
Elev. = 187.25 (City Datum)

BM #3: RR spike on the east face of PP on the west side of 127th Street East, 37' N and 13' E of the NE corner of Lot 1, Block H, The Fairmont Addition.
Elev. = 189.19 (City Datum)

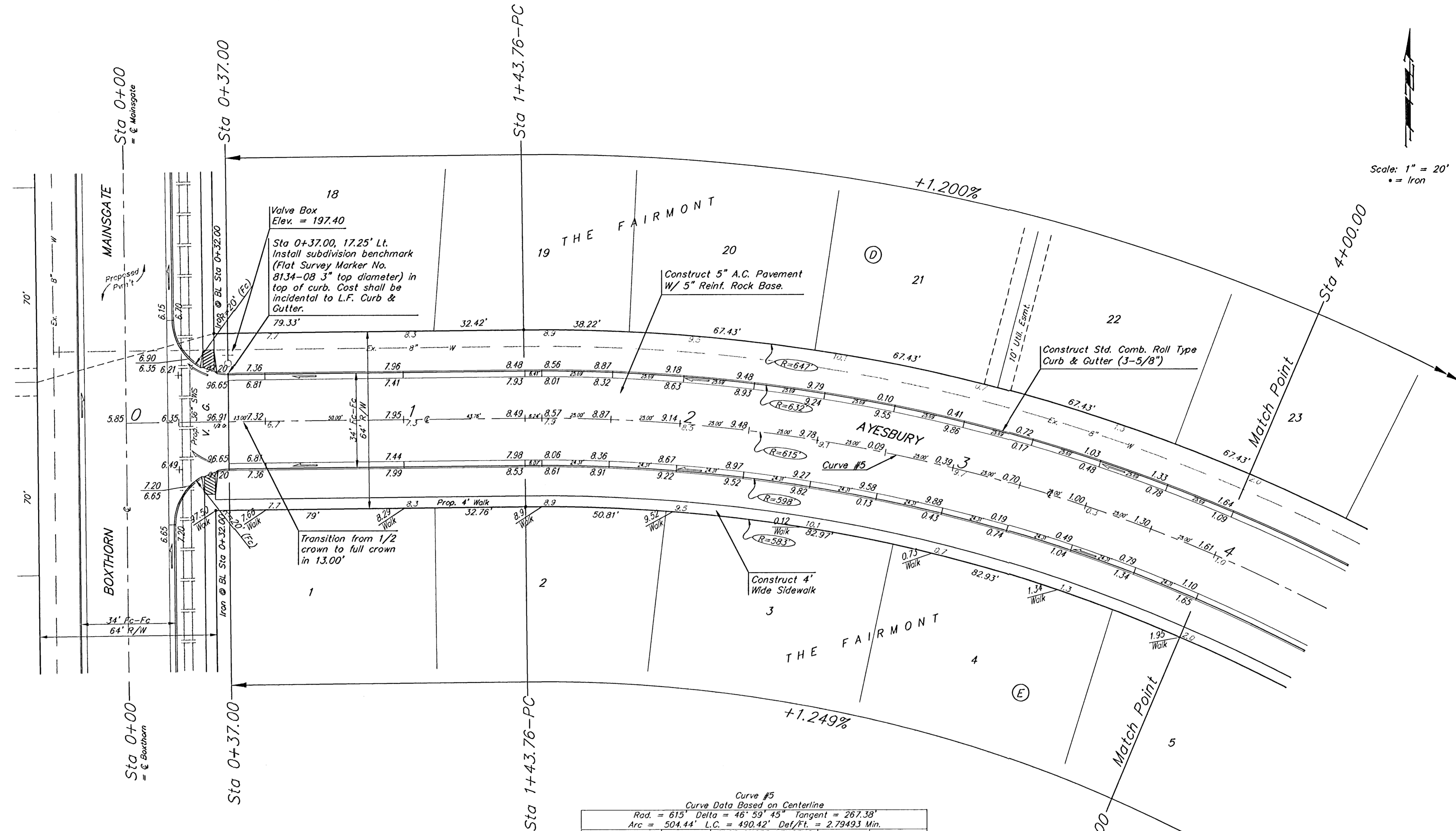
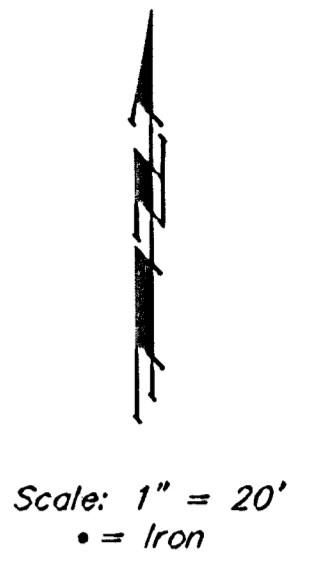

Curve #5
Curve Data Based on Centerline
Rad. = 615' Delta = 46° 59' 45" Tangent = 267.38'
Arc = 504.44' L.C. = 490.42' Def./Ft. = 2.79493 Min.

Station	Arc	FACE CHORD LENGTHS		Defl.	T. Defl.
		8' Lt.	8' Rt.		
1+43.76	-	-	-	0°00'00"	0°00'00"
1+50.00	6.24'	6.49'	5.99'	0°17'26"	0°17'26"
1+75.00	25.00'	26.01'	23.98'	1°09'52"	1°27'19"
2+00.00	25.00'	26.01'	23.98'	1°09'52"	2°37'11"
2+25.00	25.00'	26.01'	23.98'	1°09'52"	3°47'03"
2+50.00	25.00'	26.01'	23.98'	1°09'52"	4°56'56"
2+75.00	25.00'	26.01'	23.98'	1°09'52"	6°06'48"
3+00.00	25.00'	26.01'	23.98'	1°09'52"	7°16'41"
3+25.00	25.00'	26.01'	23.98'	1°09'52"	8°26'33"
3+50.00	25.00'	26.01'	23.98'	1°09'52"	9°36'25"
3+75.00	25.00'	26.01'	23.98'	1°09'52"	10°46'18"
4+00.00	25.00'	26.01'	23.98'	1°09'52"	11°56'10"
4+25.00	25.00'	26.01'	23.98'	1°09'52"	13°06'03"
4+50.00	25.00'	26.01'	23.98'	1°09'52"	14°15'55"
4+75.00	25.00'	26.01'	23.98'	1°09'52"	15°25'47"
5+00.00	25.00'	26.01'	23.98'	1°09'52"	16°35'40"
5+25.00	25.00'	26.01'	23.98'	1°09'52"	17°45'32"
5+50.00	25.00'	26.01'	23.98'	1°09'52"	18°55'25"
5+75.00	25.00'	26.01'	23.98'	1°09'52"	20°05'17"
6+00.00	25.00'	26.01'	23.98'	1°09'52"	21°15'09"
6+25.00	25.00'	26.01'	23.98'	1°09'52"	22°25'02"
6+48.20	23.20'	24.14'	22.26'	1°04'50"	23°29'52"

NOTE: ROLL TYPE CURB & GUTTER TO BE CONSTRUCTED ON THE PAVEMENT SHOWN ON THIS SHEET. TOP OF CURB ELEVATIONS ARE GIVEN FOR FULL HEIGHT CURB.

THE FAIRMONT - PHASE 2
AYESBURY
STA 0+00 TO STA 4+00.00

BAUGHMAN COMPANY P.A.
ENGINEERING, SURVEYING, & PLANNING
318-262-7271 • 315 ELLIS • WICHITA, KANSAS 67211

PROJECT NUMBER
472-83484

DESIGN: NBW DRAWN: TMS APPROVED: [Signature] DATE: 7/23/03 SCALE: Noted

SHEET **11** OF **39**