

**BENCHMARKS:**

BM #1: "X" Cut on T.C., 12' west of east end of N curb return on the north drive entrance of the Church of the Magdalen.  
Elev. = 190.48 (City Datum)

BM #2: RR spike on the west face of PP on the east side of 127th Street East, adjacent to the south line of The Fairmont Addition.  
Elev. = 187.25 (City Datum)

BM #3: RR spike on the east face of PP on the west side of 127th Street East, 37' N and 13' E of the NE corner of Lot 1, Block H, The Fairmont Addition.  
Elev. = 189.19 (City Datum)

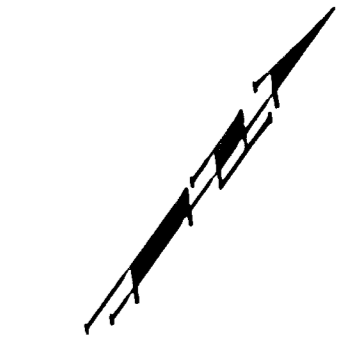

Scale: 1" = 20'  
• = Iron

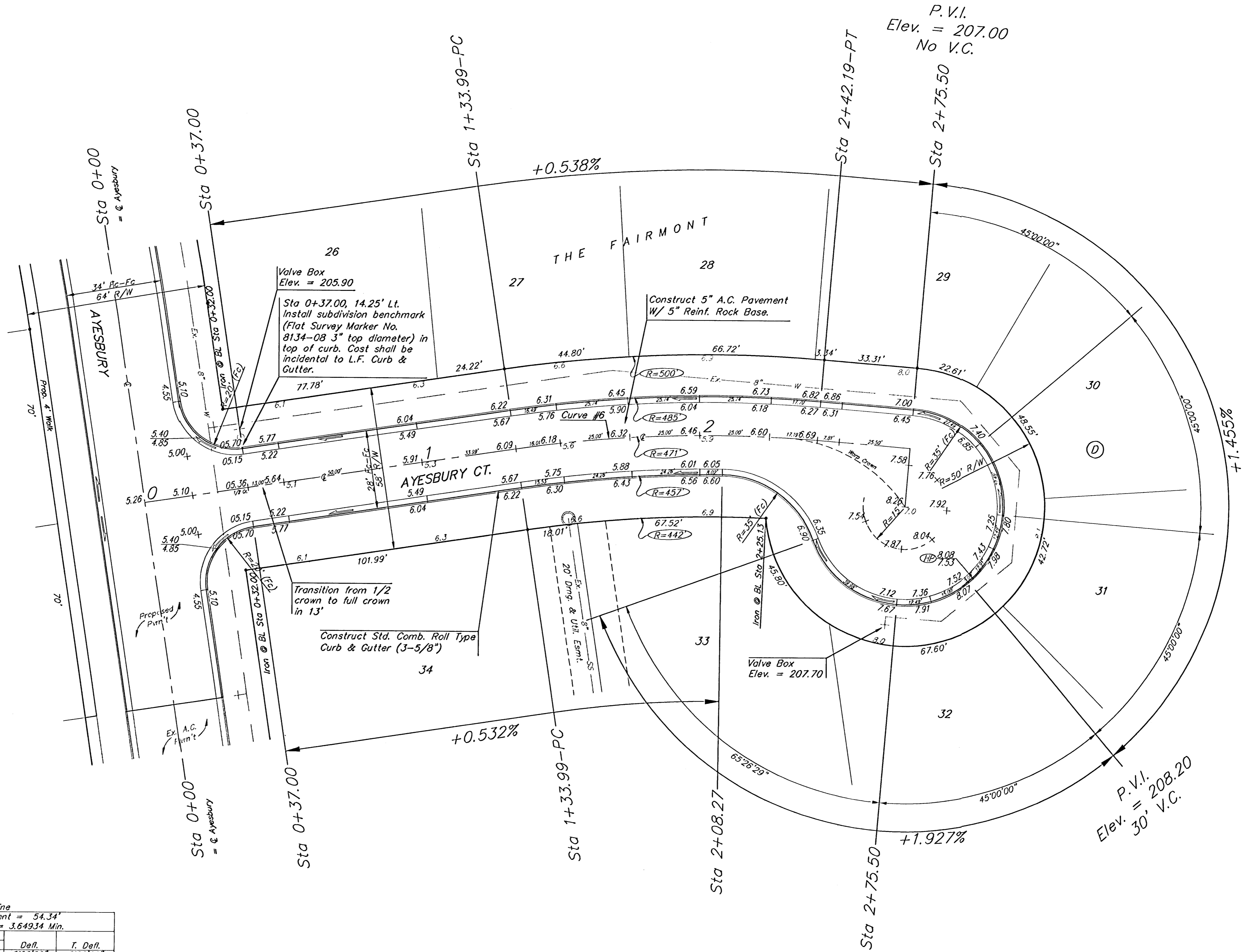

Curve #6  
Curve Data Based on Centerline  
Rad. = 471' Delta = 130° 43' Tangent = 54.34'  
Arc = 108.2' L.C. = 107.96' Del/Ft. = 3.64934 Min.

Station	Arc	FACE CHORD LENGTHS		Defl.	T. Defl.
		8' Lt.	8' Rt.		
1+33.99	-	-	-	0°00'00"	0°00'00"
1+50.00	16.01'	16.76'	15.26'	0°58'25"	0°58'25"
1+75.00	25.00'	26.16'	23.83'	1°31'14"	2°29'39"
2+00.00	25.00'	26.16'	23.83'	1°31'14"	4°00'53"
2+08.27	8.27'	8.66'	7.88'	0°30'11"	4°31'04"
2+25.00	16.73'	17.51'	15.95'	1°01'03"	5°32'07"
2+42.19	17.19'	17.99'	16.39'	1°02'44"	6°34'51"

NOTE: ROLL TYPE CURB & GUTTER TO BE CONSTRUCTED ON THE PAVEMENT SHOWN ON THIS SHEET. TOP OF CURB ELEVATIONS ARE GIVEN FOR FULL HEIGHT CURB.

**THE FAIRMONT - PHASE 2**  
**AYESBURY CT.**  
STA 0+00 TO STA 2+75.50

**BAUGHMAN COMPANY P.A.**  
ENGINEERING, SURVEYING, & PLANNING  
316-262-7271 • 315 ELLIS • WICHITA, KANSAS 67211

PROJECT NUMBER  
**472-83484**

DESIGN NBW | DRAW TMS | APPROVED [Signature] | DATE 7/23/03 | SCALE Noted

SHEET  
OF  
**13**  
OF  
**39**