

REBAR SCHEDULE

Bar	Shape	No.	Length	Weight
a1	[]	1	15'7"	10.41
a2	[]	1	13'10"	9.24
a3	[]	1	13'5"	8.96
a4	[]	1	13'0"	8.68
a5	[]	1	12'6"	8.35
a6	[]	1	12'1"	8.07
a7	[]	1	11'8"	7.79
a8	[]	1	11'3"	7.52
a9	[]	1	10'9"	7.18
a10	[]	1	10'5"	6.96
a11	[]	1	10'0"	6.68
b1	[]	2	10'2"	13.58
b2	[]	2	7'3"	9.69
b3	[]	2	10'8"	14.25
c	[]	7	12'0"	56.11
d1	[]	4	1'3"	3.34
d2	[]	4	9"	2.00
e	[]	3	5'10"	11.69
f	[]	4	3'0"	30.06
g	[]	2	8'0"	10.69
h	[]	6	2'6"	6.68
Total Rebar			247.93 Lbs.	
Concrete			10.12 C.Y.	

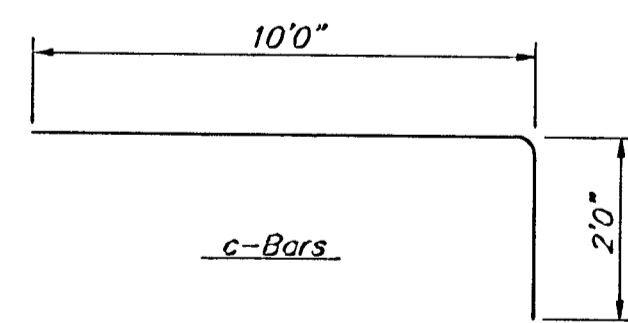

A Deduction in Concrete Quantities Has Been Made for Pipe Openings Through the Headwall
 * Field Bend or Cut Reinforcing as Required for Clearance.
 All Concrete Reinforcement to be #4 Rebar
 All Rebar to Have Min. of 1 1/2" Conc. Cover

HEADWALL FOR 42" RCP

HEADWALL DETAIL

BAUGHMAN COMPANY P.A.
 ENGINEERING, SURVEYING, & PLANNING
 316-262-7271 • 315 ELLIS • WICHITA, KANSAS 67211

PROJECT NUMBER

DESIGN: BLP/DMV DRAWN: JAK APPROVED: DATE: 7/23/03 SCALE: NONE

SHEET 27 OF 39