

BENCHMARKS:
 BM #1: RAILROAD SPIKE IN WEST FACE OF SAWED OFF POST, 25.6' W. & 1.0' S. OF NORTHWEST CORNER OF LOT 16, BLOCK A. P.V.I. Elev. = 1333.85 32' V.C.
 BM #2: TOP OF FENCE POST WITHOUT TOP CAP, 0.6' W. & 0.7' N. OF POINT OF CURVATURE IN NORTH LINE OF LOT 9, BLOCK A. ELEV. = 1337.55 NAVD88

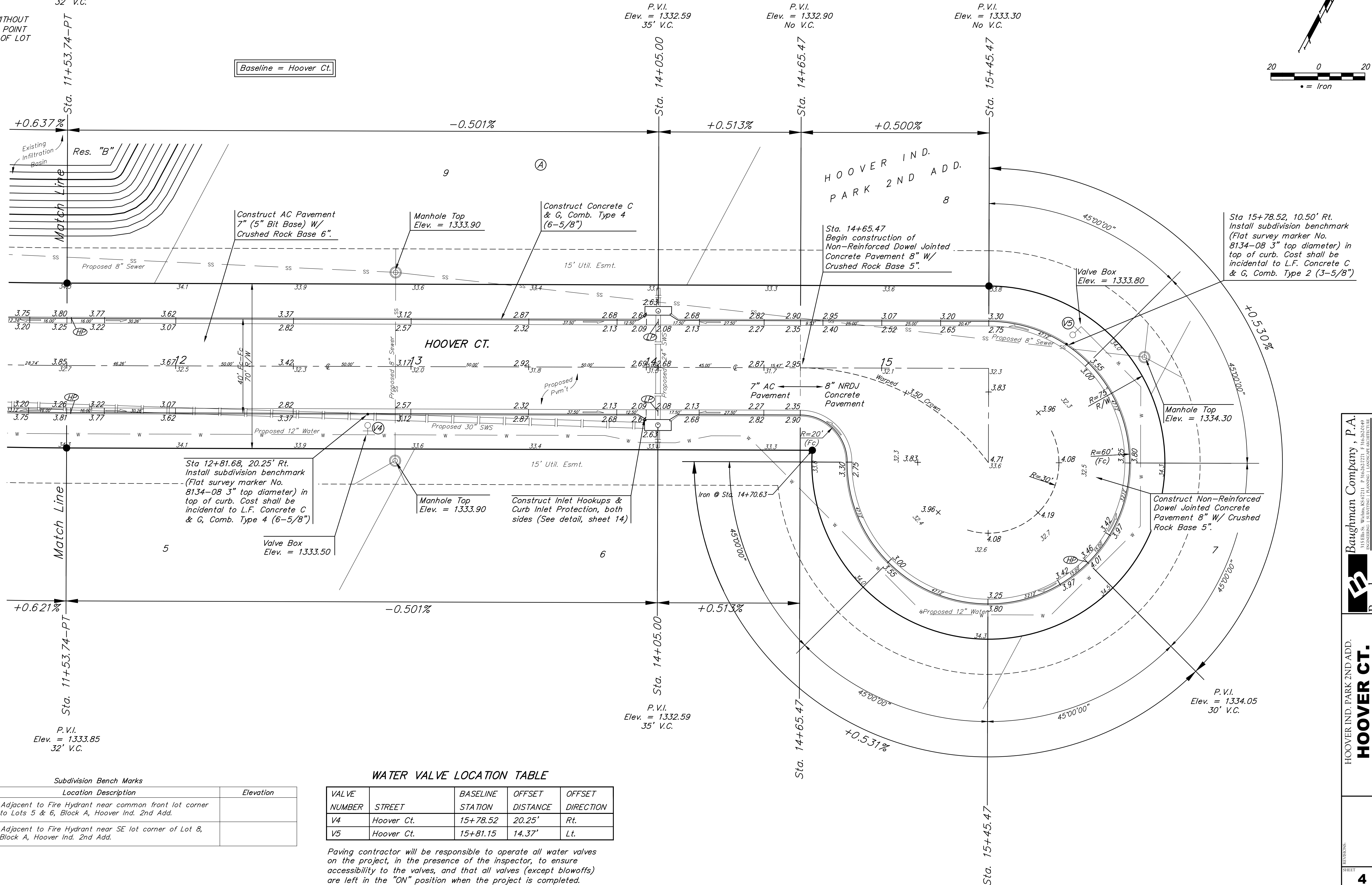
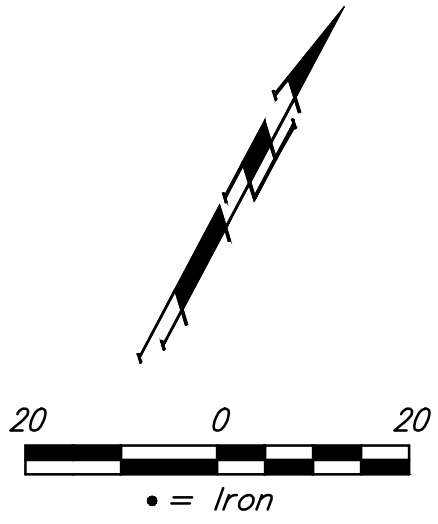

Subdivision Bench Marks

Street & Station	Location Description	Elevation
Hoover Ct. 12+81.68, 20.25' Rt.	Adjacent to Fire Hydrant near common front lot corner to Lots 5 & 6, Block A, Hoover Ind. 2nd Add.	
Hoover Ct. 15+78.52, 10.50' Rt.	Adjacent to Fire Hydrant near SE lot corner of Lot 8, Block A, Hoover Ind. 2nd Add.	

WATER VALVE LOCATION TABLE

VALVE NUMBER	STREET	BASELINE STATION	OFFSET DISTANCE	OFFSET DIRECTION
V4	Hoover Ct.	15+78.52	20.25'	Rt.
V5	Hoover Ct.	15+81.15	14.37'	Lt.

Paving contractor will be responsible to operate all water valves on the project, in the presence of the inspector, to ensure accessibility to the valves, and that all valves (except blowoffs) are left in the "ON" position when the project is completed.

Baughman Company, P.A.
 ENGINEERING, ARCHITECTURE, PLANNING, LANDSCAPE ARCHITECTURE
 Baughman

HOOPER IND. PARK 2ND ADD.
HOOPER CT.
 STREET IMPROVEMENTS

SHEET
4
 OF
24