

BENCHMARK:
City of Wichita benchmark at
the SE corner of intersection
of 135th Street West and 13th
Street North.
Elev. = 167.83 (City Datum)

Scale: 1" = 20'
• = Iron

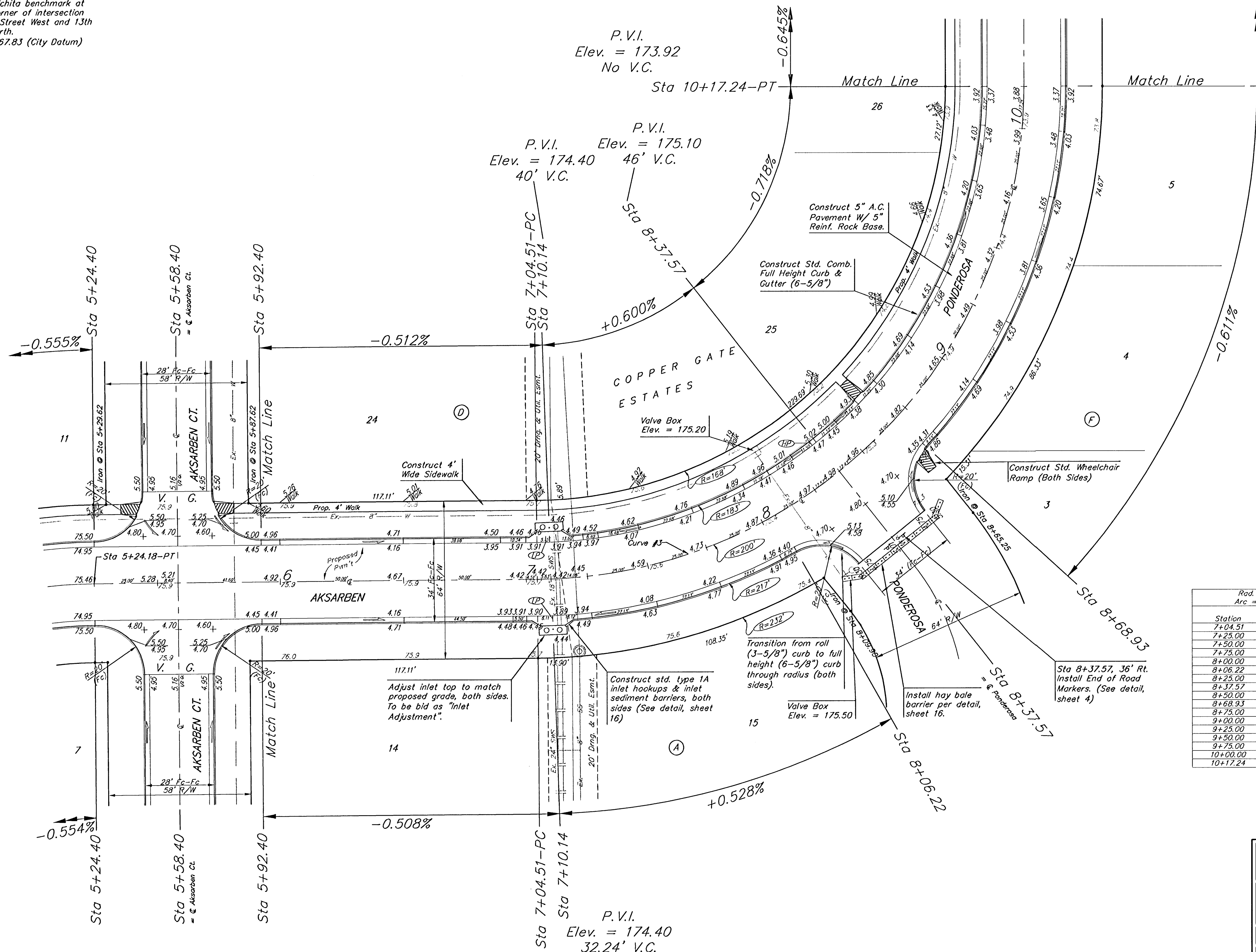

Curve #3
Curve Data Based on Centerline
Rad. = 200' Delta = 89° 35' 25" Tangent = 198.57'
Arc = 312.73' L.C. = 281.83' Del/Ft. = 8.59434 Min.

Station	FACE CHORD LENGTHS		Defl.	T. Defl.
	8' Lt.	8' Rt.		
7+04.51	-	-	0°00'00"	0°00'00"
7+25.00	20.49'	17.92'	23.04'	2°56'08"
7+50.00	25.00'	21.86'	28.11'	3°34'51"
7+75.00	25.00'	21.86'	28.11'	3°34'52"
8+00.00	25.00'	21.86'	28.11'	3°34'51"
8+06.22	6.22'	5.44'	7.00'	0°53'28"
8+25.00	18.78'	16.43'	21.12'	2°41'24"
8+37.57	12.57'	11.00'	14.14'	1°48'02"
8+50.00	12.43'	10.87'	13.98'	1°46'49"
8+68.93	18.93'	16.56'	21.29'	2°42'42"
8+75.00	6.07'	5.31'	6.83'	0°52'10"
9+00.00	25.00'	21.86'	28.11'	3°34'51"
9+25.00	25.00'	21.86'	28.11'	3°34'52"
9+50.00	25.00'	21.86'	28.11'	3°34'51"
9+75.00	25.00'	21.86'	28.11'	3°34'52"
10+00.00	25.00'	21.86'	28.11'	3°34'52"
10+17.24	17.24'	15.08'	19.39'	2°28'10"

COPPER GATE ESTATES - PHASE I
AKSARBEN/PONDEROSA
STA 5+92.40 TO STA 10+17.24

BAUGHMAN COMPANY P.A.
ENGINEERING, SURVEYING, & PLANNING
315-282-7271 • 315 ELLIS • WICHITA, KANSAS 67211

PROJECT NUMBER 472-83669	SHEET 8
DESIGN BLP	DRAWN TMS
APPROVED	DATE 4/30/03
SCALE Noted	OF 32

CopperGate/Str3 02-10-E432