

BENCHMARK:
City of Wichita benchmark at
the SE corner of intersection
of 135th Street West and 13th
Street North.
Elev. = 167.83 (City Datum)

P.V.I.
Elev. = 173.92
No V.C.

P.V.I.
Elev. = 172.40
50.64' V.C.

P.V.I.
Elev. = 172.95
43.56' V.C.

Scale: 1" = 20'
• = Iron

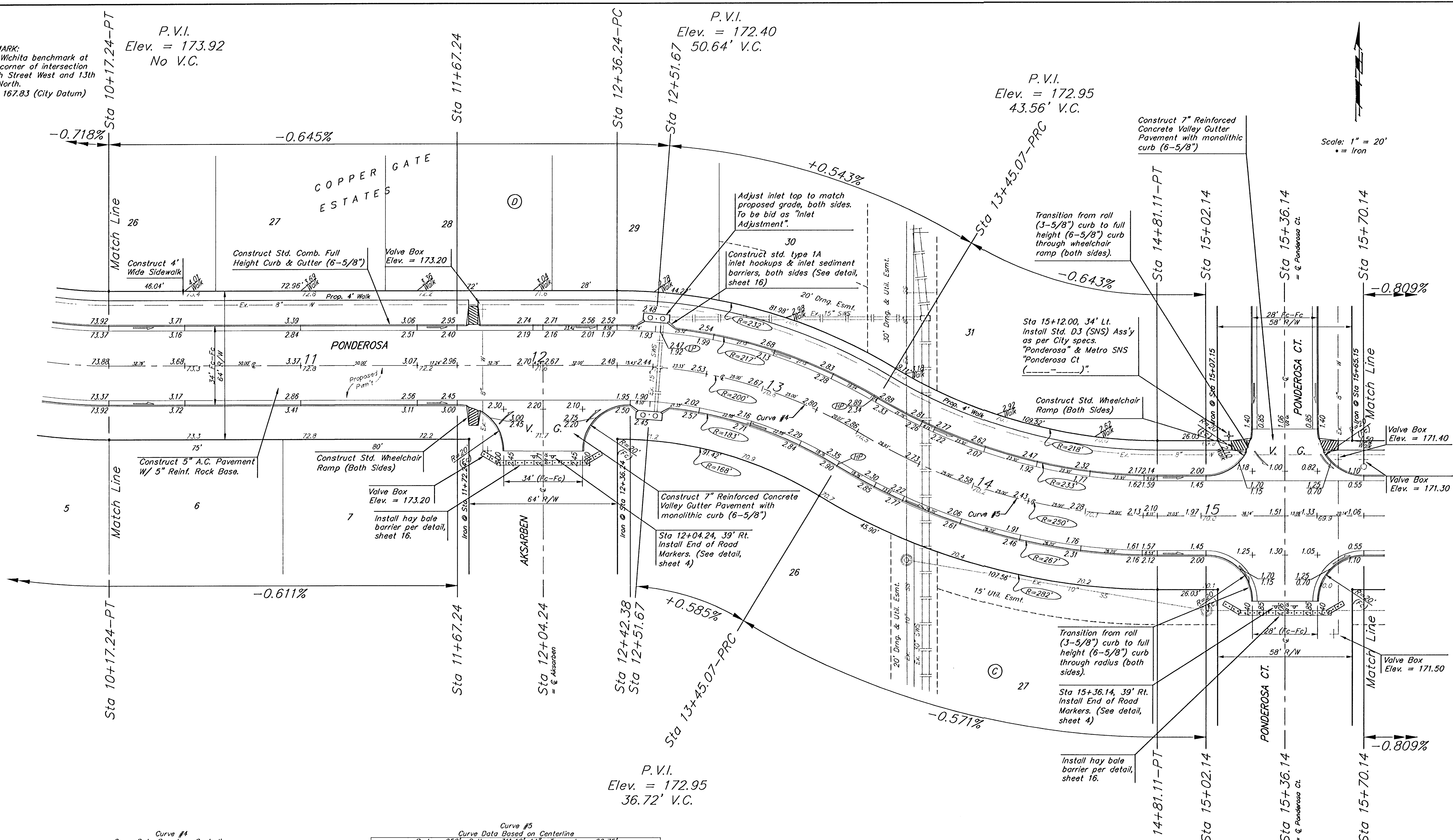

Curve #4
Curve Data Based on Centerline
Rad. = 200' Delta = 31° 10' 44" Tangent = 55.80'
Arc = 108.83' L.C. = 107.50' Def/Pl. = 8.59475 Min.

Station	Arc	FACE CHORD LENGTHS		Defl.	T. Defl.
		8' Lt.	8' Rt.		
12+36.24	-	-	-	0°00'00"	0°00'00"
12+42.38	6.14'	6.91'	5.37'	0°52'46"	0°52'46"
12+50.00	7.62'	8.57'	6.67'	1°05'30"	1°58'16"
12+55.00	10.00'	11.33'	8.94'	1°30'00"	2°30'00"
12+60.00	12.50'	14.14'	11.75'	2°00'00"	3°30'00"
12+65.00	15.00'	17.00'	14.61'	2°30'00"	4°30'00"
12+70.00	17.50'	19.92'	17.50'	3°00'00"	5°30'00"
12+75.00	20.00'	22.89'	20.41'	3°30'00"	6°30'00"
12+80.00	22.50'	25.92'	23.38'	4°00'00"	7°30'00"
12+85.00	25.00'	29.00'	26.41'	4°30'00"	8°30'00"
12+90.00	27.50'	32.14'	29.50'	5°00'00"	9°30'00"
12+95.00	30.00'	35.33'	32.65'	5°30'00"	10°30'00"
12+100.00	32.50'	38.57'	35.86'	6°00'00"	11°30'00"
12+105.00	35.00'	41.86'	39.13'	6°30'00"	12°30'00"
12+110.00	37.50'	45.20'	42.46'	7°00'00"	13°30'00"
12+115.00	40.00'	48.59'	45.85'	7°30'00"	14°30'00"
12+120.00	42.50'	52.03'	49.30'	8°00'00"	15°30'00"
12+125.00	45.00'	55.52'	52.81'	8°30'00"	16°30'00"
12+130.00	47.50'	59.06'	56.38'	9°00'00"	17°30'00"
12+135.00	50.00'	62.65'	59.99'	9°30'00"	18°30'00"
12+140.00	52.50'	66.29'	63.65'	10°00'00"	19°30'00"
12+145.00	55.00'	70.00'	67.35'	10°30'00"	20°30'00"
12+150.00	57.50'	73.76'	71.10'	11°00'00"	21°30'00"
12+155.00	60.00'	77.58'	74.90'	11°30'00"	22°30'00"
12+160.00	62.50'	81.45'	78.75'	12°00'00"	23°30'00"
12+165.00	65.00'	85.38'	82.65'	12°30'00"	24°30'00"
12+170.00	67.50'	89.36'	86.60'	13°00'00"	25°30'00"
12+175.00	70.00'	93.40'	90.60'	13°30'00"	26°30'00"
12+180.00	72.50'	97.50'	94.65'	14°00'00"	27°30'00"
12+185.00	75.00'	101.66'	98.75'	14°30'00"	28°30'00"
12+190.00	77.50'	105.88'	102.90'	15°00'00"	29°30'00"
12+195.00	80.00'	110.16'	107.10'	15°30'00"	30°30'00"
12+200.00	82.50'	114.50'	111.35'	16°00'00"	31°30'00"
12+205.00	85.00'	118.90'	115.65'	16°30'00"	32°30'00"
12+210.00	87.50'	123.36'	120.00'	17°00'00"	33°30'00"
12+215.00	90.00'	127.88'	124.40'	17°30'00"	34°30'00"
12+220.00	92.50'	132.46'	128.85'	18°00'00"	35°30'00"
12+225.00	95.00'	137.10'	133.35'	18°30'00"	36°30'00"
12+230.00	97.50'	141.80'	137.90'	19°00'00"	37°30'00"
12+235.00	100.00'	146.56'	142.50'	19°30'00"	38°30'00"
12+240.00	102.50'	151.38'	147.15'	20°00'00"	39°30'00"
12+245.00	105.00'	156.26'	151.85'	20°30'00"	40°30'00"
12+250.00	107.50'	161.20'	156.60'	21°00'00"	41°30'00"
12+255.00	110.00'	166.20'	161.40'	21°30'00"	42°30'00"
12+260.00	112.50'	171.26'	166.25'	22°00'00"	43°30'00"
12+265.00	115.00'	176.38'	171.15'	22°30'00"	44°30'00"
12+270.00	117.50'	181.56'	176.10'	23°00'00"	45°30'00"
12+275.00	120.00'	186.80'	181.10'	23°30'00"	46°30'00"
12+280.00	122.50'	192.10'	186.15'	24°00'00"	47°30'00"
12+285.00	125.00'	197.46'	191.25'	24°30'00"	48°30'00"
12+290.00	127.50'	202.88'	196.40'	25°00'00"	49°30'00"
12+295.00	130.00'	208.36'	201.60'	25°30'00"	50°30'00"
12+300.00	132.50'	213.90'	206.85'	26°00'00"	51°30'00"
12+305.00	135.00'	219.50'	212.15'	26°30'00"	52°30'00"
12+310.00	137.50'	225.16'	217.50'	27°00'00"	53°30'00"
12+315.00	140.00'	230.88'	222.90'	27°30'00"	54°30'00"
12+320.00	142.50'	236.66'	228.35'	28°00'00"	55°30'00"
12+325.00	145.00'	242.50'	233.85'	28°30'00"	56°30'00"
12+330.00	147.50'	248.40'	239.40'	29°00'00"	57°30'00"
12+335.00	150.00'	254.36'	245.00'	29°30'00"	58°30'00"
12+340.00	152.50'	260.38'	250.65'	30°00'00"	59°30'00"
12+345.00	155.00'	266.46'	256.35'	30°30'00"	60°30'00"
12+350.00	157.50'	272.60'	262.10'	31°00'00"	61°30'00"
12+355.00	160.00'	278.80'	267.90'	31°30'00"	62°30'00"
12+360.00	162.50'	285.06'	273.75'	32°00'00"	63°30'00"
12+365.00	165.00'	291.38'	279.65'	32°30'00"	64°30'00"
12+370.00	167.50'	297.76'	285.60'	33°00'00"	65°30'00"
12+375.00	170.00'	304.20'	291.60'	33°30'00"	66°30'00"
12+380.00	172.50'	310.70'	297.65'	34°00'00"	67°30'00"
12+385.00	175.00'	317.26'	303.75'	34°30'00"	68°30'00"
12+390.00	177.50'	323.88'	309.90'	35°00'00"	69°30'00"
12+395.00	180.00'	330.56'	316.10'	35°30'00"	70°30'00"
12+400.00	182.50'	337.30'	322.35'	36°00'00"	71°30'00"
12+405.00	185.00'	344.10'	328.65'	36°30'00"	72°30'00"
12+410.00	187.50'	350.96'	335.00'	37°00'00"	73°30'00"
12+415.00	190.00'	357.88'	341.40'	37°30'00"	74°30'00"
12+420.00	192.50'	364.86'	347.85'	38°00'00"	75°30'00"
12+425.00	195.00'	371.90'	354.35'	38°30'00"	76°30'00"
12+430.00	197.50'	379.00'	360.90'	39°00'00"	77°30'00"
12+435.00	200.00'	386.16'	367.50'	39°30'00"	78°30'00"
12+440.00	202.50'	393.38'	374.15'	40°00'00"	79°30'00"
12+445.00	205.00'	400.66'	380.85'	40°30'00"	80°30'00"
12+450.00	207.50'	408.00'	387.60'	41°00'00"	81°30'00"

Curve #5
Curve Data Based on Centerline
Rad. = 250' Delta = 31° 10' 44" Tangent = 69.75'
Arc = 136.04' L.C. = 134.33' Def/Pl. = 8.87567 Min.

Station	Arc	FACE CHORD LENGTHS		Defl.	T. Defl.
		8' Lt.	8' Rt.		
13+45.07	-	-	-	0°00'00"	0°00'00"
13+50.00	4.93'	4.44'	5.42'	0°33'54"	0°33'54"
13+55.00	9.86'	8.88'	10.84'	0°67'48"	0°67'48"
13+60.00	14.79'	13.32'	16.26'	1°01'42"	1°01'42"
13+65.00	19.72'	17.76'	21.68'	1°35'36"	1°35'36"
13+70.00	24.65'	22.20'	27.10'	2°09'30"	2°09'30"
13+75.00	29.58'	26.64'	32.52'	2°43'24"	2°43'24"
13+80.00	34.51'	31.08'	37.94'	3°17'18"	3°17'18"
13+85.00	39.44'	35.52'	43.36'	3°51'12"	3°51'12"
13+90.00	44.37'	39.96'	48.78'	4°25'06"	4°25'06"
13+95.00	49.30'	44.40'	54.20'	4°59'00"	4°59'00"
14+00.00	54.23'	48.84'	59.62'	5°32'54"	5°32'54"
14+05.00	59.16'	53.28'	65.04'	6°06'48"	6°06'48"
14+10.00	64.09'	57.72'	70.46'	6°40'42"	6°40'42"
14+15.00	69.02'	62.16'	75.88'	7°14'36"	7°14'36"
14+20.00	73.95'	66.60'	81.30'	7°48'30"	7°48'30"
14+25.00	78.88'	71.04'	86.72'	8°22'24"	8°22'24"
14+30.00	83.81'	75.48'	92.14'	8°56'18"	8°56'18"
14+35.00	88.74'	79.92'	97.56'	9°30'12"	9°30'12"
14+40.00	93.67'	84.36'	102.98'	10°04'06"	10°04'06"
14+45.00	98.60'	88.80'	108.40'	10°38'00"	10°38'00"
14+50.00	103.53'	93.24'	113.82'	11°11'54"	11°11'54"
14+55.00	108.46'	97.68'	119.24'	11°45'48"	11°45'48"
14+60.00	113.39'	102.12'	124.66'	12°19'42"	12°19'42"
14+65.00	118.32'	106.56'	130.08'	12°53'36"	12°53'36"
14+70.00	123.25'	111.00'	135.50'	13°27'30"	13°27'30"
14+75.00	128.18'	115.44'	140.92'	14°01'24"	14°01'24"
14+80.00	133.11'	119.88'	146.34'	14°35'18"	14°35'18"
14+85.00	138.04'	124.32'	151.76'	15°09'12"	15°09'12"
14+90.00	142.97'	128.76'	157.18'	15°43'06"	15°43'06"
14+95.00	147.90'	133.20'	162.60'	16°17'00"	16°17'00"
15+00.00	152.83'	137.64'	168.02'	16°50'54"	16°50'54"
15+05.00	157.76'	142.08'	173.44'	17°24'48"	17°24'48"
15+10.00	162.69'	146.52'	178.86'	17°58'42"	17°58'42"
15+15.00	167.62'	150.96'	184.28'	18°32'36"	18°32'36"
15+20.00	172.55'	155.40'	189.70'	19°06'30"	19°06'30"
15+25.00	177.48'	159.84'	195.12'	19°40'24"	19°40'24"
15+30.00	182.41'	164.28'	200.54'	20°14'18"	20°14'18"
15+35.00	187.34'	168.72'	205.96'	20°48'12"	20°48'12"
15+40.00	192.27'	173.16'	211.38'	21°22'06"	21°22'06"
15+45.00	197.20'	177.60'	216.80'	21°56'00"	21°56'00"
15+50.00	202.13'	182.04'	222.22'	22°29'54"	22°29'54"
15+55.00	207.06'	186.48'	227.64'	23°03'48"	23°03'48"
15+60.00	211.99'	190.92'	233.06'	23°37'42"	23°37'42"
15+65.00	216.92'	195.36'	238.48'	24°11'36"	24°11'36"
15+70.00	221.85'	199.80'	243.90'	24°45'30"	24°45'30"

COPPER GATE ESTATES - PHASE I
PONDEROSA
STA 10+17.24 TO STA 15+70.14

BAUGHMAN COMPANY P.A.
ENGINEERING, SURVEYING, & PLANNING
316-262-7271 • 313 ELLIS • WICHITA, KANSAS 67211

PROJECT NUMBER
472-63669

DESIGN: BLP DRAWN: TMS APPROVED: DATE: 4/30/03 SCALE: Noted SHEET: **9** OF **32**