

BENCHMARK:  
 City of Wichita benchmark at  
 the SE corner of intersection  
 of 135th Street West and 13th  
 Street North.  
 Elev. = 167.83 (City Datum)

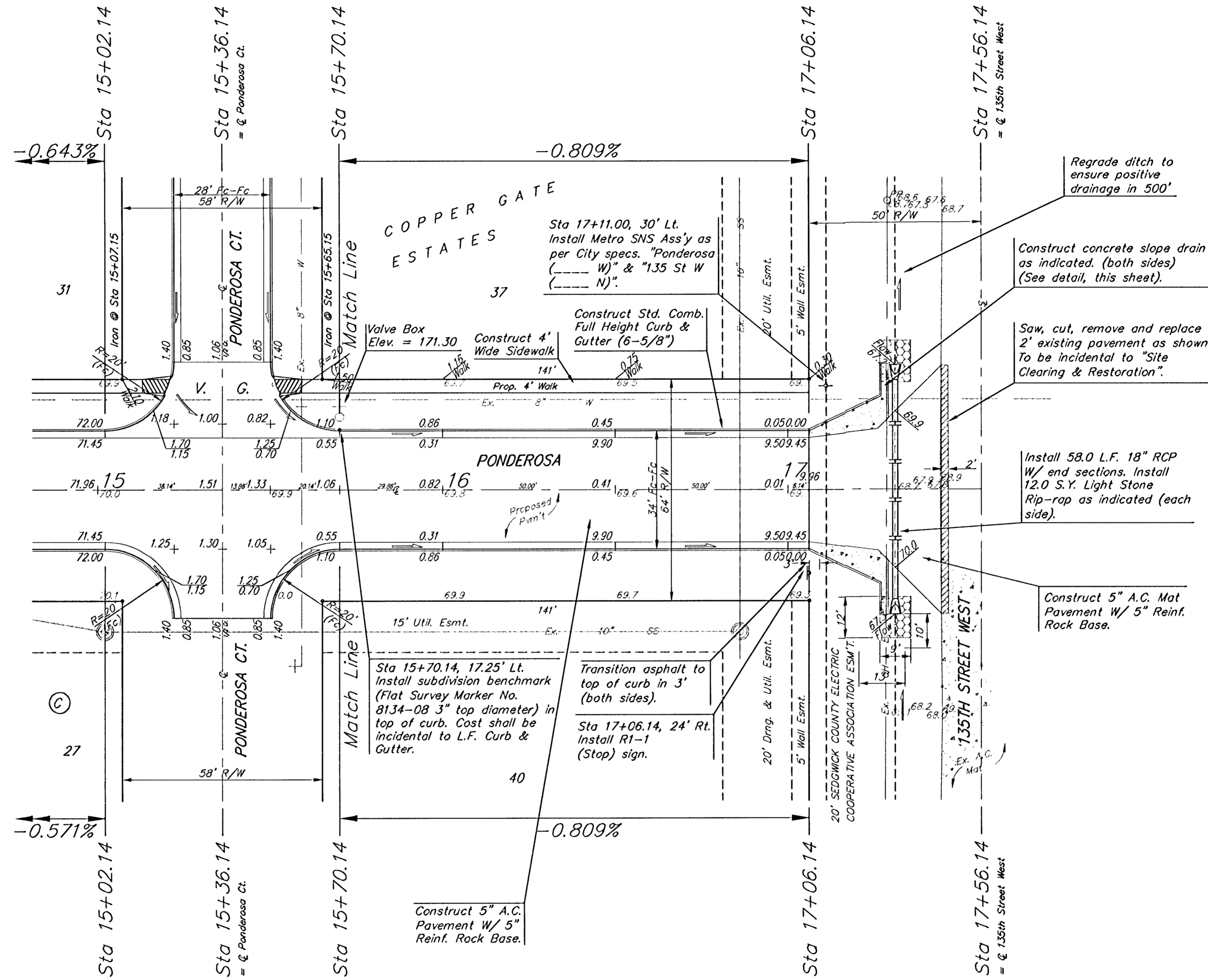

Subdivision Bench Marks		
Street & Station	Location Description	Elevation
Ponderosa 15+70.14, 17.25' Lt.	Adjacent to Fire Hydrant at E. End of E. Curb Return of Ponderosa & Ponderosa Ct.	
Aksarben Ct. Lots 1-10, Block D 0+37.03, 14.25' Lt.	Adjacent to Fire Hydrant at E. End of N. Curb Return of Ponderosa & Ponderosa Ct. (Lots 1-10, Block D)	
Aksarben Ct. Lots 7-14, Block A 1+12.56, 14.25' Rt.	Adjacent to Fire Hydrant between Lots 13&14, Block A.	
Aksarben Ct. Lots 11-24, Block D 1+81.00, 14.25' Rt.	Adjacent to Fire Hydrant between Lots 22&23, Block D.	

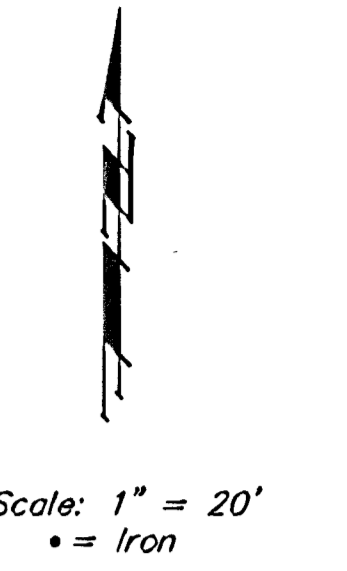
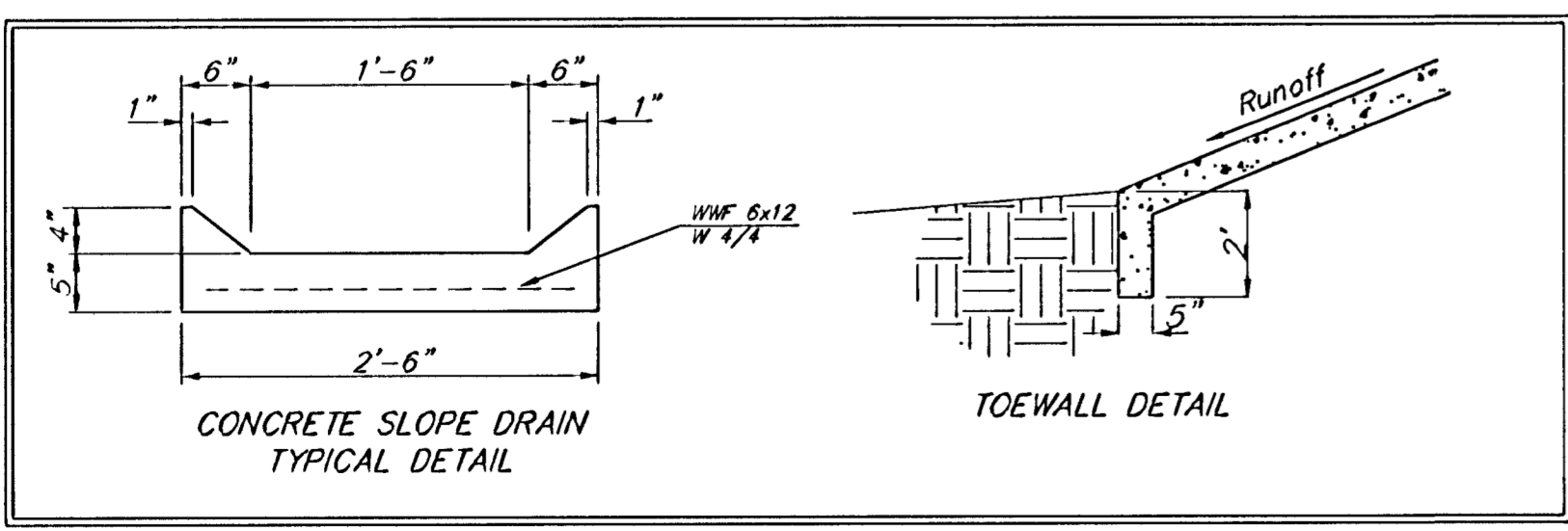

COPPER GATE ESTATES - PHASE I  
**PONDEROSA**  
 STA 15+70.14 TO STA 17+58.14

**BAUGHMAN COMPANY P.A.**  
 ENGINEERING, SURVEYING, & PLANNING  
 316-262-7271 • 315 ELLIS • WICHITA, KANSAS 67211

PROJECT NUMBER  
**472-83889**

DESIGN: BLP    DRAWN: TMS    APPROVED:    DATE: 4/30/03    SCALE: Noted

SHEET  
**10**  
 OF  
**32**

CopperGate/Str3 02-10-E432