

Install hay bale barrier per detail, sheet 18.

Install hay bale barriers per detail, sheet 18.

Install hay bale barriers per detail, sheet 18.

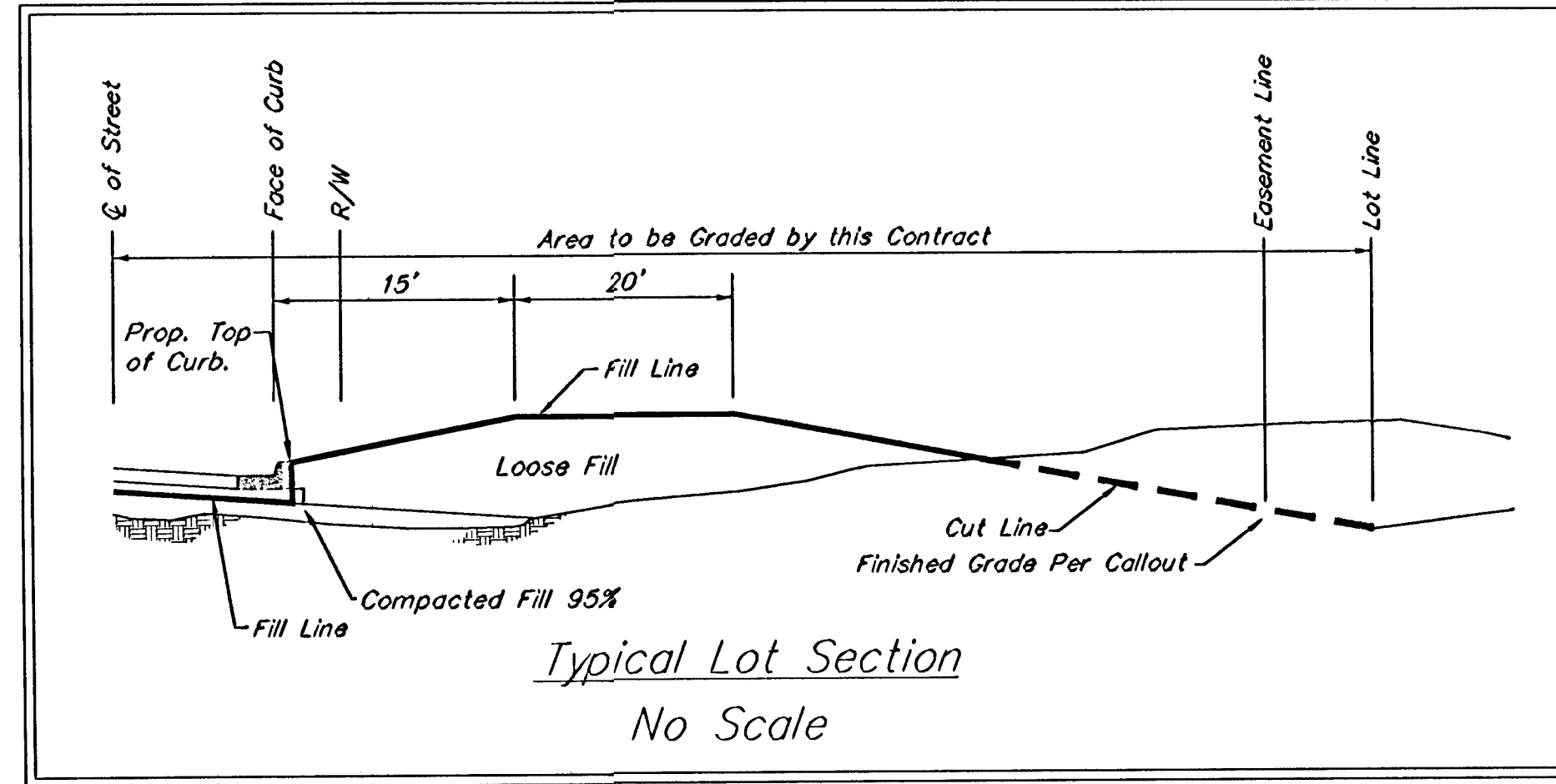

Scale: 1"=50'

All areas disturbed during construction not under proposed pavement are to be seeded, mulched and fertilized as follows:
Seed: - Rye Grass (PLS) - 3#/1000 Sq. Ft. and Kansas Premium Fescue Blend - 3#/1000 Sq. Ft.
Mulch: - 2 tons prairie hay/acre.
Fertilizer: - 12-24-12 ratio - 350 lbs./acre
 Cost of seeding, fertilizing, and mulching shall be incidental to "Project Seeding".

EARTH WORK TOTALS		
	C.Y. Excavation	C.Y. Fill
Mass Grading	2,356	12,540
Pond Construction	10,091	0
Total	12,447	12,540

Stockpile excess material as indicated by Engineer, out of easements and right-of-way. Earthwork quantities are for reference only. All cost associated with mass grading shall be incidental to lump sum bid item "Mass Grading".

- Contractor to strip top 3" of soil before mass grading and stockpile. Top soil stockpile to be redistributed over entire disturbed area excluding street right-of-way and ponds to achieve planned grade.
- Compaction of 90% shall be obtained in all fill areas.
- It shall be the Contractor's responsibility to protect the sanitary sewer and water distribution system during mass grading. Any damage done to these systems by Contractor or subcontractor shall be repaired at no additional cost to the project.

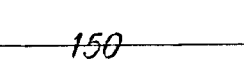
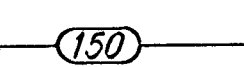
-  Area to be graded
-  Existing Grade
-  Proposed Grade

Remove trees only as necessary for mass grading. Cost of removal to be incidental to lump sum bid item "Site Clearing & Restoration".

GRACE PARK ADDITION
MASS GRADING PLAN
 WICHITA, KANSAS

BAUGHMAN COMPANY P.A.
 ENGINEERING, SURVEYING, & PLANNING
 315-262-7271 • 315 ELLIS • WICHITA, KANSAS 67211

PROJECT NUMBER
472-63788

DESIGN	DRAWN TMS	APPROVED	DATE 06/03	SCALE Noted
--------	--------------	----------	---------------	----------------

SHEET
20
 OF
29

GracePark/MASS 03-05-0379