

GENERAL NOTES:

- The Contractor shall comply with all applicable safety regulations. All construction shall be completed following current City Standard Specifications and Special Provisions.
- Contractor will be required to provide notice to utility companies a minimum of seventy-two (72) hours prior to any excavation, as follows:
Kansas One-Call 687-2470
The Contractor must notify the following in case of an emergency:
AT&T 1-800-246-8464
Black Hills Energy 1-800-694-8989
City of Wichita Water & Sewer 1-316-219-8921
City of Wichita Stormwater 1-316-268-4090
City of Wichita Traffic 1-316-268-4034
Cox Communications 1-888-249-3530
Kansas Gas Service 1-888-482-4950
Westar Energy 1-800-544-4857
- Utility service lines, poles, etc. are to be adjusted as necessary by others prior to construction unless the plans specifically call for their adjustment by the Contractor or unless the plans specifically identify a utility to be adjusted by its owner during construction. Existing utilities and their location, as shown on the plans, represent the best information obtainable for design. The Contractor will be required to work around existing utilities within the right-of-way which do not conflict with proposed construction.
- Rubble from the removal of miscellaneous structures and excess excavation which is to be wasted shall be disposed of on sites to be provided by the Contractor. These sites shall be approved by the Engineer as to suitability, appearance and site location. Locations, in the opinion of the Engineer, that will leave an unsightly appearance will not be approved. All disposal sites must be approved by the Kansas Department of Health and Environment. Material either stockpiled or disposed of in a flood plain will require a Kansas State Board of Agriculture permit. Any material dumped in waters of the United States or wetlands is subject to U.S. Corps of Engineers permitting regulations. Any material buried or stockpiled beyond approved construction limits will require additional archaeological investigations unless buried in a previously approved borrow location.
- Trees and shrubs in public right-of-way which are in direct conflict with proposed new construction shall be removed by the Contractor with the City Engineer's approval. Trees and shrubs which are not in direct conflict with proposed new construction shall be saved and protected from damage.
- The Contractor shall give all property owners and/or tenants of developed property abutting the construction of this project a minimum of ten (10) days notice prior to start of construction.
- The Contractor shall be responsible for preserving property irons. The Contractor will be required to re-establish any property irons which are damaged or destroyed by his construction operations. Such irons shall be re-established by a licensed land surveyor in accordance with state laws.
- If traffic will be impacted by construction, a traffic control plan must be submitted and approved by the City Traffic Engineer, Brian Coon at traffic@wichita.gov before construction can begin. The Contractor shall be responsible for all traffic control measures to facilitate construction. All construction zone markings and signage shall conform to the latest version of Manual on Uniform Traffic Control Devices (MUTCD) as published by the US Dept. of Transportation, Federal Highway Administration. All costs associated with construction markings and signage shall be the Contractors responsibility.
- All elevations shown are NGVD29.
- Contractor shall limit the extent of trench openings overnight and weekends to less than 50 feet.
- The Contractor shall protect from damage and support existing utilities through construction as approved by the utility owner and the Engineer at the contractor's expense.
- All existing and proposed erosion control measures including silt fencing, erosion control mat, straw bales, inlet barriers, and const. entrance shall be maintained throughout construction by the contractor and until project is accepted by the City of Wichita. The on-site engineer shall complete weekly reports on the status of erosion control measures. The contractor shall be required to comply with maintenance and/or replacement of erosion control measures as determined by the on-site engineer until project is accepted by City of Wichita. Maintenance and/or replacement of erosion control measures to be paid by L.S. bid item "Maintain Existing BMPs".
- All excess excavation shall remain on-site and shall be stockpiled as indicated on mass grading plan at a location determined by the engineer.
- Reserves "B" & "D", Edgewater 3rd Add. and Res. "H", Edgewater Addition above the static water surface shall be seeded and mulched as follows:
Seed -- Kansas Premium Fescue Blend; 8 lbs. PLS/1000 Sq. Ft.
Annual Rye grass; 3 lbs./1000 Sq. Ft.
Fertilizer -- 12-24-12 Ratio; 45 Lbs./Ac.
Mulch -- 2 Tons Prairie Hay/Ac.
All other disturbed areas within street R/W and lots are to be seeded as follows:
Seed -- Rye grass; 5 lbs./1000 Sq. Ft.
All costs associated with seeding including mobilization, preparation of ground, seeding, fertilizing, mulching, etc. shall be included in the L.S. bid item "Seeding".
An additional bid item for "Seeding, Temporary" has been included and may be used at the discretion of the design engineer. Temporary seed shall be Annual Rye at 5 lbs./1000 Sq. Ft. unless otherwise noted and shall be planted when permanent seed or sod cannot be used due to seasonal limitations. If the "Seeding, Temporary" bid item is not used, 100% of the pay item will be deducted from the contract. All costs associated with temporary seeding including mobilization, preparation of ground, seeding, etc., shall be included in the L.S. bid item "Seeding, Temporary".
- Storm water sewer construction shall be completed in the following order: SWS Line 8, SWS Lines 1&2, remainder of project.
Mass grading construction shall be completed in the area of Lots 1-26, Block A & Lots 1-8, Block B, Edge Water 3rd Addition first, prior to work in remainder of project.
- The developer for this project is Jay W. Russell, P.O. Box 75337, Wichita, KS 67272 (316)722-2417 jwrussell1105@cloud.com

STORM WATER DRAIN #442

to serve

EDGE WATER 3RD ADDITION EDGE WATER ADDITION MANDY KAY COMM. ADDITION

CITY OF WICHITA, KANSAS

Gary Janzen, P.E. City Engineer

Project Number

468-85357

O.C.A. Number

751586

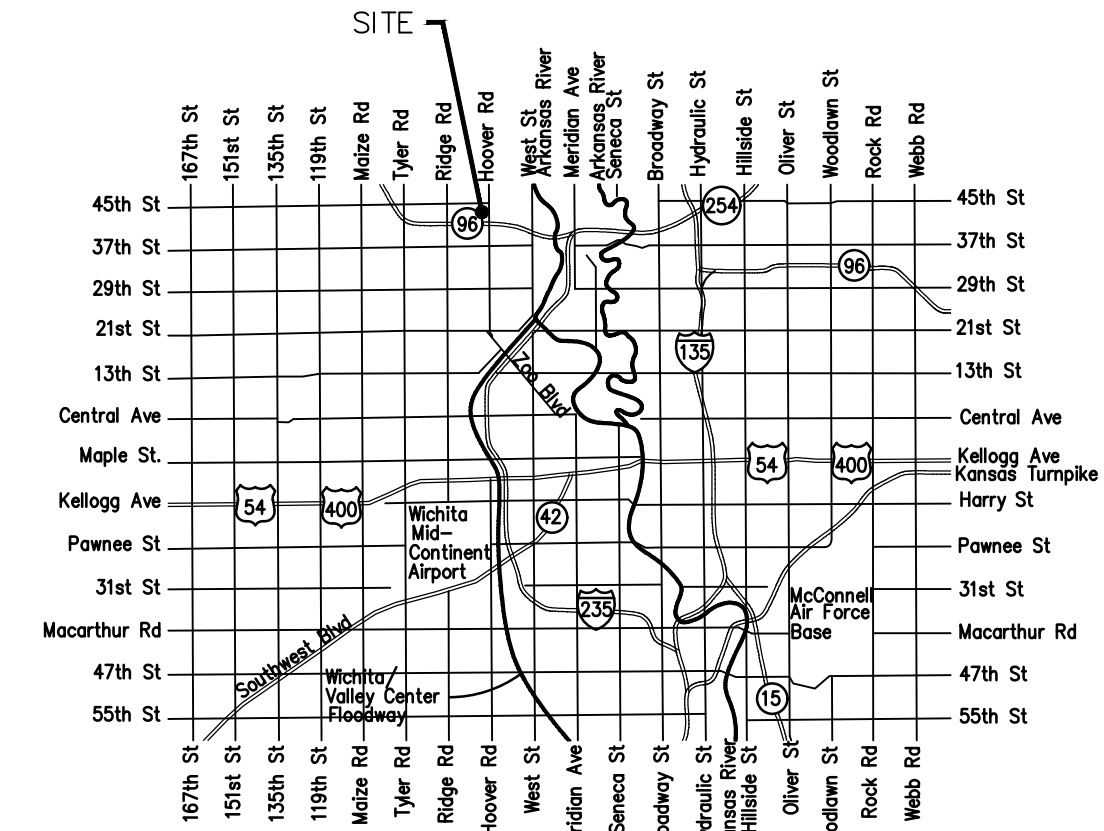

Vicinity Map

Sheet Index

Title Sheet	1
Line 1	2-3
Line 2	4-5
Line 2A	6
Line 3	7-8
Lines 4 & 5	9
Line 6	10
Line 7	11
Line 8	12-13
Mass Grading & Erosion Control Plan	14-15
Pond Plan "A"	16
Dry Detention Plan "B"	17
Dry Detention Plan "C"	18
Type 1A Inlet L=5' and 10' Detail	19
Pavement Underdrain Detail	20
Single-Double Drop Inlet Detail	21
Backyard Inlet Detail	22
Precast Concrete Manhole Detail	23
MH-Inlet Frame & Cover Detail	24
Inlet-Manhole Detail	25
Miscellaneous Detail	26
Headwall 15,18-24 Detail	27
Headwall 30-36 Detail	28
Mass Grading Detail	29
Erosion Control BMP Details	30-34
Coordinate Sheet	35-36
Copy of Plat	37-38

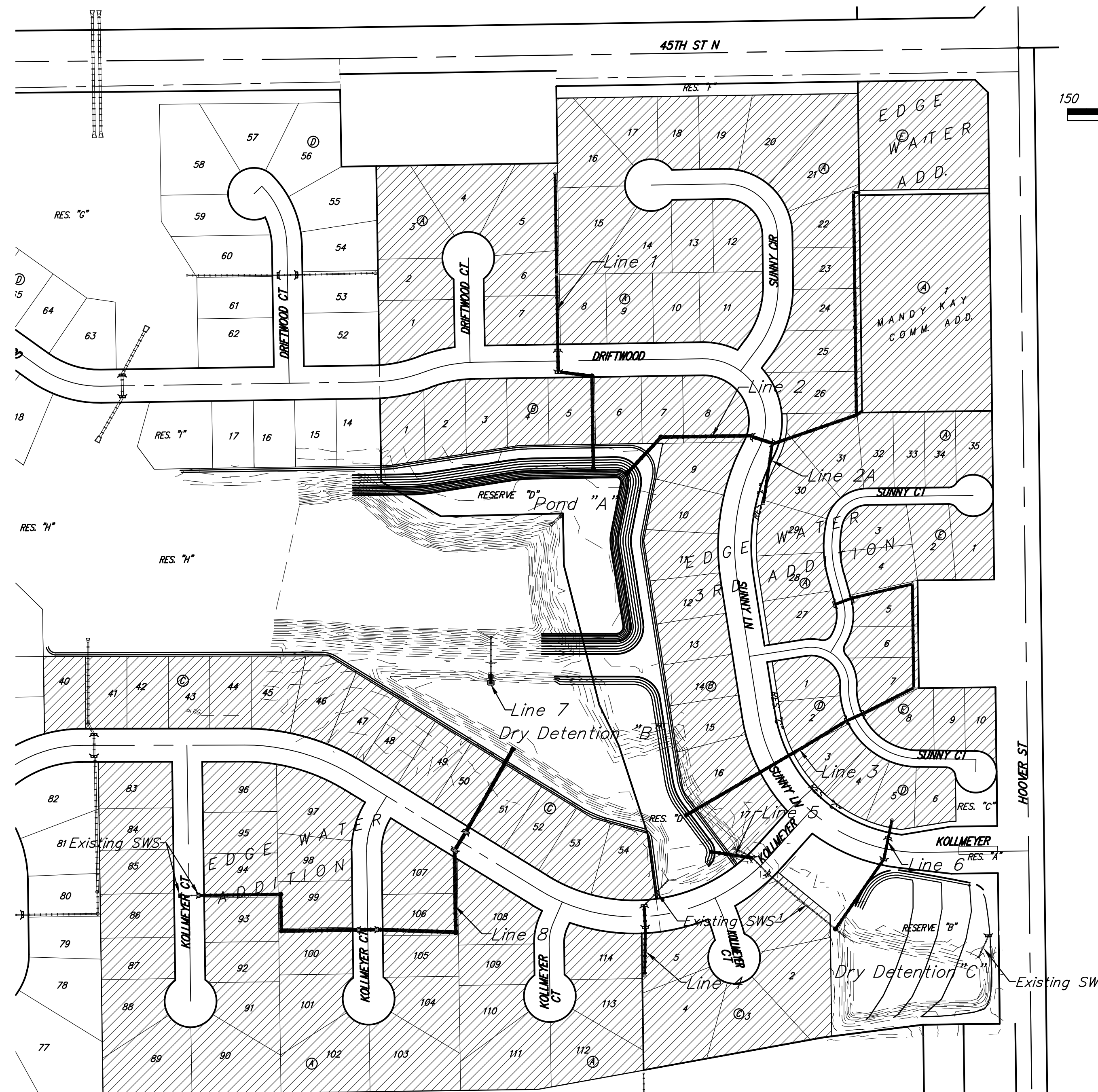
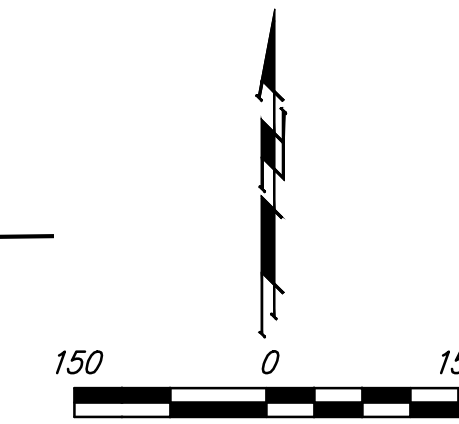

Benchmarks

BM #1: Brass disc at west end of west return at intersection of Driftwood & Driftwood Ct. (Lots 52-62, Block D), Edge Water Addition.
Elev. = 1336.19 NGVD29

BM #2: (Temporary Benchmark) Baughman rebar found at NW corner of Lot 1, Block E, Edge Water Addition.
Elev. = 1334.41 NGVD29

Benefit District

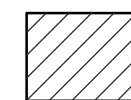

Storm Water Certification:
These construction plans were prepared in accordance with the current Storm Water Management Regulations as set forth in the City of Wichita's Storm Water Management Ordinance 16.32 and the policies/guidelines presented in the Wichita/Sedgwick County Storm Water Manual.

Disturbed Area = 58.5 ac.

Water Quality Treatment: Snouts will be used to treat storm water draining directly to the groundwater pit for the northern part of the permit area. An Infiltration/dry detention basin will be used to treat drainage for southern part of the permit area.

Downstream Channel Protection:
No downstream channel protection has been provided for in these plans. The groundwater pond is non-discharging in the water quality treatment design storms.



December 2018



Baughman Company, P.A. 315 Ellis St. Wichita, KS 67211 P 316-262-7271 F 316-262-0143
ENGINEERING | SURVEYING | PLANNING | LANDSCAPE ARCHITECTURE