

BENCHMARK:
 BM #1: Brass disc at west end of west return at intersection of Driftwood & Driftwood Ct. (Lots 52-62, Block D), Edge Water Addition.
 Elev. = 1336.19 NGVD29

BM #2: (Temporary Benchmark) Baughman rebar found at NW corner of Lot 1, Block E, Edge Water Addition.
 Elev. = 1334.41 NGVD29

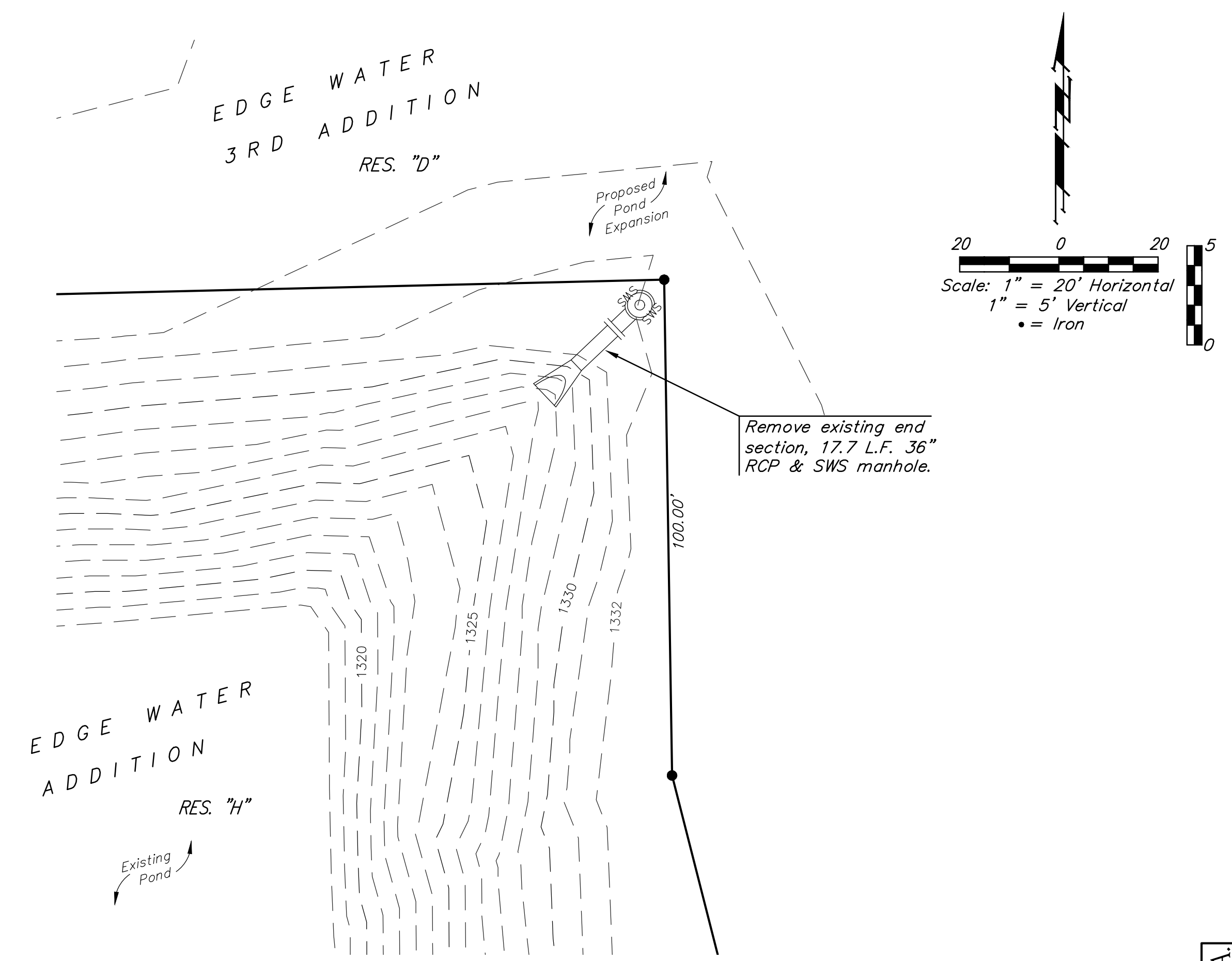
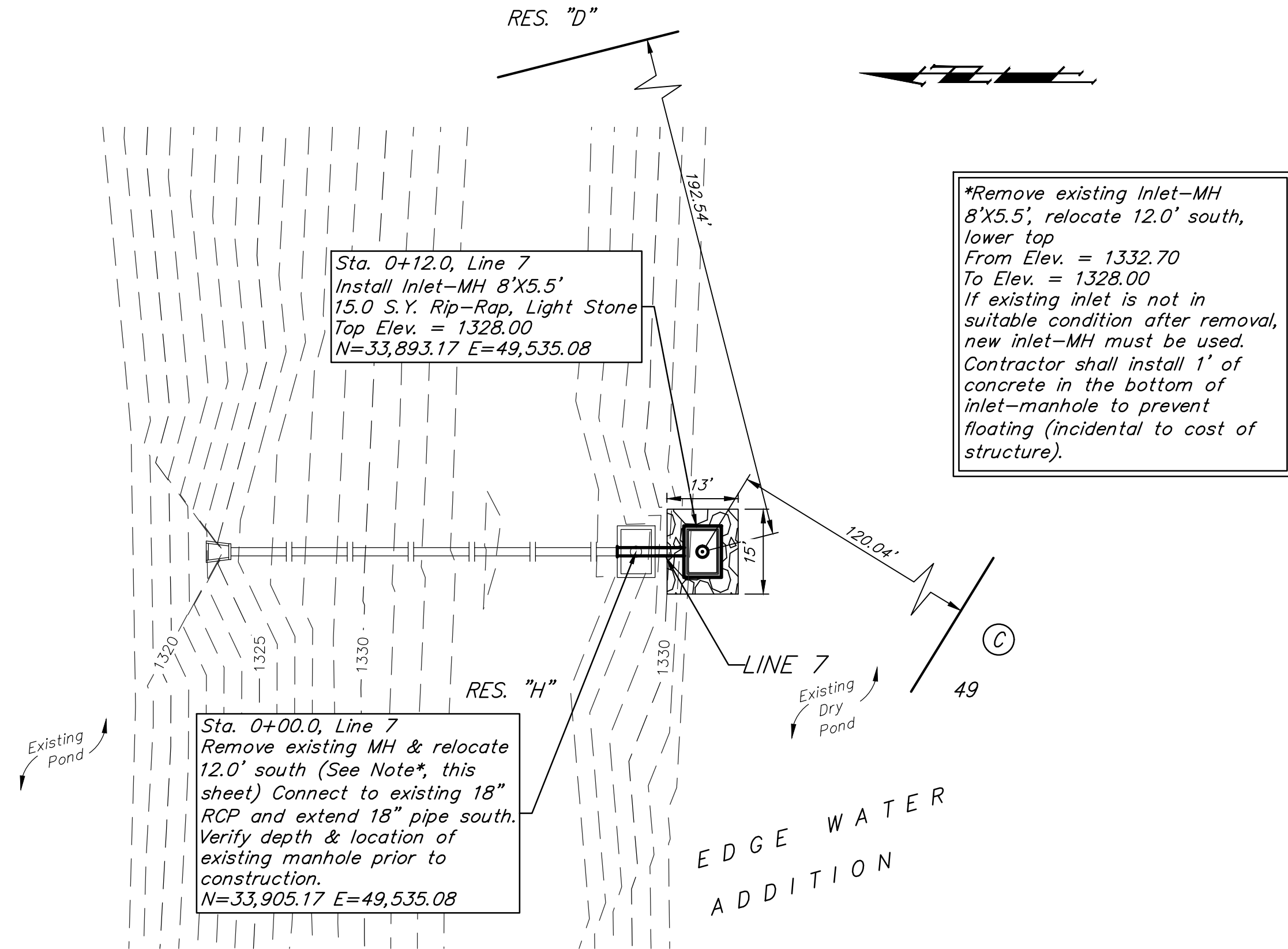

Sta. 0+00.0, Line 7
 Remove existing MH & relocate 12.0' south (See Note*, this sheet) Connect to existing 18" RCP and extend 18" pipe south. Verify depth & location of existing manhole prior to construction.
 N=33,905.17 E=49,535.08

Sta. 0+12.0, Line 7
 Install Inlet-MH 8'x5.5' 15.0 S.Y. Rip-Rap, Light Stone Top Elev. = 1328.00
 N=33,893.17 E=49,535.08

*Remove existing Inlet-MH 8'x5.5', relocate 12.0' south, lower top From Elev. = 1332.70 To Elev. = 1328.00 If existing inlet is not in suitable condition after removal, new inlet-MH must be used. Contractor shall install 1' of concrete in the bottom of inlet-manhole to prevent floating (incidental to cost of structure).

Station	Notes	Elevation
1350		1350
1345		1345
1340	Sta. 0+00.0, Line 7 Remove existing MH & relocate 12.0' south (See Note*, this sheet) Connect to existing 18" RCP and extend 18" pipe south. Verify depth & location of existing manhole prior to construction.	1340
1335	Sta. 0+12.0, Line 7 Install Inlet-MH 8'x5.5' 15.0 S.Y. Rip-Rap, Light Stone Top Elev. = 1328.00	1335
1330	Existing Grade	1330
1325		1325
1320	12.0 L.F. 18" RCP @ +0.333%	1320
1315	LINE 7	1315
1310		1310
0+00.0 0+12.0		

