

TYPICAL MASS GRADING DETAIL STREET R/W GRADING

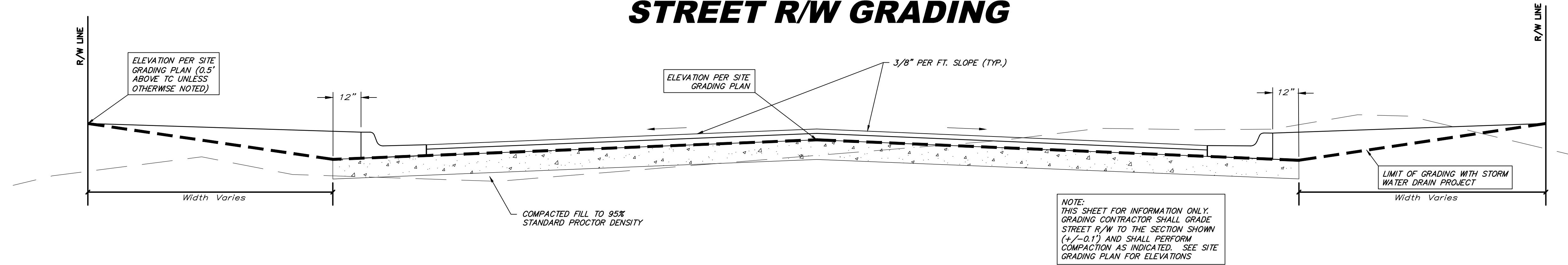

LOT FILL GRADING INTERIOR PLATTED LOT SECTION

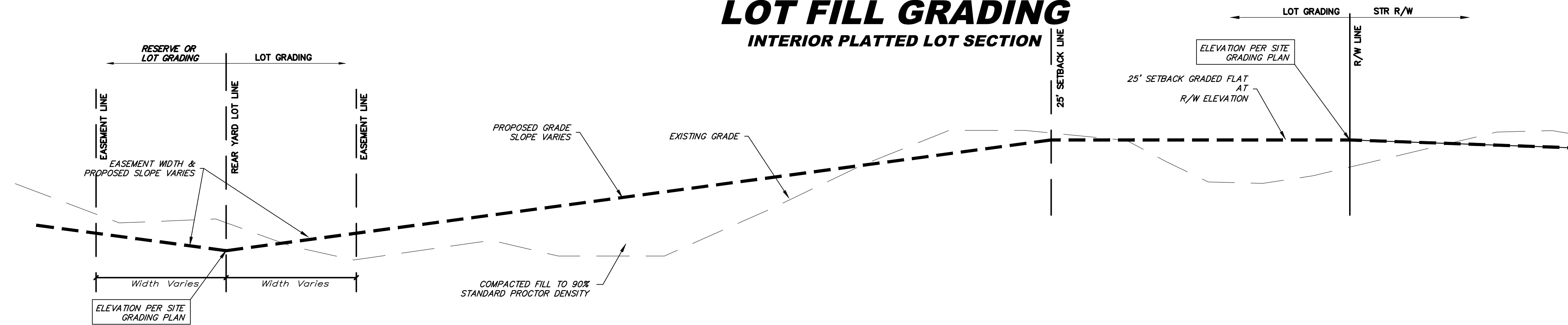

LOT FILL GRADING - PATIO HOMES LOTS 1-10, E; 1-6, D; and 27-35, A. ONLY

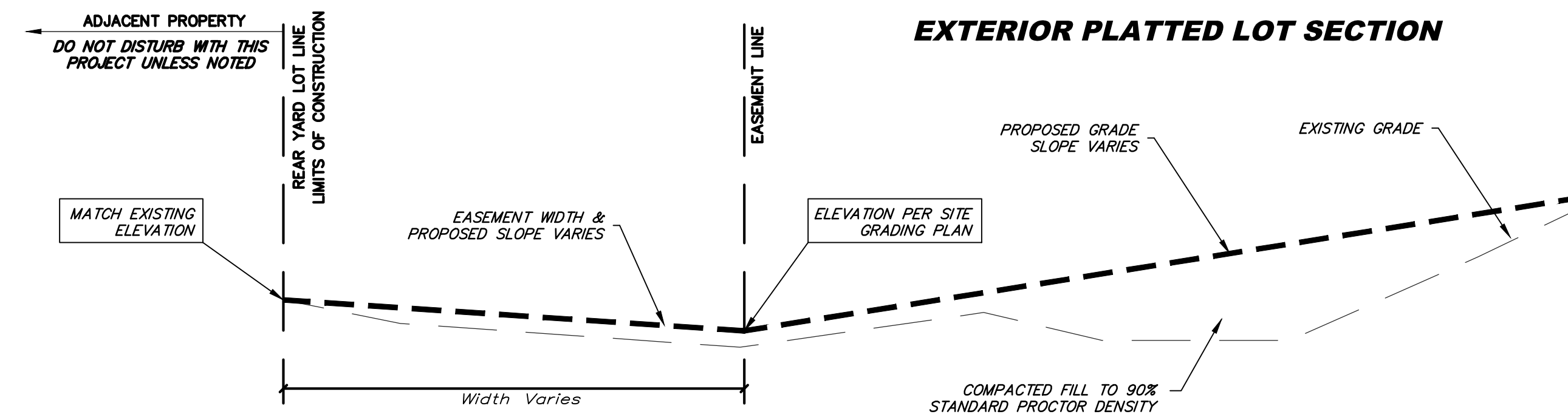
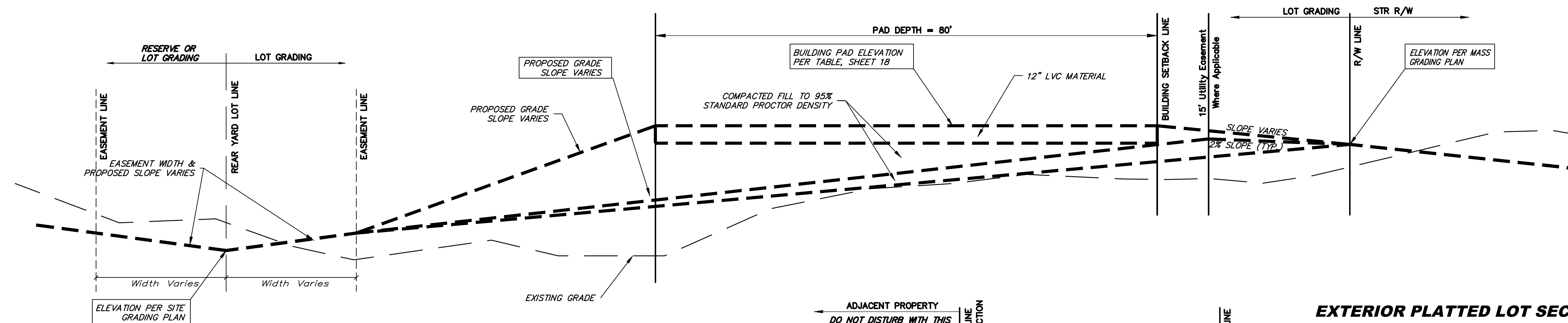

When trees are present along rear lot line, grade shall match at trunk line and trees shall not be disturbed. Any trimming of trees shall be approved by the engineer and owner.

NOTE: GRADING CONTRACTOR SHALL GRADE LOTS TO THE SECTION SHOWN (+/-0.2') AND SHALL PERFORM COMPACTION AS INDICATED. SEE SITE GRADING PLAN FOR ELEVATIONS