

NOTE: CONTRACTOR MUST CONTACT CHARLENE LAWLESS 832-3121 WITH KANSAS GAS PRIOR TO CONSTRUCTION. KANSAS GAS WILL BE RELOCATING 4" PLASTIC GAS PIPE ADJACENT TO STORM WATER SEWER INLETS.

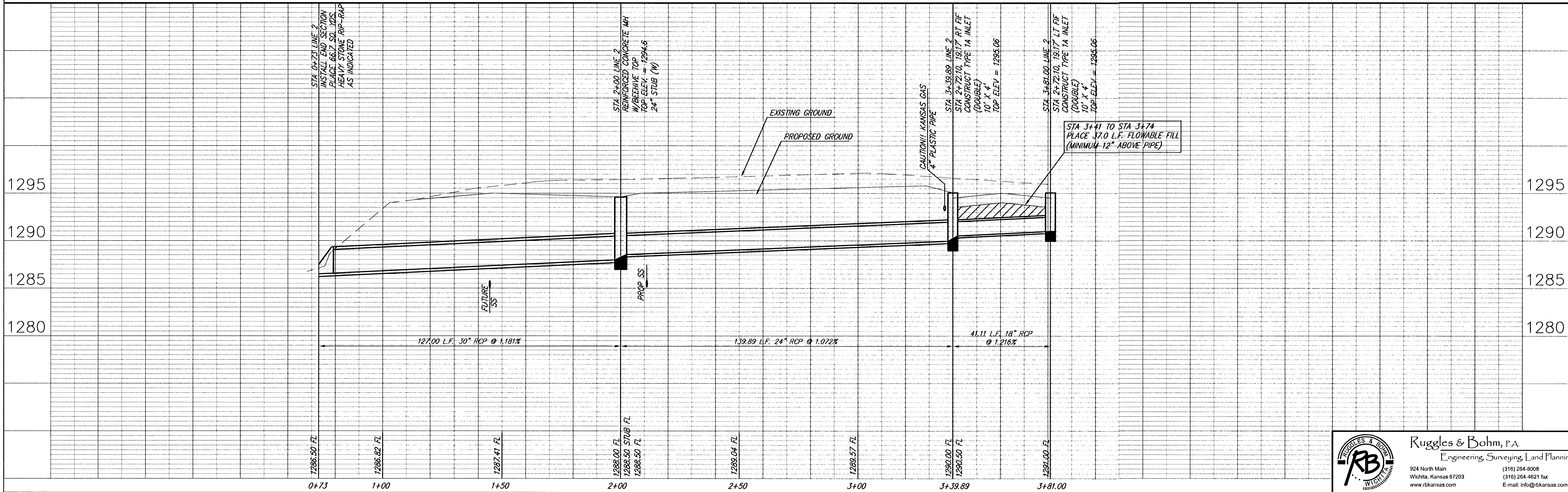
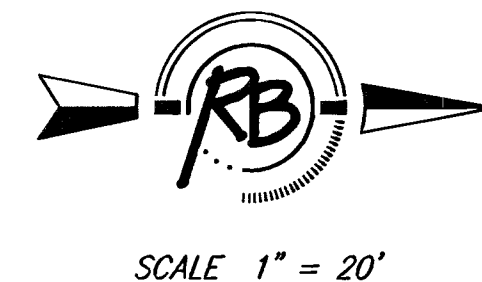

PROJECT NUMBER	472-83668
DESIGN	CMB
REVISION	REVISED
DATE	Jan. 16, 2003
UTILITY	UTILITY
DRAWING FILE	SWS [SWS 02]
PROJECT NAME	Whispering Lakes Addition
PROJECT LOCATION	Incidental Drainage WICHITA, KANSAS

Ruggles & Bohm, P.A.
 Engineering, Surveying, Land Planning
 924 North Main
 Wichita, Kansas 67203
 www.rbkansas.com
 (316) 264-8008
 (316) 264-4621 fax
 E-mail: info@rbkansas.com