

BENCHMARKS:

BM #1: 80d Spike in West face of North High Line Pole in East R/W Tyler Road 1/2 mile South of 37th Street North. Elev. = 176.05 City Datum (1363.45 NGVD)

BM #2: "□" Cut Top of Curb on West side of Pepper Ridge 15'± South of Northeast Corner Lot 23, Block 5, Forest Lakes West Addition. Elev. = 157.12 City Datum (1344.52 NGVD)

Scale: 1" = 20' Horizontal
1" = 5' Vertical
• = Iron

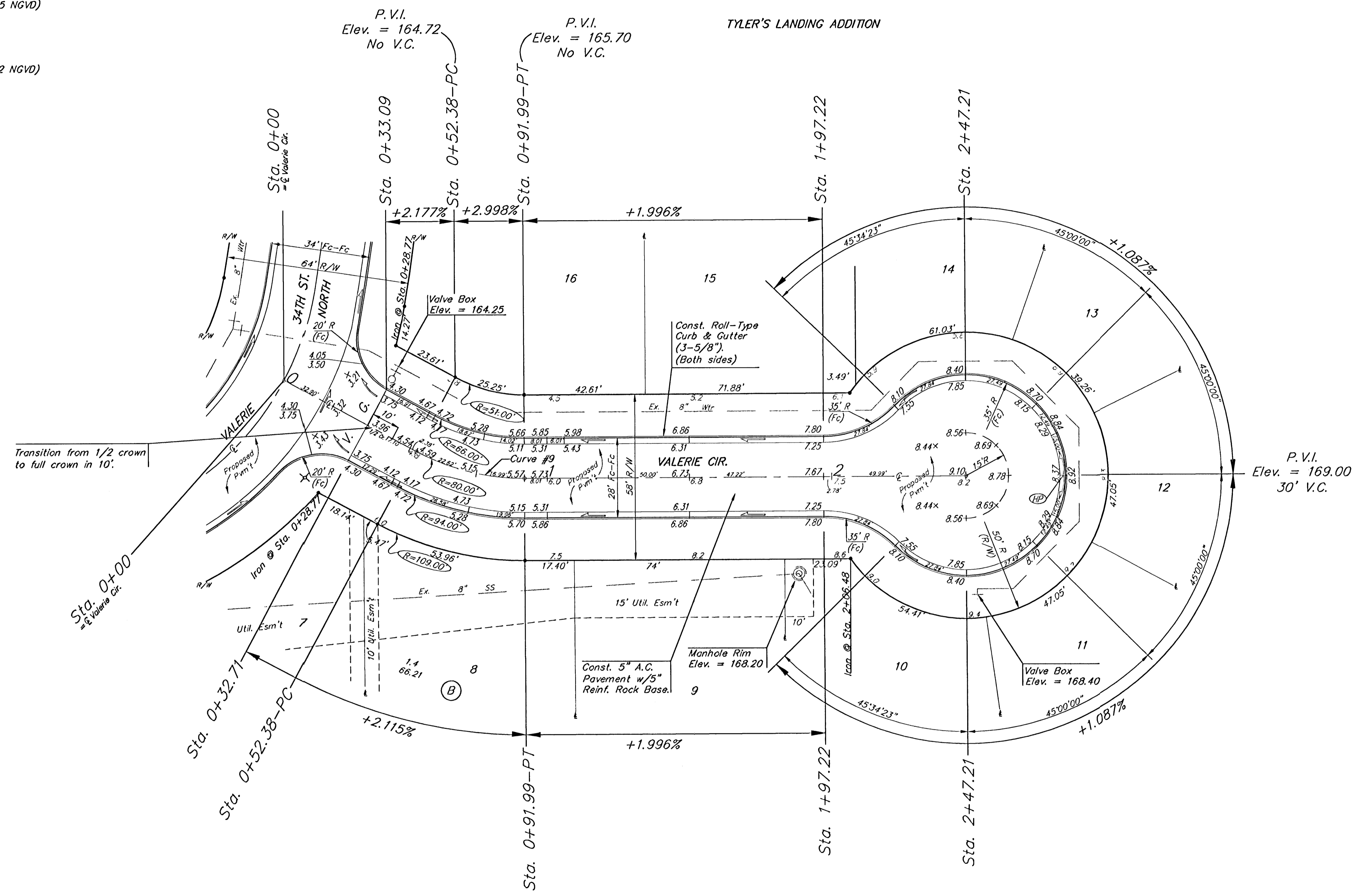

Curve #9
Curve Data Based on Centerline
Rad. = 80' Delta = 28° 21' 55" Tangent = 20.22'
Arc = 39.61' L.C. = 39.20' Def/Ft. = 21.48342 Min.

Station	Arc	CHORD			T.
		8' Lt.	8' Rt.	Def.	
0+52.38	-	-	-	0'00"00"	0'00"00"
0+75.00	22.62'	16.34'	28.74'	8'05"57"	8'05"57"
0+91.99	16.99'	12.29'	21.62'	6'05"00"	14'10"57"

Roll-type curb & gutter to be constructed on the pavement on this sheet.
Top of curb elevations are given for full-height curb.

TYLER'S LANDING ADDITION
VALERIE CIR.
LOT 7-18, BLOCK B

BAUGHMAN COMPANY P.A.
ENGINEERING, SURVEYING, & PLANNING
315-282-7271 • 315 ELLIS • WICHITA, KANSAS 67211

PROJECT NUMBER
472-83891

DESIGN: NGW DRAWN: CNX APPROVED: DATE: 6/4/03 SCALE: NOTED SHEET: **12** OF **33**