

**BENCHMARKS:**

BM #1: 80d Spike in West face of North High Line Pole in East R/W Tyler Road 1/2 mile of South of 37th Street North. Elev. = 176.05 City Datum (1363.45 NGVD)

BM #2: "□" Cut Top of Curb on West side of Pepper Ridge 15'± South of Northeast Corner Lot 23, Block 5, Forest Lakes West Addition. Elev. = 157.12 City Datum (1344.52 NGVD)



Scale: 1" = 20' Horizontal  
• = Iron

**TYLER'S LANDING ADDITION**

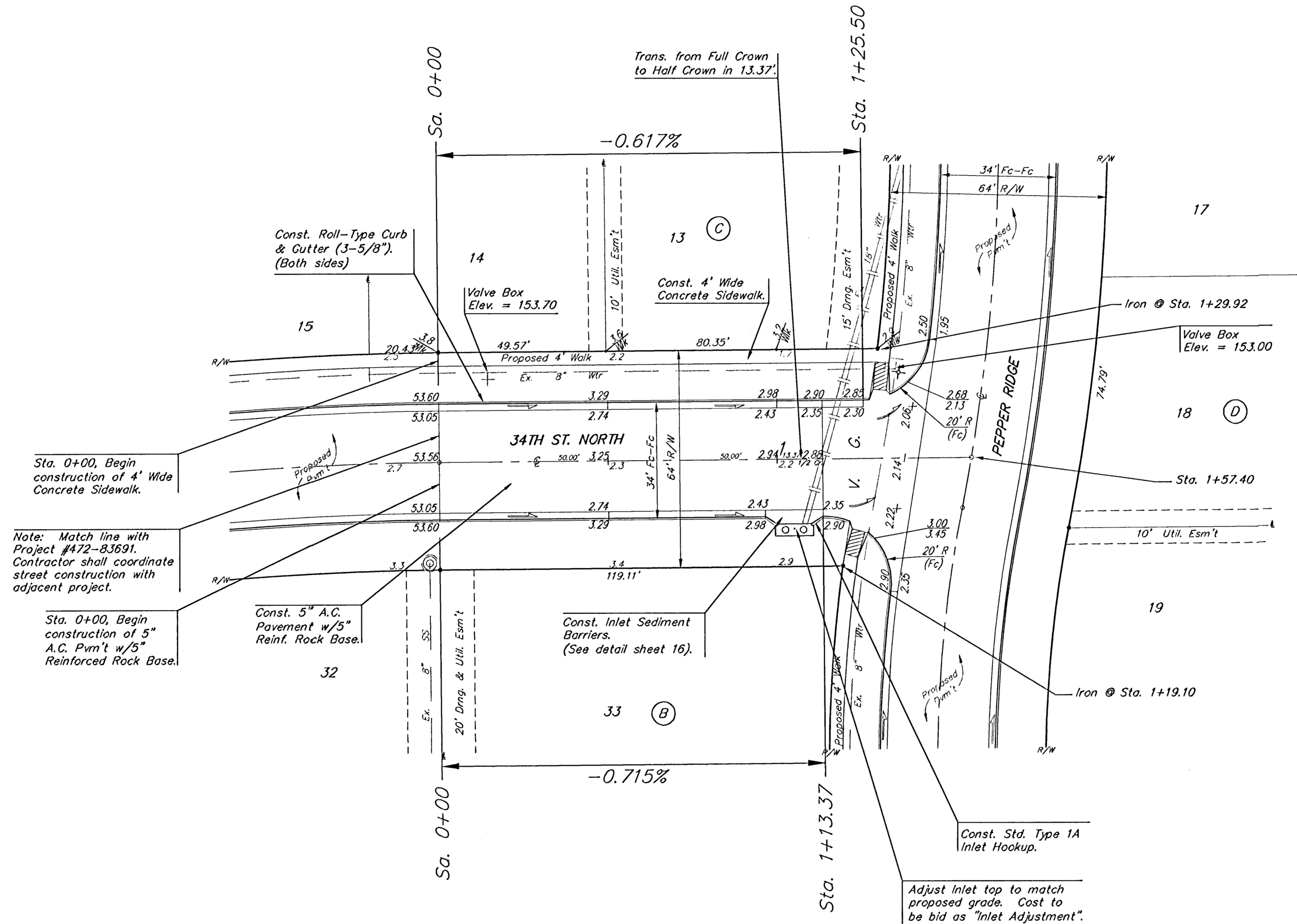

Note: Match line with Project #A72-83691. Contractor shall coordinate street construction with adjacent project.

Sta. 0+00, Begin construction of 5" A.C. Pav't w/5" Reinf. Rock Base.

Const. 5" A.C. Pav't w/5" Reinf. Rock Base.

Const. Inlet Sediment Barriers. (See detail sheet 16).

Adjust Inlet top to match proposed grade. Cost to be bid as "Inlet Adjustment".

Roll-type curb & gutter to be constructed on the pavement on this sheet. Top of curb elevations are given for full-height curb.

**TYLER'S LANDING ADDITION**  
**34TH ST. NORTH**  
STA. 0+00 TO STA. 1+25.50

**BAUGHMAN COMPANY P.A.**  
ENGINEERING, SURVEYING, & PLANNING  
316-262-7271 • 313 ELLIS • WICHITA, KANSAS 67211

PROJECT NUMBER  
**472-8392**

DESIGN NGW	DRAWN GNK	APPROVED	DATE 6/4/03
SCALE NOTED			SHEET <b>11</b> OF <b>24</b>

Tyler's Landing (P2) (Street) - 03-E540