

COORDINATE LIST

POINT	N	E
150	383519.6718	2375578.2489
151	383500.4897	2375616.6083
152	383502.5401	2375764.4721
154	383978.2979	2375731.8418
155	384013.0412	2375724.8453
160	384044.8607	2376104.7749
161	384012.1246	2376120.2711
169	383866.4484	2376344.0778
170	383835.9174	2376275.5239
171	383541.2150	2375789.0616
172	383819.1609	2375780.5330
173	383894.6210	2376213.5068
356	384016.6711	2376020.1686
358	384023.0504	2375819.1814
359	384008.4159	2375701.1038
400	383976.6589	2375705.0398
401	383991.2934	2375823.1174
515	383535.6492	2375587.9833
516	383510.2017	2375563.4357
517	383485.2416	2375619.5129
518	383507.2400	2375615.5488

900 COORDINATE POINT NUMBER  
SEE THIS SHEET FOR COORDINATES

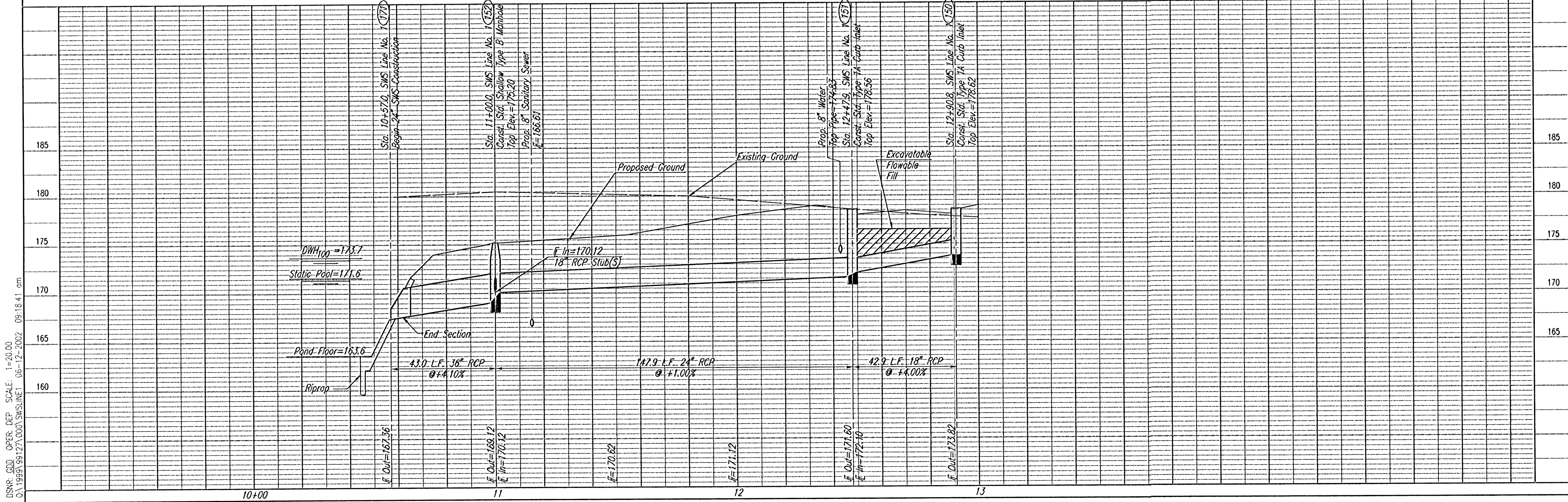

DSNR: GDD OPER: DEP SCALE: 1"=20.00  
CA: 1999/199/12/1000/SWSLINE1 06-12-2002 09:18:41 am

**SWS LINE NO. 1**  
STA. 10+57.0 TO STA. 12+90.8

CHAPEL HILL ADDITION

C.O.W. PROJ. NO. 472-76-245-83077-000-000-001

---

Professional Engineering Consultants, P.A.  
303 S. TOPEKA • WICHITA, KANSAS 67202  
316-262-2691 • FAX 316-262-3003

Designed by: EER, GDD  
Job No.: 99127  
Date: JANUARY, 2001

Drawn by: SUD