

CHAPEL HILL ADDITION

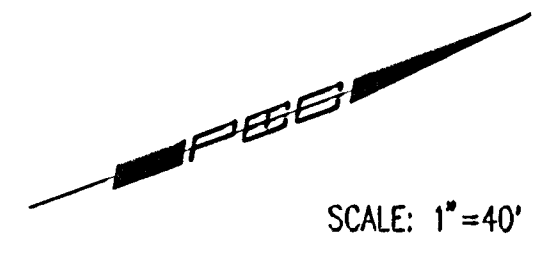

CAUTION !!! Buried Telephone SWB Tele. Co.

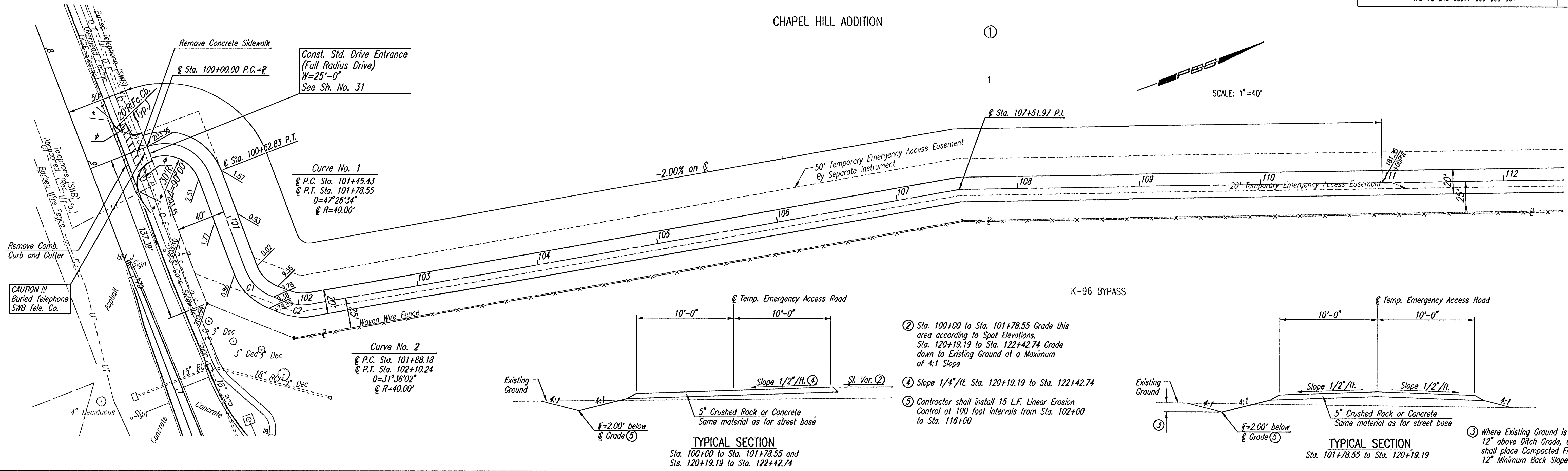
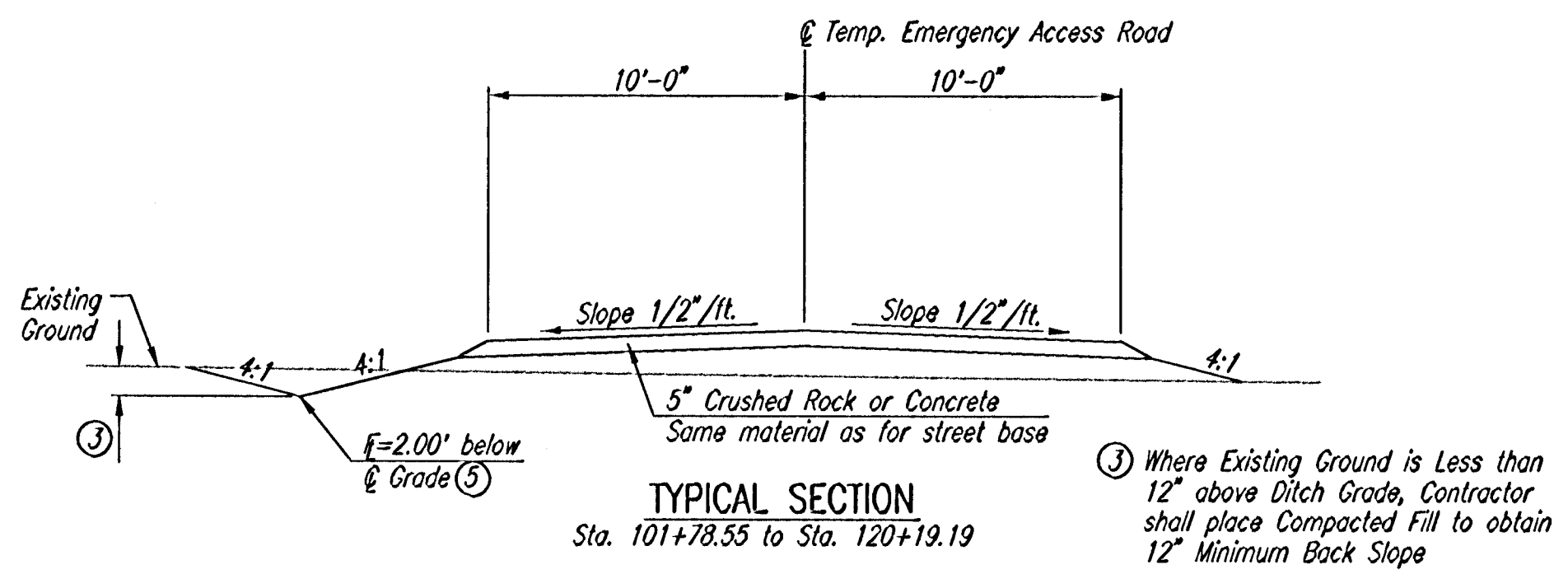
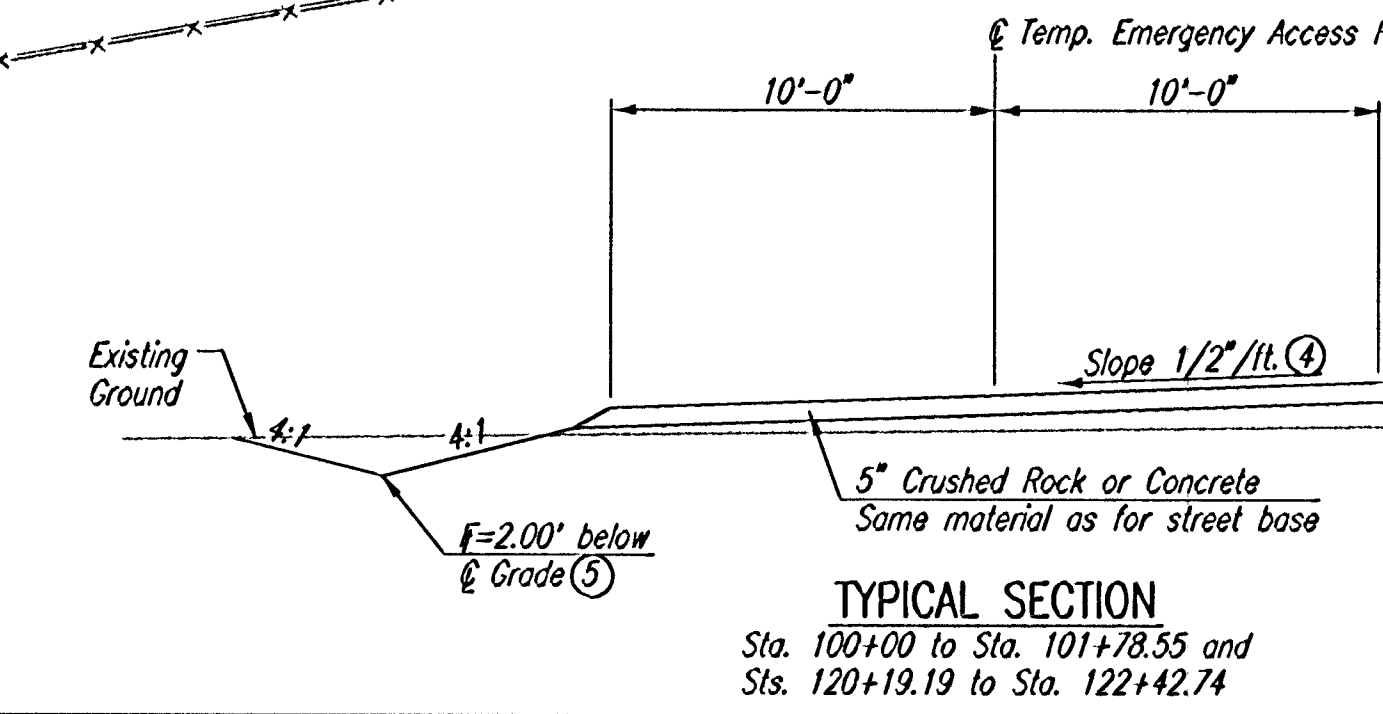

DSNR: GDD OPER: DEP SCALE: 1"=40.00
 C:\1999\99127\000\ACESROAD 06-12-2002 10:54:18 am

CHAPEL HILL ADDITION

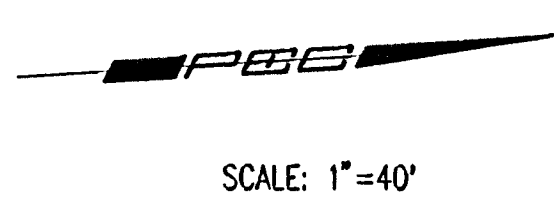
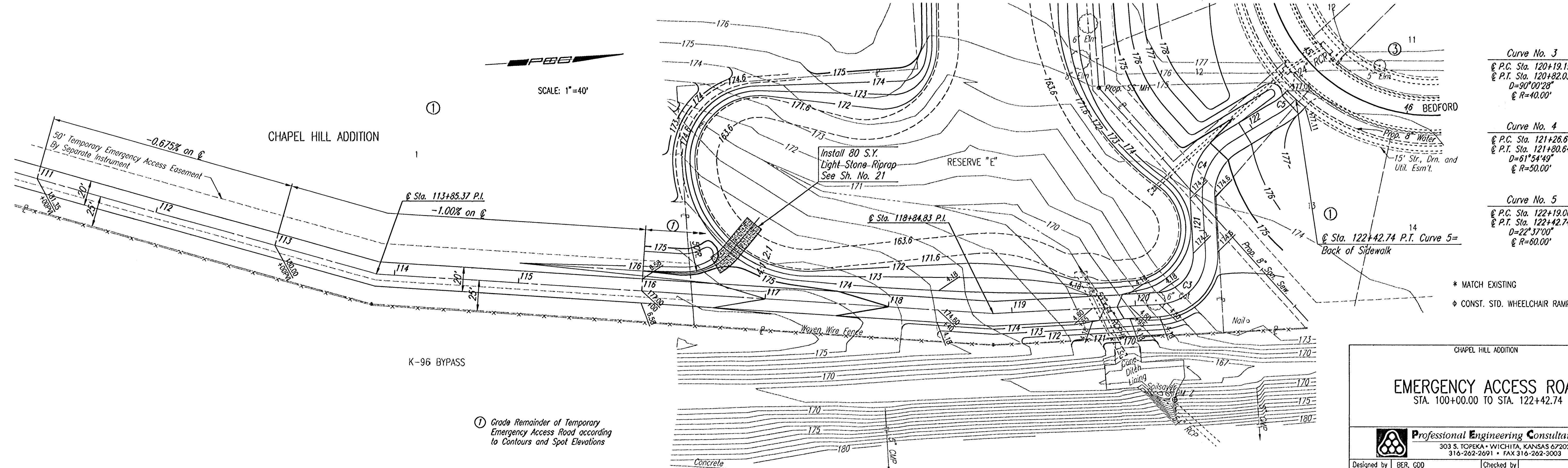

Curve No. 3
 @ P.C. Sta. 120+19.19
 @ P.T. Sta. 120+82.03
 D=90°00'28"
 @ R=40.00'

Curve No. 4
 @ P.C. Sta. 121+28.61
 @ P.T. Sta. 121+80.64
 D=61°54'49"
 @ R=50.00'

Curve No. 5
 @ P.C. Sta. 122+19.06
 @ P.T. Sta. 122+42.74
 D=22°37'00"
 @ R=60.00'

① Grade Remainder of Temporary Emergency Access Road according to Contours and Spot Elevations

CHAPEL HILL ADDITION

EMERGENCY ACCESS ROAD

STA. 100+00.00 TO STA. 122+42.74

Professional Engineering Consultants, P.A.
 303 S. TOPEKA • WICHITA, KANSAS 67202
 316-262-2691 • FAX 316-262-3003

Designed by	BER, GDD	Checked by	
Drawn by	DEP	Date	JANUARY, 2001
		Job No.	99127