

WATER VALVE BOX ELEVATIONS			
STREET	STATION	OFFSET	PROPOSED ELEVATION
CHURCHILL	46+69.73	23.0' RL	216.2

SCALE: 1"=20'

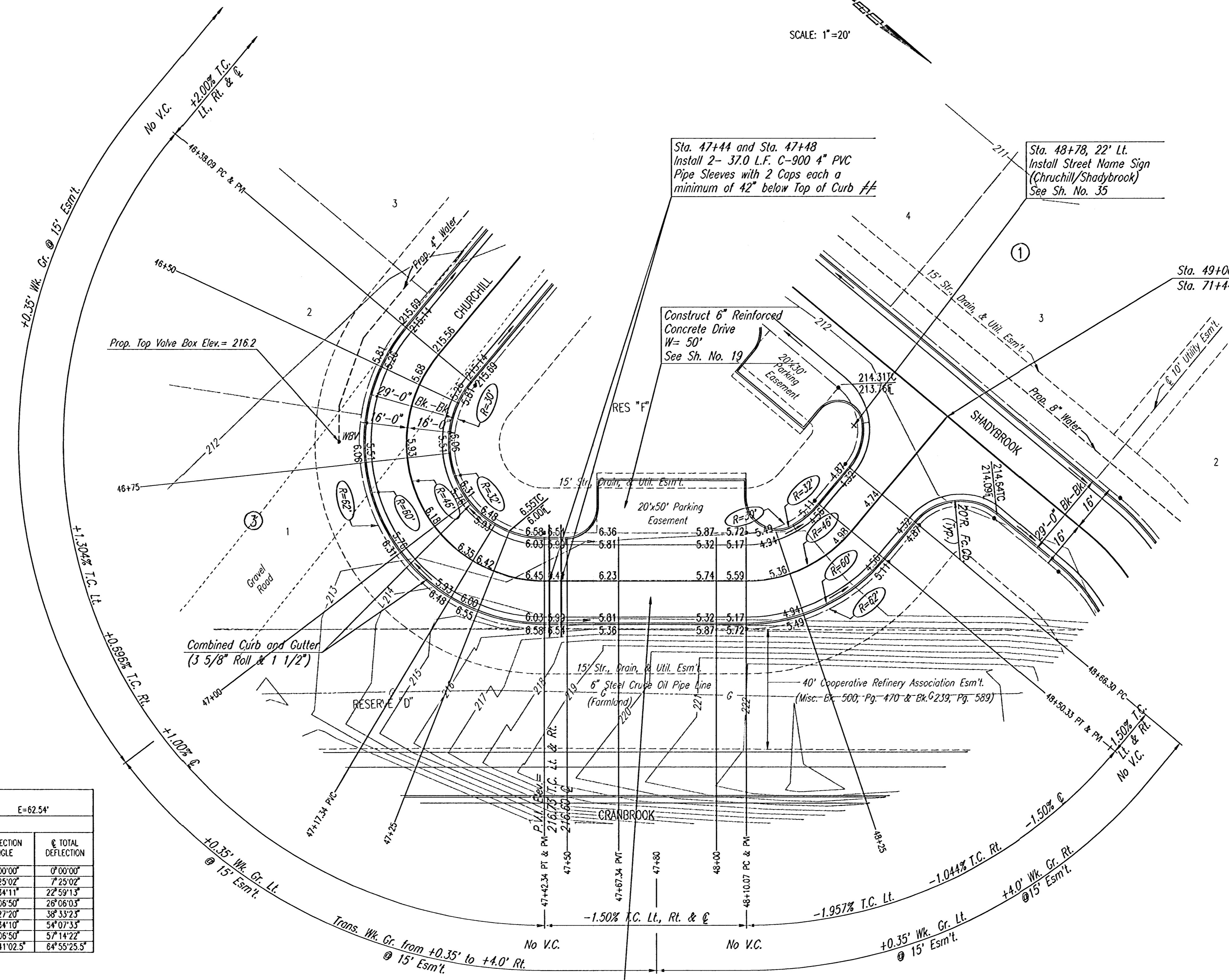

Sta. 47+44 and Sta. 47+48
Install 2- 37.0 L.F. C-900 4" PVC
Pipe Sleeves with 2 Caps each a
minimum of 42" below Top of Curb ##

Sta. 48+78, 22' Lt.
Install Street Name Sign
(Churchill/Shadybrook)
See Sh. No. 35

Construct 6" Reinforced
Concrete Drive
W= 50'
See Sh. No. 19

Sta. 49+00.31 @ Churchill=
Sta. 71+44.00 @ Shadybrook

Combined Curb and Cutter
(3 5/8" Roll & 1 1/2")

40' Cooperative Refinery Association Esm't.
(Misc. Bk. 500; Pg. 470 & Bk. G 239, Pg. 589)

CURVE DATA						
$\Delta=129^{\circ}50'51"$ $D=124^{\circ}33'22"$ $R=46.00'$ $L=104.25'$ $T=98.31'$ $E=62.54'$						
CURVE DATA BASED ON \odot RADIUS $\Delta/2=64^{\circ}55'25.5"$						
\odot STATION	\odot ARC LENGTH	FACE CURB LENGTH		CHORD LENGTH		DEFLECTION ANGLE
		LEFT	RIGHT	8'OFF LEFT	8'OFF RIGHT	\odot TOTAL
		CURB	CURB	FACE CURB	FACE CURB	DEFLECTION
46+38.09						0°00'00"
46+50	11.91'	8.29'	15.53'	6.20'	17.56'	7°25'02"
46+75	25.00'	17.39'	32.61'	12.88'	36.50'	15°34'11"
46+80	5.00'	3.48'	6.52'	2.61'	7.39'	3°06'50"
47+00	20.00'	13.91'	26.09'	10.35'	29.33'	12°27'20"
47+25	25.00'	17.39'	32.61'	12.88'	36.50'	15°34'10"
47+30	5.00'	3.48'	6.52'	2.61'	7.39'	3°06'50"
47+42.34	12.34'	8.58'	16.09'	6.42'	18.18'	7°41'02.5"
TOTAL	104.25'	72.52'	135.97'			Defl./ft.=37.366187 min.

CURVE DATA						
$\Delta=50^{\circ}09'09"$ $D=124^{\circ}33'22"$ $R=46.00'$ $L=40.27'$ $T=21.52'$ $E=4.79'$						
CURVE DATA BASED ON \odot RADIUS $\Delta/2=25^{\circ}04'34.5"$						
\odot STATION	\odot ARC LENGTH	FACE CURB LENGTH		CHORD LENGTH		DEFLECTION ANGLE
		LEFT	RIGHT	8'OFF LEFT	8'OFF RIGHT	\odot TOTAL
		CURB	CURB	FACE CURB	FACE CURB	DEFLECTION
48+10.07						0°00'00"
48+25	14.93'	10.39'	19.47'	7.76'	21.97'	9°17'53"
48+50.34	25.34'	17.62'	33.05'	12.88'	36.99'	15°46'41.5"
TOTAL	40.27'	28.01'	52.52'			Defl./ft.=37.362180 min.

NOTE: THIS STREET TO BE CONSTRUCTED WITH ROLL-TYPE CURB. TOP OF CURB ELEVATIONS GIVEN ARE FOR FULL HEIGHT CURB.

EACH END OF 4" PVC PIPE SLEEVE SHALL BE MARKED WITH STEEL "I" POSTS OR 2" STEEL PIPE A MAXIMUM OF 12" ABOVE GRADE. PIPE, CAPS, PIPE INSTALLATION AND MARKERS SHALL BE SUBSIDIARY TO "COMBINED CURB AND GUTTER (6 5/8" & 1 1/2)".

RECORD DRAWING

24 NOV 03

REMINGTON PLACE - PHASE 2

CHURCHILL
STA. 46+38.09 TO STA. 49+00.31

Professional Engineering Consultants, P.A.
303 S. TOPEKA • WICHITA, KANSAS 67202
316-262-2691 • FAX 316-262-3003

Designed by	BER	Checked by	
Drawn by	DEP	Date	DEC, 2002
		Job No.	02398

DSNR: DEP OPER: DEP SCALE: 1"=20.00
 C:\2002\02398\000\CHURCHILLS2_12-03-2002_03:13:02.pm