

# HARRISON PARK 2ND ADDITION PHASE 3 STREET IMPROVEMENTS SERVING LOTS 1, 30 - 53, BLOCK 1

**PROJECT NO. 472-83394  
O.C.A. NO. 765693**

## GENERAL NOTES

Contractor will be required to provide a minimum advance notice of twenty-four (24) hours to utility companies prior to starting any excavation as follows:

Kansas One-Call 687-2470

The Contractor must notify the following in case of an emergency:

Cox Communications 262-0661  
Kansas Gas Service 383-8600  
K.G.E. Electric 383-8600  
Peoples Natural Gas Company 1-800-303-0357  
Southwestern Bell Telephone Company 1-800-286-8313  
City of Wichita Water Department 262-6000  
City of Wichita Sewer Maintenance 262-6000

Utility service lines, poles, valve boxes, meters, and et cetera are to be adjusted as necessary by others prior to construction unless the plans specifically call for their adjustment by the Contractor or unless the plans specifically identify a utility to be adjusted by its owner during construction. Existing utilities and their location, as shown on the plans, represent the best information obtainable for design. The Contractor will be required to work around existing utilities within the right-of-way which do not conflict with proposed construction.

A saw cut of at least one-half the depth of existing surface courses or one-fourth the depth of existing total pavement thickness shall be provided at locations where proposed construction abuts an existing surface course or pavement for which partial removal of that surface or pavement is required, except when such saw cuts are within three (3) feet of an existing joint the limits of removal shall be extended to the existing joint. Such saw cuts will not be paid for directly and this cost shall be considered as subsidiary to the removal of the surface or pavement.

Rubble from the removal of miscellaneous structures and excess excavation which is to be wasted shall be disposed of on sites to be provided by the Contractor. These sites shall be approved by the Engineer as to suitability, appearance and site location. Locations that, in the opinion of the Engineer, will leave an unsightly appearance will not be approved.

All disposal sites must be approved by the Kansas Department of Health and Environment. Material either stockpiled or disposed of in a flood plain would require a Kansas State Board of Agriculture permit. Any material dumped in waters of the United States or wetlands is subject to U.S. Corps permitting regulations. Any material buried or stockpiled beyond approved of Engineers construction limits would require additional archeological investigations unless buried in a previously approved borrow location.

The Engineer shall take field ties to all quarter section corners. The Contractor shall set a City survey monument in the required location where such quarter section corners fall within the limits of pavement construction. Survey monuments will be furnished by the City. The Engineer will accurately locate and install the iron at the quarter section corner. This work will not be paid for directly, but shall be considered subsidiary to the other pay items of work in the contract.

Trees and shrubs in public right-of-way which are in direct conflict with proposed new construction shall be removed by the Contractor with the Engineer's approval. Trees and shrubs which are not in direct conflict with proposed new construction shall be saved and protected from damage.

The Contractor shall be responsible for preserving property irons. The Contractor will be required to re-establish any property irons which are damaged or destroyed by his construction operations. Such irons shall be re-established by a licensed land surveyor in accordance with state laws.

Contractor will be required to provide a minimum advance notice of twenty-four (24) hours to utility companies prior to starting any excavation as follows:

The Contractor shall seed, fertilize and mulch all disturbed areas per City specifications upon completion of construction.

Subdivision Bench Marks shall be "Flat Survey Markers No. 8134-08 3" top diameter" provided by Kansas Blue Print Co., Inc. Bench mark installation cost to be subsidiary to curb & gutter.

TOTAL PROJECT LENGTH = 1,112.8 FT.

## SUMMARY OF EARTHWORK

EXCAVATION = 2,401 C.Y.  
LOOSE FILL = 881 C.Y.  
COMPACTED FILL = 0 C.Y.  
BORROW = 0 C.Y.

## PROJECT BENCHMARKS

BM #1 - CHISELED "C" AT WEST CURB TODD ST. AT CENTERLINE TODD CT. EXTENDED APP. 220' SOUTH OF SOUTH LINE HARRISON PARK ADDITION. ELEV. = 1345.80

BM #2 - CHISELED "C" AT WEST SIDE OF NORTH RETURN AT NORTHWEST CORNER OF LINCOLN AND TODD ELEV. = 1349.30

## INDEX OF SHEETS

1. TITLE SHEET
2. TYPICAL 35" PVMT. SECTION
3. TYPICAL 29" PVMT. SECTION
4. VALLEY GUTTER DETAIL
5. MORRIS
- 6-7. RED OAKS
- 8-9. INCIDENTAL DRAINAGE
10. TYPE 1A INLET DETAIL
11. SHALLOW TYPE 'P' MANHOLE DETAIL
12. SHALLOW TYPE 'P' MANHOLE DETAIL
13. SIGNING DETAILS
- 14-17. EROSION CONTROL BMPS
- 18-20. EARTHWORK CROSS SECTIONS
21. PLAT COPY

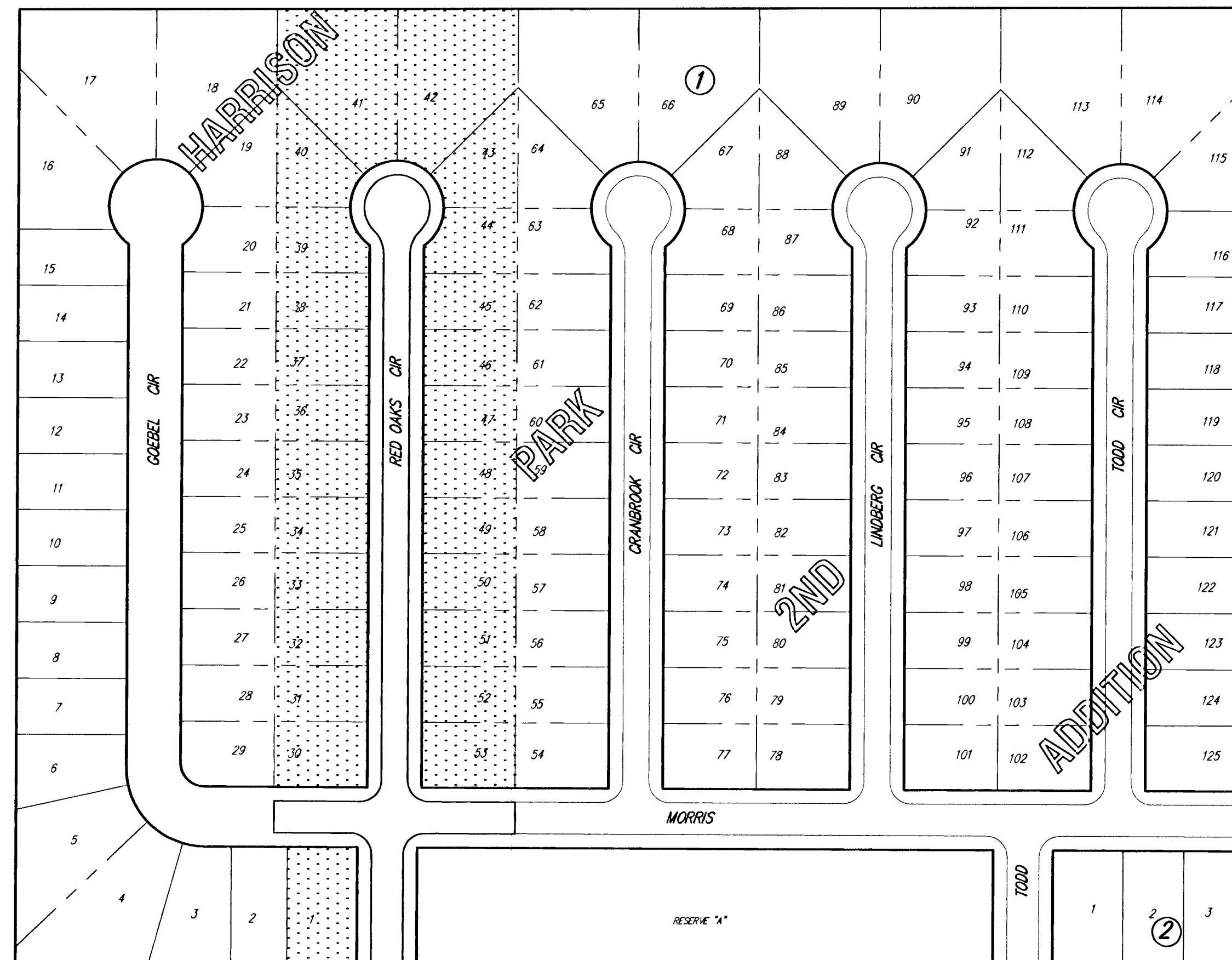

Scale: 1" = 200'

Handwritten note: DRAINAGE BOOKED 1-31-03 MEG C-240

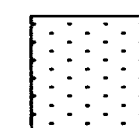
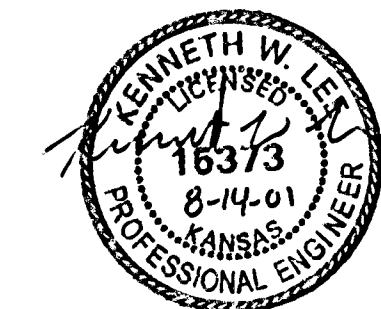
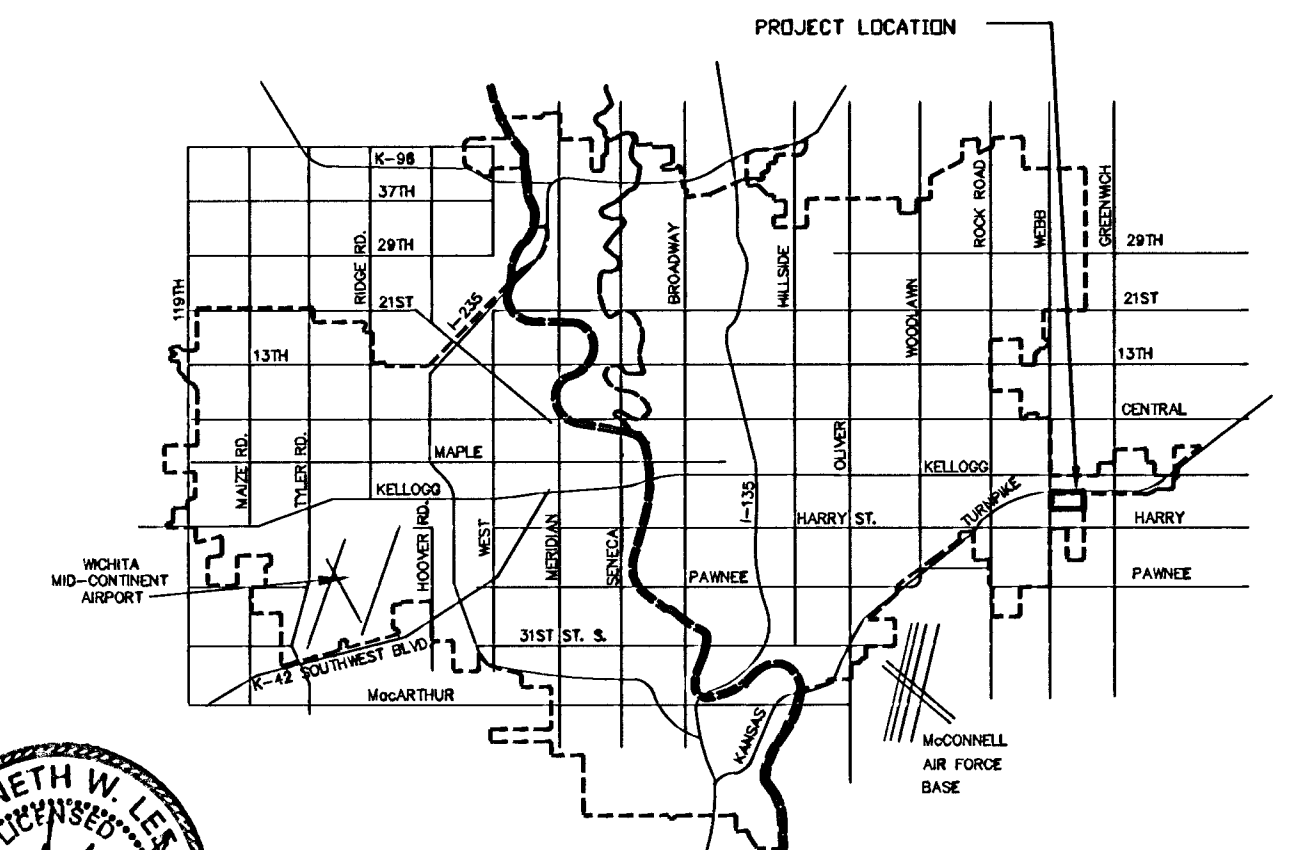

IMPROVEMENT DISTRICT

CITY OF WICHITA, KANSAS

MICHAEL E. LINDEBAK, P.E. - CITY ENGINEER

SRB 924 NORTH MAIN WICHITA, KANSAS 67203 316-264-8008 FAX 264-4621  
SAVOY, RUGGLES & BOHM, P.A. ENGINEERING & SURVEYING