

BENCHMARKS:

BM #1: "□" Cut in top of curb on north side of Athenian, near the SE corner of Lot 13, Block 1, Valencia Addition.
Elev. = 1332.11 NAVD88

BM #2: Cross cut in sidewalk on north side of Harborlight St., near Lot 23, Block 1, Harbor Isle 2nd Addition.
Elev. = 1330.40 NAVD88

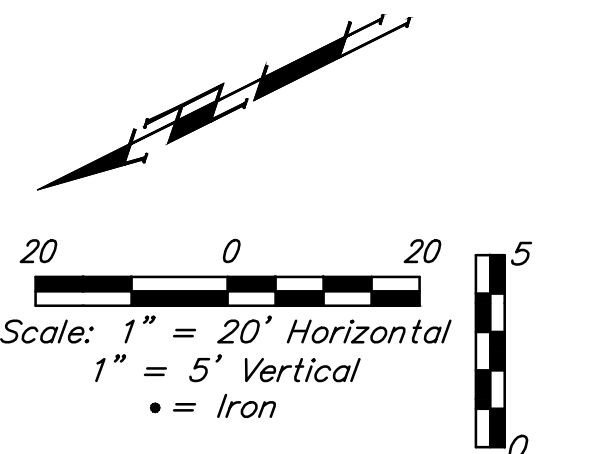
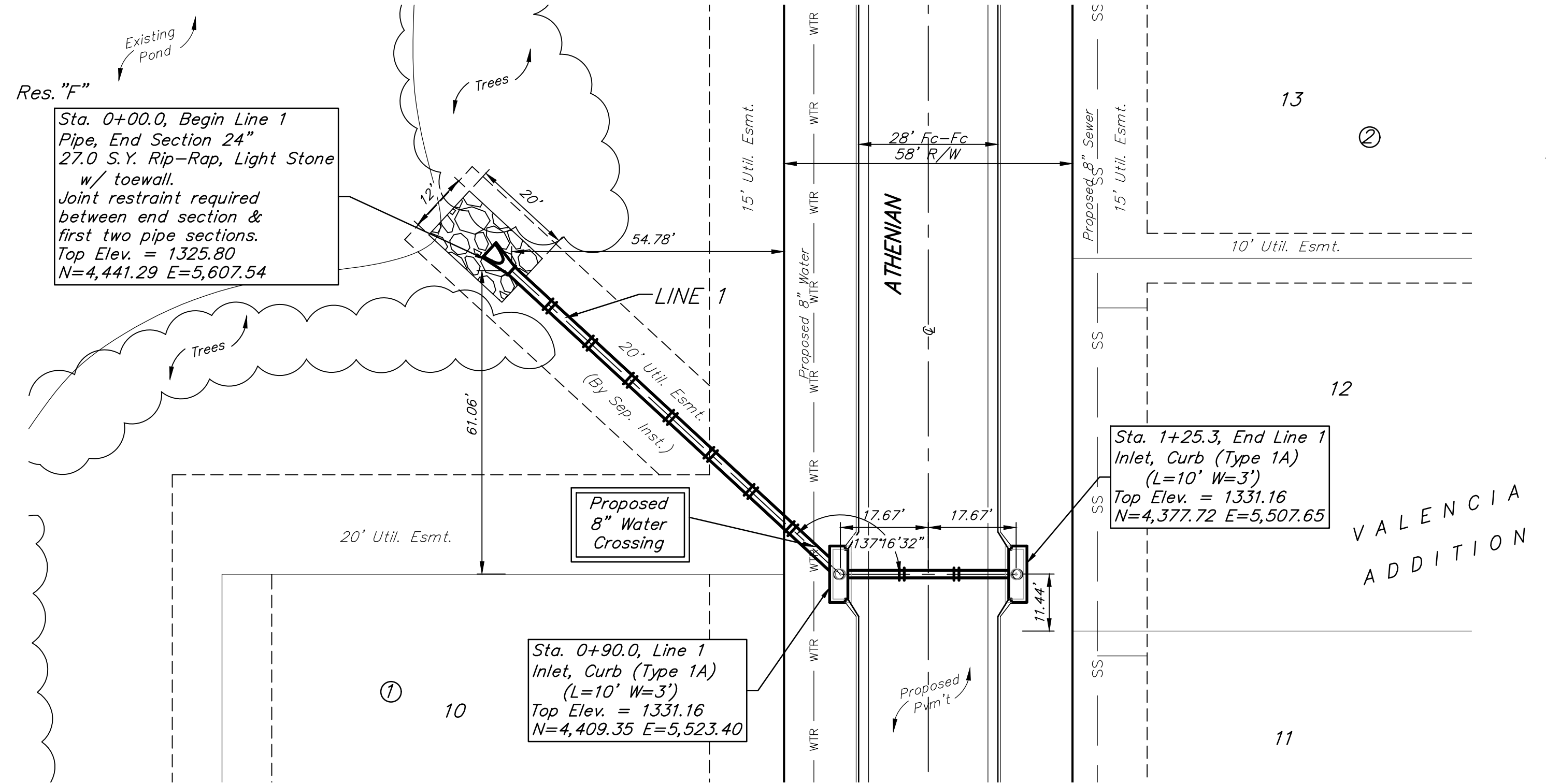

All trench and inlet excavation areas from Sta. 0+90.0 to Sta. 1+25.3, Line 1 shall be backfilled with sand. The sand backfill shall be within two feet of existing grade and shall be water-jetted and vibrated during backfilling. All costs shall be paid for as L.F. "Fill, Sand (Flushed & Vibrated)".

