

PINE MEADOW
ADDITION

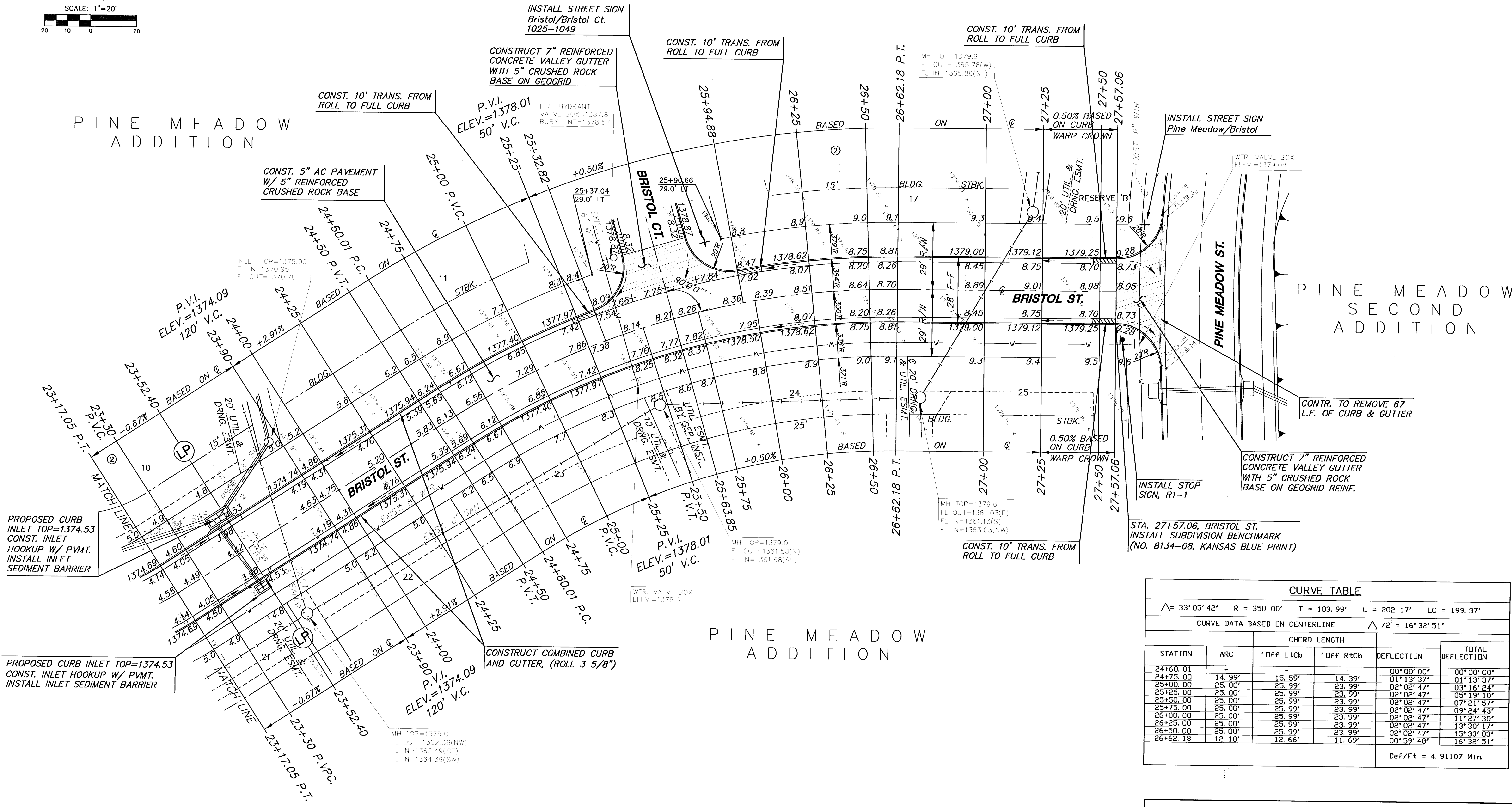

PROPOSED CURB
INLET TOP=1374.53
CONST. INLET
HOOKUP W/ PVMT.
INSTALL INLET
SEDIMENT BARRIER

PROPOSED CURB INLET TOP=1374.53
CONST. INLET HOOKUP W/ PVMT.
INSTALL INLET SEDIMENT BARRIER

INSTALL STREET SIGN
Bristol/Bristol Ct.
1025-1049

CONSTRUCT 7" REINFORCED
CONCRETE VALLEY GUTTER
WITH 5" CRUSHED ROCK
BASE ON GEOGRID

CONST. 10' TRANS. FROM
ROLL TO FULL CURB

CONST. 10' TRANS. FROM
ROLL TO FULL CURB

CONST. 10' TRANS. FROM
ROLL TO FULL CURB

CONST. 5" AC PAVEMENT
W/ 5" REINFORCED
CRUSHED ROCK BASE

INSTALL STREET SIGN
Pine Meadow/Bristol

WTR. VALVE BOX
ELEV.=1379.08

PINE MEADOW
SECOND
ADDITION

CONTR. TO REMOVE 67'
L.F. OF CURB & GUTTER

CONSTRUCT 7" REINFORCED
CONCRETE VALLEY GUTTER
WITH 5" CRUSHED ROCK
BASE ON GEOGRID REINF.

INSTALL STOP
SIGN, R1-1

STA. 27+57.06, BRISTOL ST.
INSTALL SUBDIVISION BENCHMARK
(NO. 8134-08, KANSAS BLUE PRINT)

PINE MEADOW
ADDITION

CURVE TABLE

$\Delta = 33^{\circ}05'42"$ $R = 350.00'$ $T = 103.99'$ $L = 202.17'$ $LC = 199.37'$					
CURVE DATA BASED ON CENTERLINE $\Delta / 2 = 16^{\circ}32'51"$					
STATION	ARC	CHORD LENGTH		DEFLECTION	TOTAL DEFLECTION
		' Off LtCb	' Off RtCb		
24+60.01	-	-	-	00°00'00"	00°00'00"
24+75.00	14.99'	15.59'	14.39'	01°13'37"	01°13'37"
25+00.00	25.00'	25.99'	23.99'	02°02'47"	03°16'24"
25+25.00	25.00'	25.99'	23.99'	02°02'47"	05°19'10"
25+50.00	25.00'	25.99'	23.99'	02°02'47"	07°21'57"
25+75.00	25.00'	25.99'	23.99'	02°02'47"	09°24'43"
26+00.00	25.00'	25.99'	23.99'	02°02'47"	11°27'30"
26+25.00	25.00'	25.99'	23.99'	02°02'47"	13°30'17"
26+50.00	25.00'	25.99'	23.99'	02°02'47"	15°33'03"
26+62.18	12.18'	12.66'	11.69'	00°59'48"	16°32'51"
Def/Ft = 4.91107 Min.					

SUBDIVISION BENCH MARKS				
NO.	STREET AND STATION	FROM CL	DESCRIPTION	ELEVATIONS
4	BRISTOL, STA. 27+57.06	14.5' RT	TOP OF CURB AT END OF RETURN, BRISTOL	

NOTE: CONTRACTOR SHALL INSTALL SUBDIVISION BENCH MARKS ("FLAT SURVEY MARKERS NO. 8134-08 3" TOP DIAMETER" PROVIDED BY KANSAS BLUE PRINT CO., INC.) COSTS TO BE CONSIDERED SUBSIDIARY TO CONSTRUCTION OF COMBINED CURB AND GUTTER.

NOTE:
TOP OF CURB ELEVATIONS SHOWN ARE
FOR FULL CURB. CONSTRUCT COMBINED
CURB & GUTTER, ROLLED (3 5/8").

LEGEND
+ STREET SIGN & SIGN LOCATION
(SEE SIGN ASSEMBLY TABLE
FOR TYPE & STATION OF SIGN)

PINE MEADOW ADDITION
PROJECT NAME

PAVING PLANS - BRISTOL STREET
SHEET TITLE

DESIGN BY: JAS DRAWN BY: ASH CHECKED BY: ASH

DATE: JULY 2003 JOB NO.: 01077 SHEET/OF: 8 / 30

411 N. WEBB ROAD
WICHITA, KS. 67206
316-264-9600