

PAVING PLANS
MONARCH LANDING
1st ADDITION

**GRAYSTONE/
CAMDEN CHASE**
SHEET TITLE
472-84505
PROJECT NUMBER

DFL
DESIGN BY
KKL
DRAWN BY
CAMDEN
CHECKED BY

ISSUED
April 2007

REVISIONS

SHEET NO.
15 of 55

CURVE TABLE

$\Delta = 06^{\circ}47'08''$ R = 750.00' T = 44.46' L = 88.82' LC = 88.77'

CURVE DATA BASED ON CENTERLINE $\Delta / 2 = 03^{\circ}23'34''$

STATION	ARC	CHORD LENGTH		DEFLECTION	TOTAL DEFLECTION
		8' Off LtCb	8' Off RtCb		
15+55.22	-	-	-	00°00'00"	00°00'00"
15+75.00	19.78'	20.44'	19.12'	00°45'20"	00°45'20"
16+00.00	25.00'	25.83'	24.17'	00°57'18"	01°42'38"
16+25.00	25.00'	25.83'	24.17'	00°57'18"	02°39'55"
16+44.04	19.04'	19.68'	18.41'	00°43'39"	03°23'34"

Def/Ft = 2.29183 Min.

CURVE TABLE

$\Delta = 100^{\circ}31'49''$ R = 200.00' T = 240.60' L = 350.92' LC = 307.60'

CURVE DATA BASED ON CENTERLINE $\Delta / 2 = 50^{\circ}15'55''$

STATION	ARC	CHORD LENGTH		DEFLECTION	TOTAL DEFLECTION
		8' Off LtCb	8' Off RtCb		
17+15.95	-	-	-	00°00'00"	00°00'00"
17+25.00	9.05'	7.92'	10.18'	01°17'47"	01°17'47"
17+50.00	25.00'	21.86'	28.11'	03°34'52"	04°52'38"
17+75.00	25.00'	21.86'	28.11'	03°34'52"	08°27'30"
18+00.00	25.00'	21.86'	28.11'	03°34'52"	12°02'21"
18+25.00	25.00'	21.86'	28.11'	03°34'52"	15°37'13"
18+50.00	25.00'	21.86'	28.11'	03°34'52"	19°12'04"
18+75.00	25.00'	21.86'	28.11'	03°34'52"	22°46'56"
19+00.00	25.00'	21.86'	28.11'	03°34'52"	26°21'48"
19+25.00	25.00'	21.86'	28.11'	03°34'52"	29°56'39"
19+50.00	25.00'	21.86'	28.11'	03°34'52"	33°31'31"
19+75.00	25.00'	21.86'	28.11'	03°34'52"	37°06'22"
20+00.00	25.00'	21.86'	28.11'	03°34'52"	40°41'14"
20+25.00	25.00'	21.86'	28.11'	03°34'52"	44°16'05"
20+50.00	25.00'	21.86'	28.11'	03°34'52"	47°50'57"
20+66.87	16.87'	14.75'	18.97'	02°24'58"	50°15'54"

Def/Ft = 8.59437 Min.

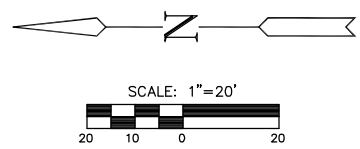
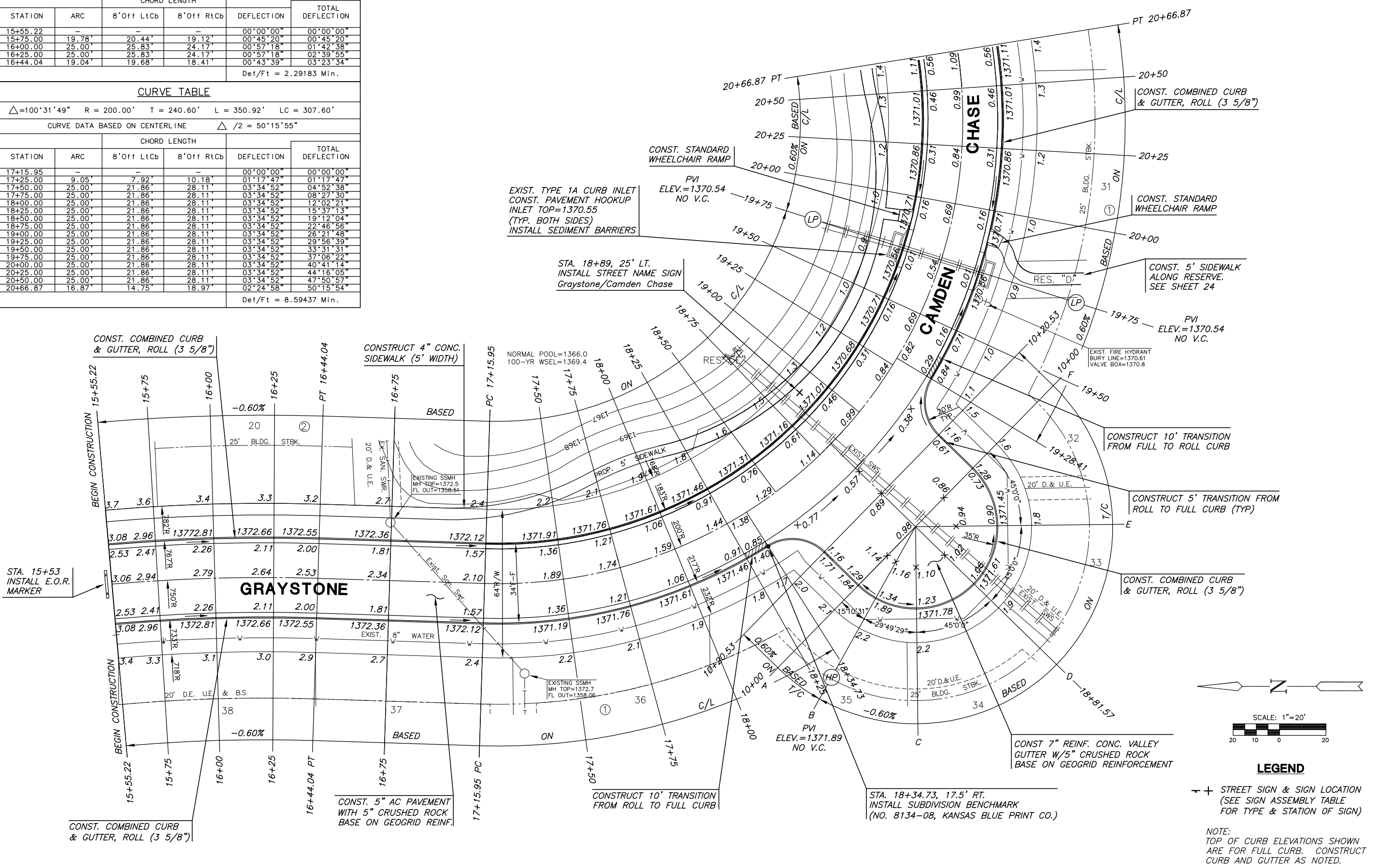

LEGEND

—+— STREET SIGN & SIGN LOCATION (SEE SIGN ASSEMBLY TABLE FOR TYPE & STATION OF SIGN)

NOTE:
TOP OF CURB ELEVATIONS SHOWN ARE FOR FULL CURB. CONSTRUCT CURB AND GUTTER AS NOTED.