

**PAVING PLANS**  
**MONARCH LANDING**  
**1st ADDITION**

CURVE TABLE						CURVE TABLE					
$\Delta = 09^{\circ}57'43''$ R = 800.00' T = 69.72' L = 139.09' LC = 138.92'						$\Delta = 87^{\circ}56'57''$ R = 150.00' T = 144.72' L = 230.25' LC = 208.30'					
CURVE DATA BASED ON CENTERLINE $\Delta / 2 = 04^{\circ}58'52''$						CURVE DATA BASED ON CENTERLINE $\Delta / 2 = 43^{\circ}58'29''$					
STATION	ARC	CHORD LENGTH		DEFLECTION	TOTAL DEFLECTION	STATION	ARC	CHORD LENGTH		DEFLECTION	TOTAL DEFLECTION
		8' Off LtCb	8' Off RtCb					8' Off LtCb	8' Off RtCb		
25+00.00	-	-	-	00°00'00"	00°00'00"	26+39.09	-	-	-	00°00'00"	00°00'00"
25+25.00	25.00'	24.22'	25.78'	00°53'43"	00°53'43"	26+50.00	10.91'	9.09'	12.73'	02°05'01"	02°05'01"
25+50.00	25.00'	24.22'	25.78'	00°53'43"	01°47'26"	26+75.00	25.00'	20.81'	29.13'	04°46'29"	06°51'30"
25+75.00	25.00'	24.22'	25.78'	00°53'43"	02°41'09"	27+00.00	25.00'	20.81'	29.13'	04°46'29"	11°37'59"
26+00.00	25.00'	24.22'	25.78'	00°53'43"	03°34'52"	27+25.00	25.00'	20.81'	29.13'	04°46'29"	16°24'27"
26+25.00	25.00'	24.22'	25.78'	00°53'43"	04°28'34"	27+50.00	25.00'	20.81'	29.13'	04°46'29"	21°10'56"
26+39.09	14.09'	13.65'	14.54'	00°30'17"	04°58'51"	27+75.00	25.00'	20.81'	29.13'	04°46'29"	25°57'25"
					Def/Ft = 2.14859 Min.	28+00.00	25.00'	20.81'	29.13'	04°46'29"	30°43'54"
						28+25.00	25.00'	20.81'	29.13'	04°46'29"	35°30'22"
						28+50.00	25.00'	20.81'	29.13'	04°46'29"	40°16'51"
						28+69.34	19.34'	16.11'	22.55'	03°41'37"	43°58'29"
										Def/Ft = 11.45916 Min.	

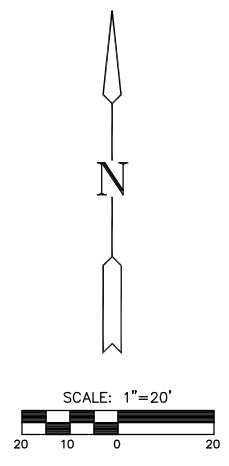
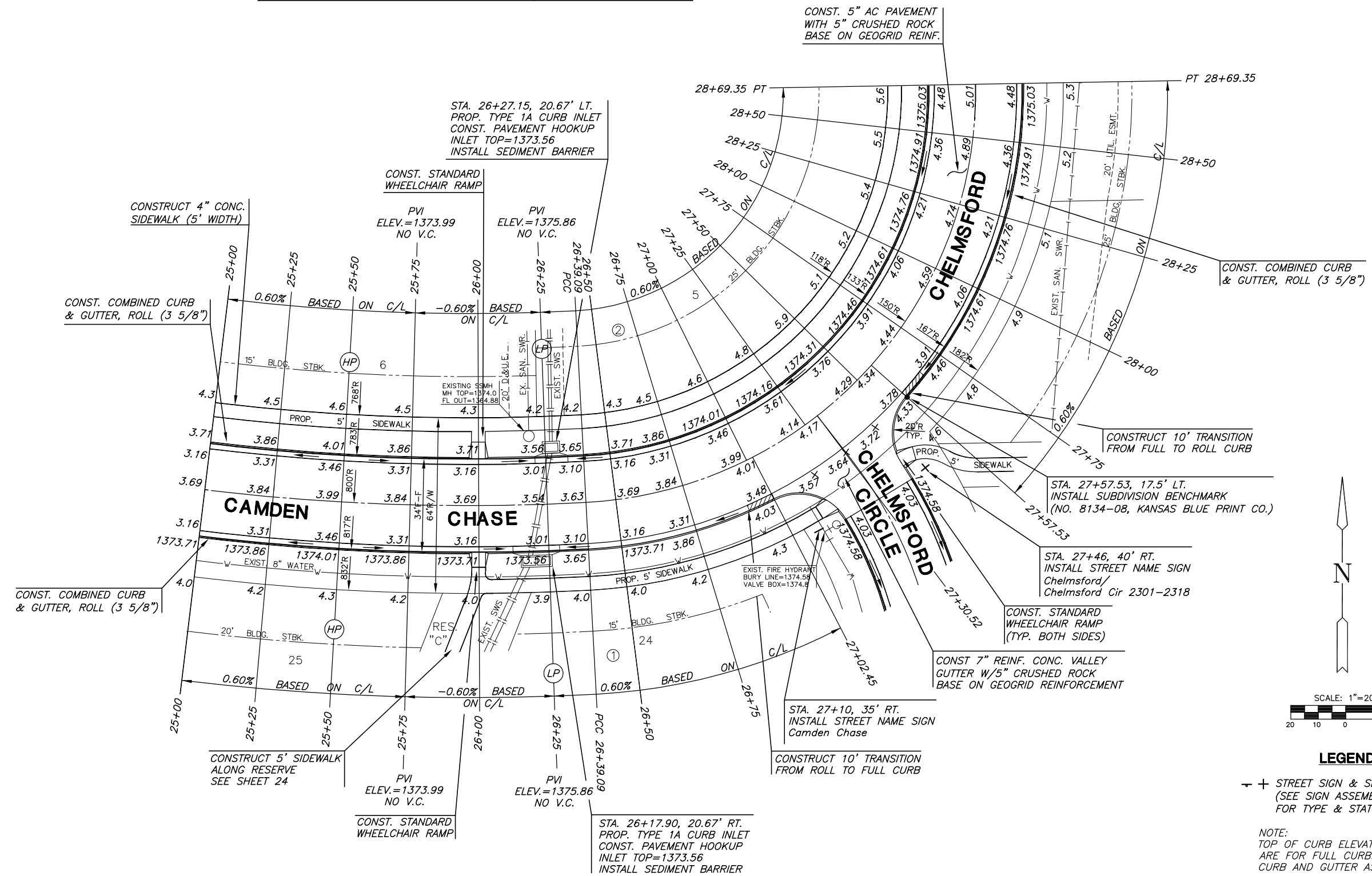

**LEGEND**

— + — STREET SIGN & SIGN LOCATION (SEE SIGN ASSEMBLY TABLE FOR TYPE & STATION OF SIGN)

NOTE:  
TOP OF CURB ELEVATIONS SHOWN ARE FOR FULL CURB. CONSTRUCT CURB AND GUTTER AS NOTED.

**CAMDEN CHASE /CHELMSFORD**  
SHEET TITLE  
472-84505  
PROJECT NUMBER

DFL  
DESIGN BY  
KKL  
DRAWN BY  
GJA  
CHECKED BY

ISSUED  
April 2007  
REVISED

SHEET NO.  
17 of 55