

WICHITA WATER DEPT.

BUTTERFLY

13327

Map Page No. I-15

VALVE RECORD

Valve No. 13327Location 21st ST. & HILLSIDEMeasurement 45½' S. SPL 21st (W) or 62' S. SCL 21st & 15' E.ECL HILLSIDE - L.S.

Diagram

SEE VALVE CARD
No. 13325Name of valve PRATTSize of valve 36"

Left Turn _____

No. of Turns 110Date set 1 JULY 1970Work Order No. W-4510(HANDWHEEL)
LIMITORQUE OPER.

WICHITA WATER DEPT.

BLOW-OFF

13328

Map Page No. I-15

VALVE RECORD

Valve No. 13328Location 21st ST. & HILLSIDEMeasurement 48½' S. SPL 21st (W) or 65' S. SCL 21st &15' E. ECL HILLSIDE OF 3' S. OF VALVE # 13327.

Diagram

SEE VALVE CARD
No. 13325Name of valve KENNEDYSize of valve 4"

Left Turn _____

No. of Turns 12Date set 1 JULY 1970Work Order No. W-4510

HANDWHEEL

WICHITA WATER DEPT.

BUTTERFLY
13325

Map Page No. I-15

VALVE RECORD

Valve No. 13325

Location 21st ST. & HILLSIDE

Measurement 14' S. SPL ^{21st}(W) or 30' S. SCL 21st & 39' E. ECL

HILLSIDE - L.E.

Diagram

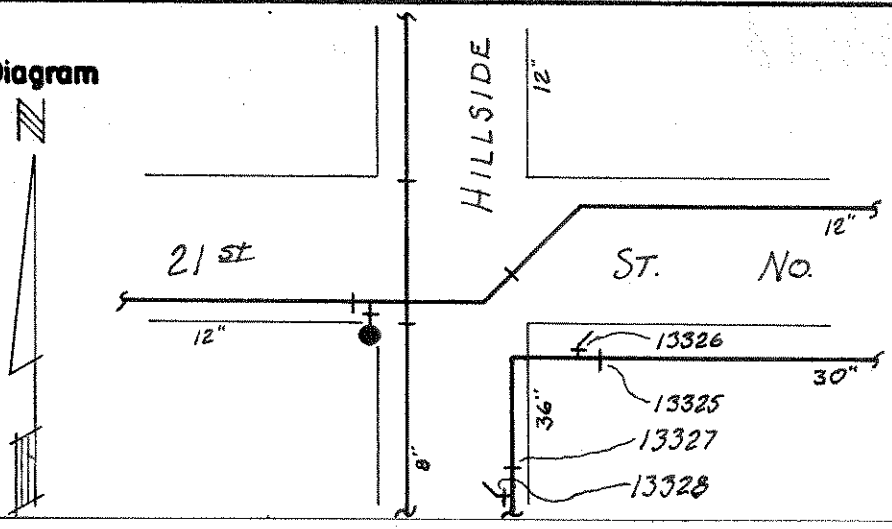

(HANDWHEEL)
LIMITORQUE OYER.

Name of valve PRATT

Size of valve 30"

Left Turn _____

No. of Turns 92

Date set 1 JULY 1970

Work Order No. W-4510

WICHITA WATER DEPT.

BLOW-OFF
13326

Map Page No. I-15

VALVE RECORD

Valve No. 13326

Location 21st ST. & HILLSIDE

Measurement 14' S. SPL 21st ST. (W) or 30' S. SCL 21st &

36' E. ECL HILLSIDE or 3' W. of VALVE # 13325

Diagram

SEE VALVE CARD
No. 13325

(FLG.-FLG.)
HANDWHEEL

Name of valve KENNEDY

Size of valve 4"

Left Turn _____

No. of Turns 12

Date set 1 JULY 1970

Work Order No. W-4510