

STA 5+21.21 LINE 1  
BL STA 10+50.50 5.00 LT.  
CONSTRUCT STANDARD  
TYPE P MH  
TOP ELEV. = 1344.23  
CONSTRUCT 6" STUB (N)

REMOVE APPROX 285 L.F. OF ABANDONED  
8" AC WATER. COORDINATE WITH WATER MAIN  
CONTRACTOR TO DISCONNECT EXISTING WATER  
LINE PRIOR TO SANITARY SEWER CONSTRUCTION.

\*\*STA 2+12.14 LINE 1  
BL STA 7+41.43 5.00 LT.  
CONSTRUCT STANDARD  
TYPE P MH

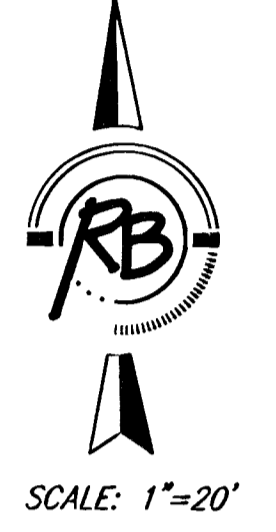

\*LINE 2 OF THE WATER PLANS MUST BE  
CONSTRUCTED PRIOR TO THE CONSTRUCTION  
OF THE SANITARY SEWER EXTENSION

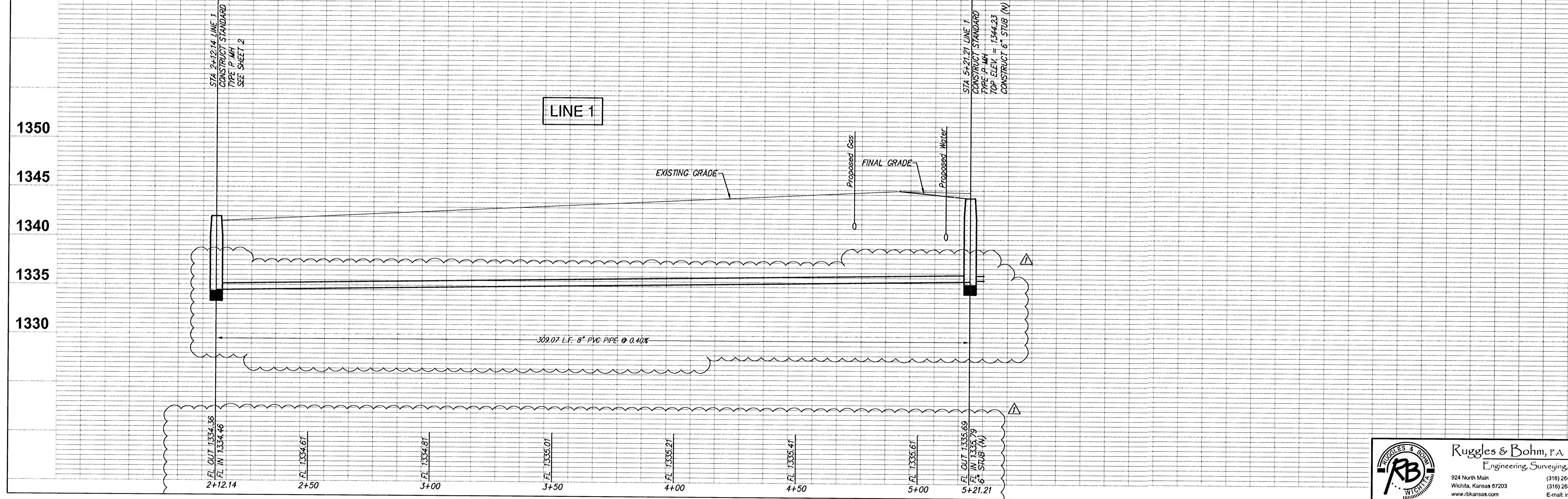

DESIGN	TCR	DATE	March 20, 2006
DRAWN	RLS	REVIEW	
PROJECT NUMBER	1647 PPW (607861)	DRAWING FILE	Base (SS)
<b>OLD CHICAGO BUILDING, KELLOGG &amp; ARMOUR SANITARY SEWER PLAN &amp; PROFILE WICHITA, KANSAS</b>			
<b>RUGGLES &amp; BOHM</b> Engineering, Surveying, Land Planning		924 North Main Wichita, Kansas 67203 www.rbkansas.com	
(316) 264-9008 (316) 264-4821 fax E-mail: info@rbkansas.com		RIB JOB 2804E SHEET 3 OF 4	