

Sheet 11-21-2006 2:32:22 PM by JMW
 0:20:03 (06601) (06601) - C-Grading Plan

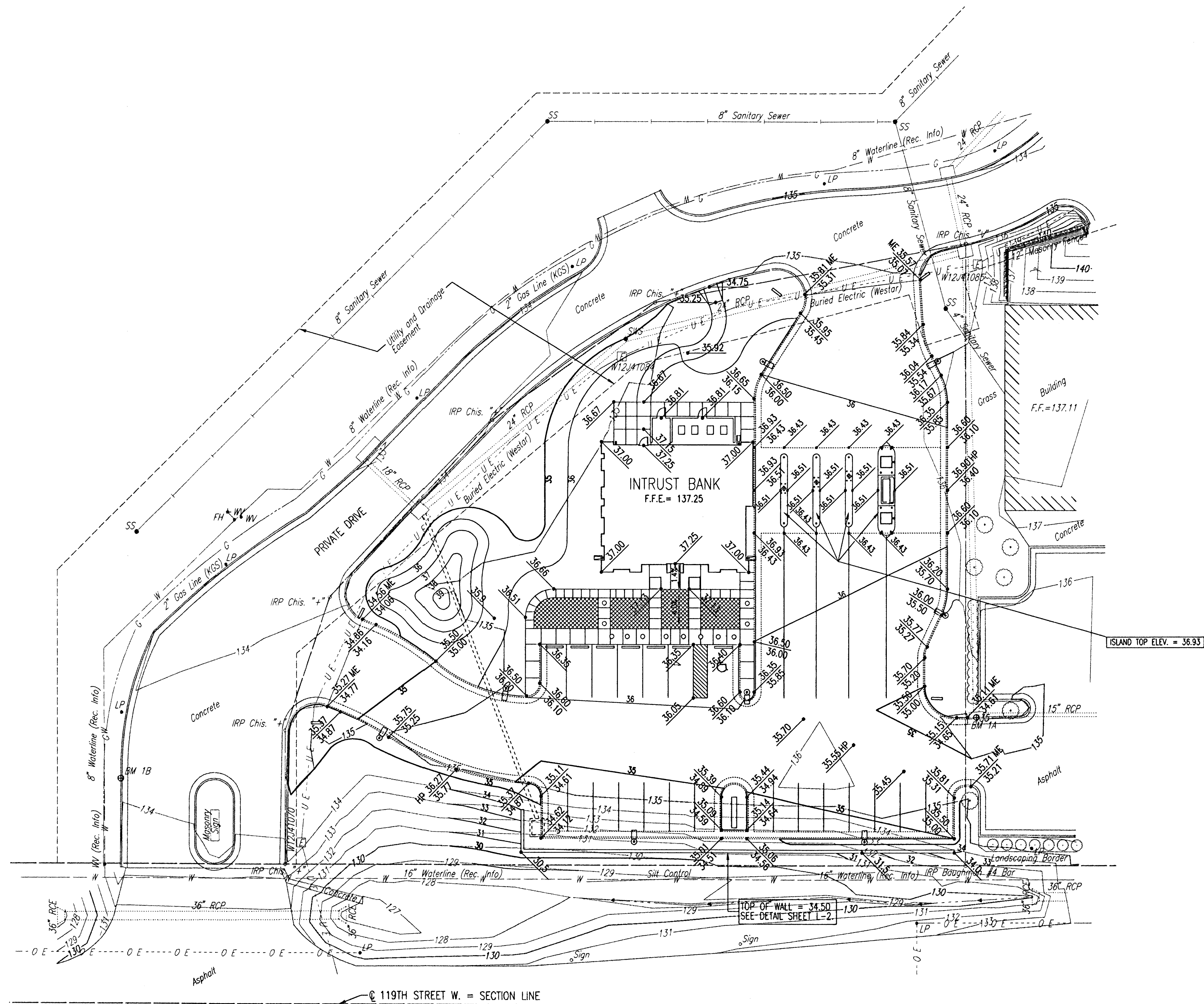

SCALE: 1" = 20'

LEGEND

- ↘ Denotes direction of Drainage
- Proposed Top of Curb Elevation
- Proposed Flowline of Curb Elevation
- Proposed Pavement Elevation
- Proposed Ground Elevation
- ME Match Existing Elevation
- HP High Point

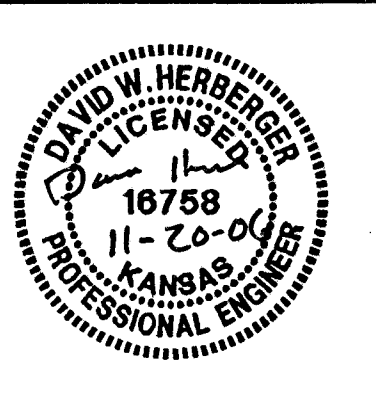
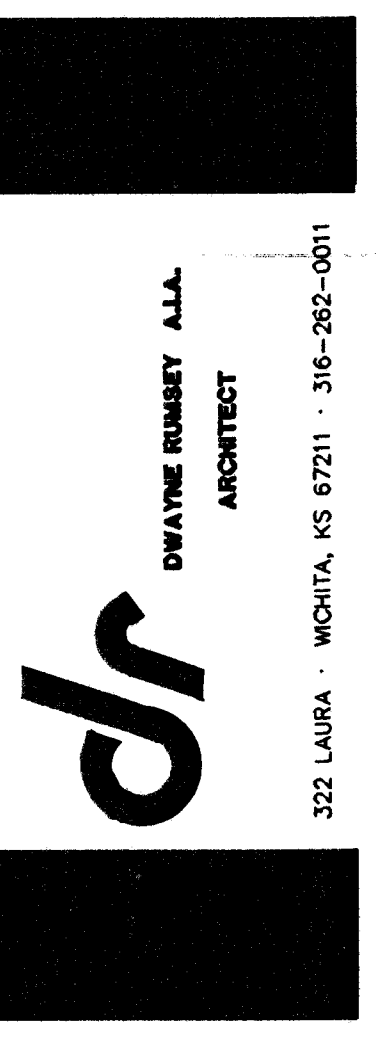

A NEW BRANCH BANK
INTRUST BANK
 WESTLAKE CENTER
 405 S. 119th STREET
 WICHITA, KANSAS

date: NOV. 20, 2006
 project: 2410

C-15
 OF SEVENTEEN

GRADING PLAN



Professional Engineering Consultants, P.A.
 303 S. TOPEKA WICHITA, KANSAS 67202 • 316-262-2691 • FAX 316-262-3003
 www.pcei.com