

Saved 11-21-2006 1:27:12 PM by JAW
 Plot Scale 1:20 11-21-2006 3:05:12 PM by JAW
 C:\2006\0601\0601-C-SWPP-Plan

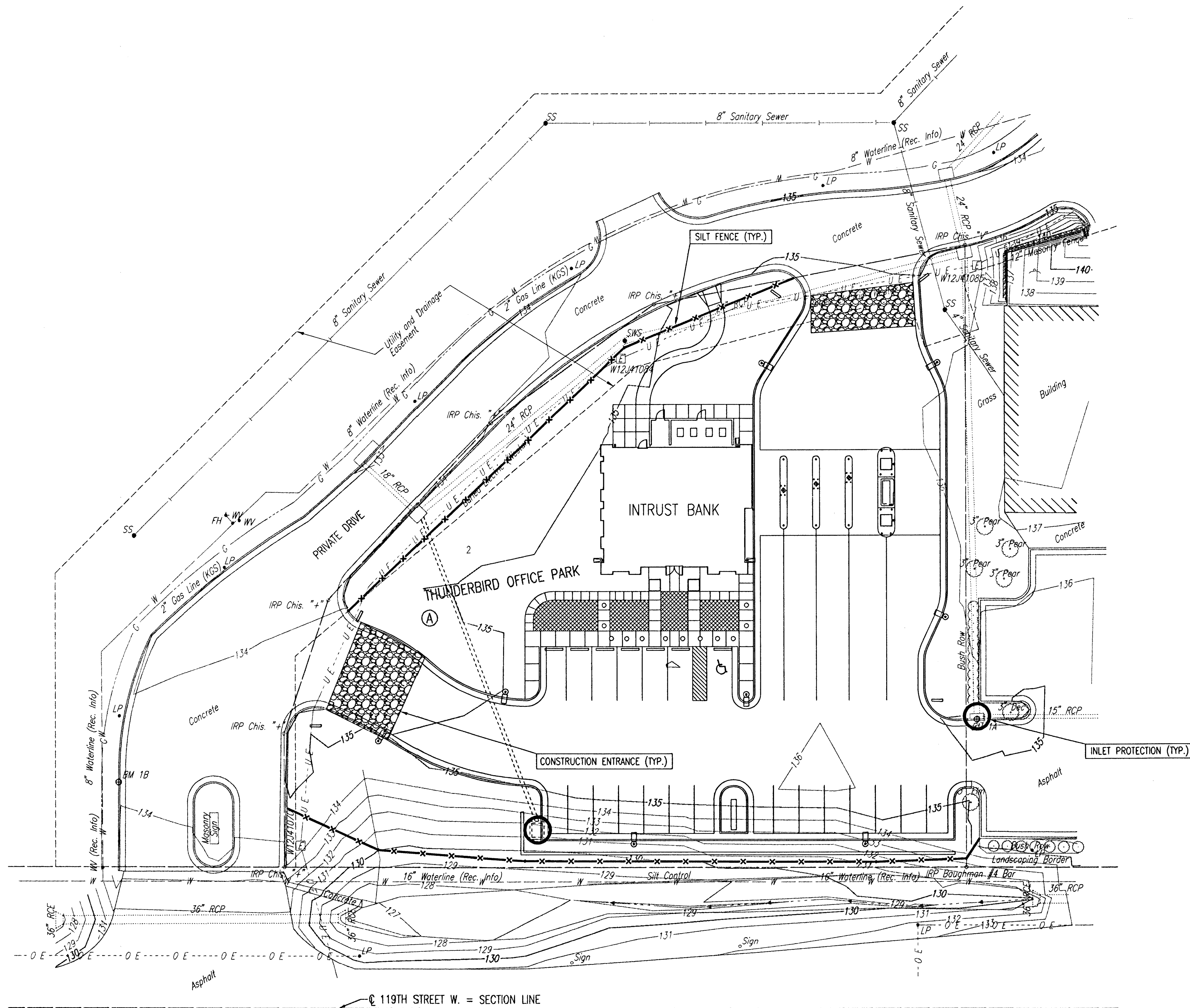

SCALE: 1" = 20'

GENERAL NOTES

1. THE EROSION CONTROL DEVICES SHOWN ON THIS SHEET ARE CONSIDERED MINIMUM STANDARDS. WHENEVER SEDIMENT ENTERS THE STREETS, STORM SEWERS, DITCHES, OR PONDS, CONTRACTOR WILL INSTALL ADDITIONAL DEVICES, AS NEEDED, TO CORRECT THE PROBLEM.
2. THE EROSION CONTROL DEVICES SHOWN HEREON MUST BE IN PLACE AT ALL TIMES DURING CONSTRUCTION UNTIL SUCH TIME AS THE SITE IS REESTABLISHED WITH PAVING OR GRASS. TEMPORARY OR PERMANENT SEED AND MULCH WILL BE INSTALLED WHEN EARTHWORK ACTIVITIES CEASE IN AN AREA FOR 14 DAYS OR MORE.
3. ANY MUD INADVERTENTLY TRACKED ONTO ANY STREET WILL BE CLEANED UP BY THE CONTRACTOR, AT THE END OF EACH DAY'S WORK.
4. CONTRACTOR TO FURNISH A TRUCK WASH-OUT PIT TO BE PLACED AT A CONVENIENT AND OBVIOUS LOCATION THAT DOES NOT CONFLICT WITH CONSTRUCTION. CONTRACTOR SHALL CLEAN OUT AND BACKFILL PIT PRIOR TO FINAL INSPECTION.
5. THE STORM WATER POLLUTION PREVENTION PLAN IS CONSIDERED A DYNAMIC PLAN. THE CONTRACTOR MAY MAKE CHANGES AS NECESSARY TO MEET PERMIT REQUIREMENTS. ANY CHANGES OR DELETION SHALL BE RECORDED ON THIS SHEET AND KEPT ON SITE AT ALL TIMES.
6. REFERENCE C-3.1-3.4 FOR BMP DETAILS.

LEGEND

- INLET PROTECTION
- SILT FENCE
- CONSTRUCTION ENT.

dr
 DWAYNE RUMSEY, A.L.A.
 ARCHITECT
 322 LAURA · WICHITA, KS 67211 · 316-262-0011

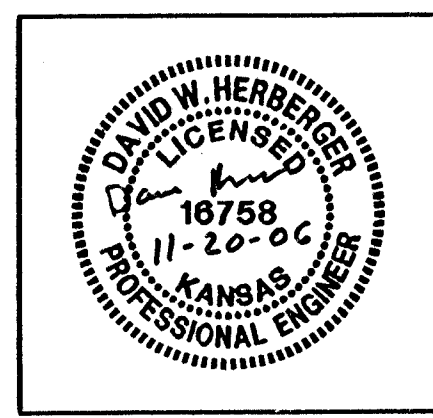
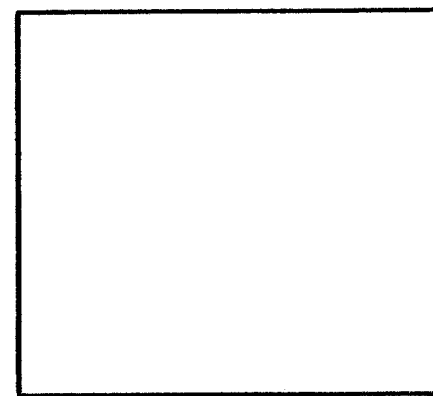

A NEW BRANCH BANK
INTRUST BANK
 WESTLAKE CENTER
 405 S. 119th STREET
 WICHITA, KANSAS

date: NOV. 20, 2006
 project: 2410

C-1.7
 OF
SEVENTEEN

Professional Engineering Consultants, P.A.
 303 S. GARDNER · WICHITA, KANSAS 67202 · 316-262-2491 · FAX 316-262-3003
 www.ped1.com

SWPP PLAN

14 05 13 SD