

PINE MEADOW 2ND ADDITION

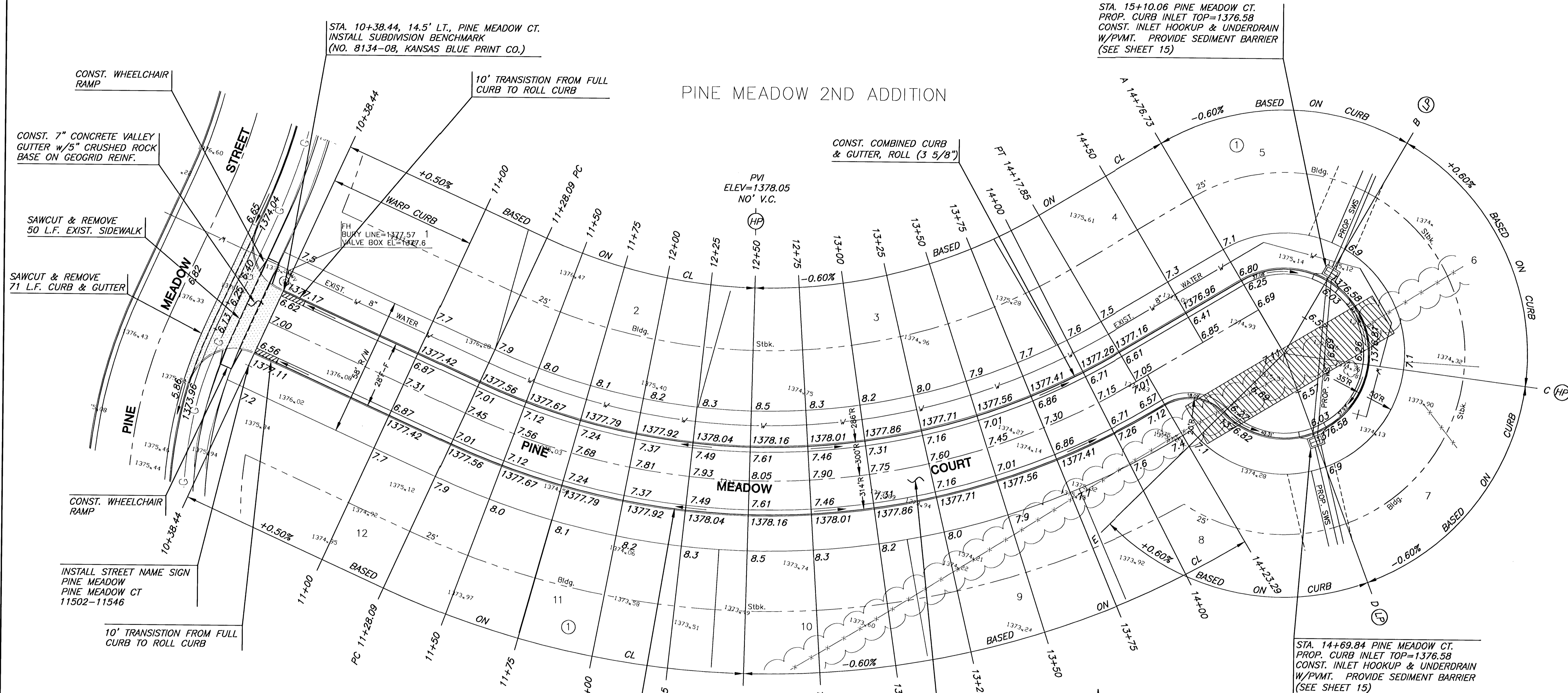

STA. 10+38.44, 14.5' LT., PINE MEADOW CT.
INSTALL SUBDIVISION BENCHMARK
(NO. 8134-08, KANSAS BLUE PRINT CO.)

STA. 15+10.06 PINE MEADOW CT.
PROP. CURB INLET TOP=1376.58
CONST. INLET HOOKUP & UNDERDRAIN
W/PVMT. PROVIDE SEDIMENT BARRIER
(SEE SHEET 15)

CONST. WHEELCHAIR RAMP

CONST. 7" CONCRETE VALLEY GUTTER W/5" CRUSHED ROCK BASE ON GEOGRID REINF.

SAWCUT & REMOVE 50 L.F. EXIST. SIDEWALK

SAWCUT & REMOVE 71 L.F. CURB & GUTTER

CONST. WHEELCHAIR RAMP

INSTALL STREET NAME SIGN
PINE MEADOW
PINE MEADOW CT
11502-11546

10' TRANSITION FROM FULL CURB TO ROLL CURB

CONST. COMBINED CURB & GUTTER, ROLL (3 5/8")

CONST 5" AC PAVEMENT W/5" CRUSHED ROCK BASE ON GEOGRID REINF.

STA. 14+69.84 PINE MEADOW CT.
PROP. CURB INLET TOP=1376.58
CONST. INLET HOOKUP & UNDERDRAIN
W/PVMT. PROVIDE SEDIMENT BARRIER
(SEE SHEET 15)

CURVE TABLE

$\Delta = 55^{\circ}20'20''$ $R = 300.00'$ $T = 157.30'$ $L = 289.75'$ $LC = 278.62'$

CURVE DATA BASED ON CENTERLINE $\Delta/2 = 27^{\circ}40'10''$

STATION	ARC	CHORD LENGTH		DEFLECTION	TOTAL DEFLECTION
		8' Off Ltcb	8' Off Rtcb		
11+28.09	4.03'	4.33'	3.73'	00°23'05"	00°23'05"
11+50.00	21.91'	23.51'	20.30'	02°05'32"	02°28'38"
11+75.00	20.90'	22.43'	19.36'	01°59'45"	04°51'52"
12+00.00	15.76'	16.91'	14.60'	01°30'18"	07°15'06"
12+25.00	25.00'	26.83'	23.16'	02°23'14"	09°38'21"
12+50.00	25.00'	26.83'	23.16'	02°23'14"	12°01'35"
12+75.00	25.00'	26.83'	23.16'	02°23'14"	14°24'49"
13+00.00	25.00'	26.83'	23.16'	02°23'14"	16°48'04"
13+25.00	25.00'	26.83'	23.16'	02°23'14"	19°11'18"
13+50.00	25.00'	26.83'	23.16'	02°23'14"	21°34'32"
13+75.00	25.00'	26.83'	23.16'	02°23'14"	23°57'47"
14+00.00	25.00'	26.83'	23.16'	02°23'14"	26°21'01"
14+17.84	17.84'	19.15'	16.53'	01°42'14"	28°03'15"

Def/Ft = 5.72958 Min.

PINE MEADOW 2ND ADDITION

CONST. COMBINED CURB & GUTTER, ROLL (3 5/8")

PVI
ELEV=1378.05
NO' V.C.

SUBDIVISION BENCH MARKS

NO.	STREET AND STATION	FROM CL	DESCRIPTION	ELEVATIONS
1	PINE MEADOW CT., STA. 10+38.44	14.5' LT	TOP OF CURB AT END OF NW RETURN, PINE MEADOW CT.	

NOTE: CONTRACTOR SHALL INSTALL SUBDIVISION BENCH MARKS ("FLAT SURVEY MARKERS NO. 8134-08 3" TOP DIAMETER" PROVIDED BY KANSAS BLUE PRINT CO., INC.) COSTS TO BE CONSIDERED SUBSIDIARY TO CONSTRUCTION OF COMBINED CURB AND GUTTER.

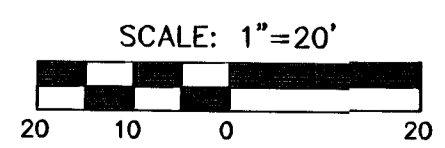
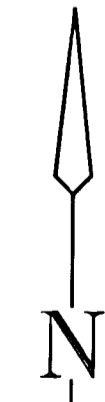

= TREE REMOVAL

H:\CIVIL\01077\DWG\PAV\2NDADD\PH2\01077_E1



PINE MEADOW SECOND ADDITION - PH 2
PROJECT NAME

PAVING PLANS
SHEET TITLE

DFL
DESIGN BY: DMU
DRAWN BY: GJA
CHECKED BY:

NOVEMBER 2003
DATE: 01077_E1
JOB NO. 7 / 20
SHEET OF