

BENCHMARK
 City of Wichita Benchmark.
 Centerline of Curtis extended.
 2' South of south property line
 of 1-235 R/W. 21' West of
 pole line extended south. 74'
 North Northwest of street light
 pole. 68' West of chain link
 fence corner.
 Elev. = 129.15 (City Datum)
 Elev. = 1316.55 (N.G.V.D.29)

Site Benchmark
 "□" North side 13th Street
 North, centerline face of inlet
 between Doris and Doris Ct.
 Elev. = 131.13

Scale: 1" = 20'
 • = Iron

NOTE:
 Plans show sporadic areas of concrete, asphalt
 pavement and gravel on site. When constructing
 the proposed street, the Contractor shall remove
 these items and store them on site. Only place
 that any of these materials shall be replaced are
 along the house and the bar, if there is
 damage. Removal and any replacement of
 concrete, asphalt pavement and gravel due to
 the construction of the streets shall be incidental
 to the bid item "Site Clearing and Restoration".

NOTE:
 Plans show trees that were existing at time of
 design. Developer has been removing trees on
 site. Therefore, the Contractor shall visit site
 and make own determination of tree removal
 needs. Some trees have been topped, but their
 trunks and roots are still in the ground.
 Removal of trees due to the construction of
 streets shall be incidental to the bid item "Site
 Clearing and Restoration".

NOTE:
 The following is a summary of the conditions of
 the existing utilities that are on the entire site.

Electrical: Almost all electrical is overhead and
 still active. Power is still being supplied to the
 Bar and the house east of the Bar. According
 to developer, all drops on the power poles have
 been disconnected and therefore any service lines
 should be moveable.

Gas: The gas has been disconnected at the
 main. All the interior service lines therefore
 should be abandoned. When excavating through
 a service line, some gas may escape due to
 being trapped in a bend.

Water: The water has been turned off, but not
 for sure if it has been disconnected from the
 main. Caution should be used when passing
 next to or through a water service line. Check
 with Engineer at time of construction to see if
 water has been disconnected.

SWR: At this time, no word on the status of
 the phone lines. Contractor to call Engineer.

Sanitary Sewer: There are two laterals that will
 need to be reconnected to Line 1 after it has
 been installed. These laterals are for the Bar
 and the house east of the Bar.

The above information is from the Developer. If
 the Contractor has any questions, please call the
 Design Engineer and we will help out.

Subdivision Bench Marks

Street & Station	Location Description	Elevation
Doris St. 0+65.19, 15.25' Rt.	Adjacent to Fire Hydrant near NW corner of Lot 6, Block C.	
Clara St. 4+16.43, 14.25' Rt.	Adjacent to Fire Hydrant near NE corner of Lot 3, Block C.	

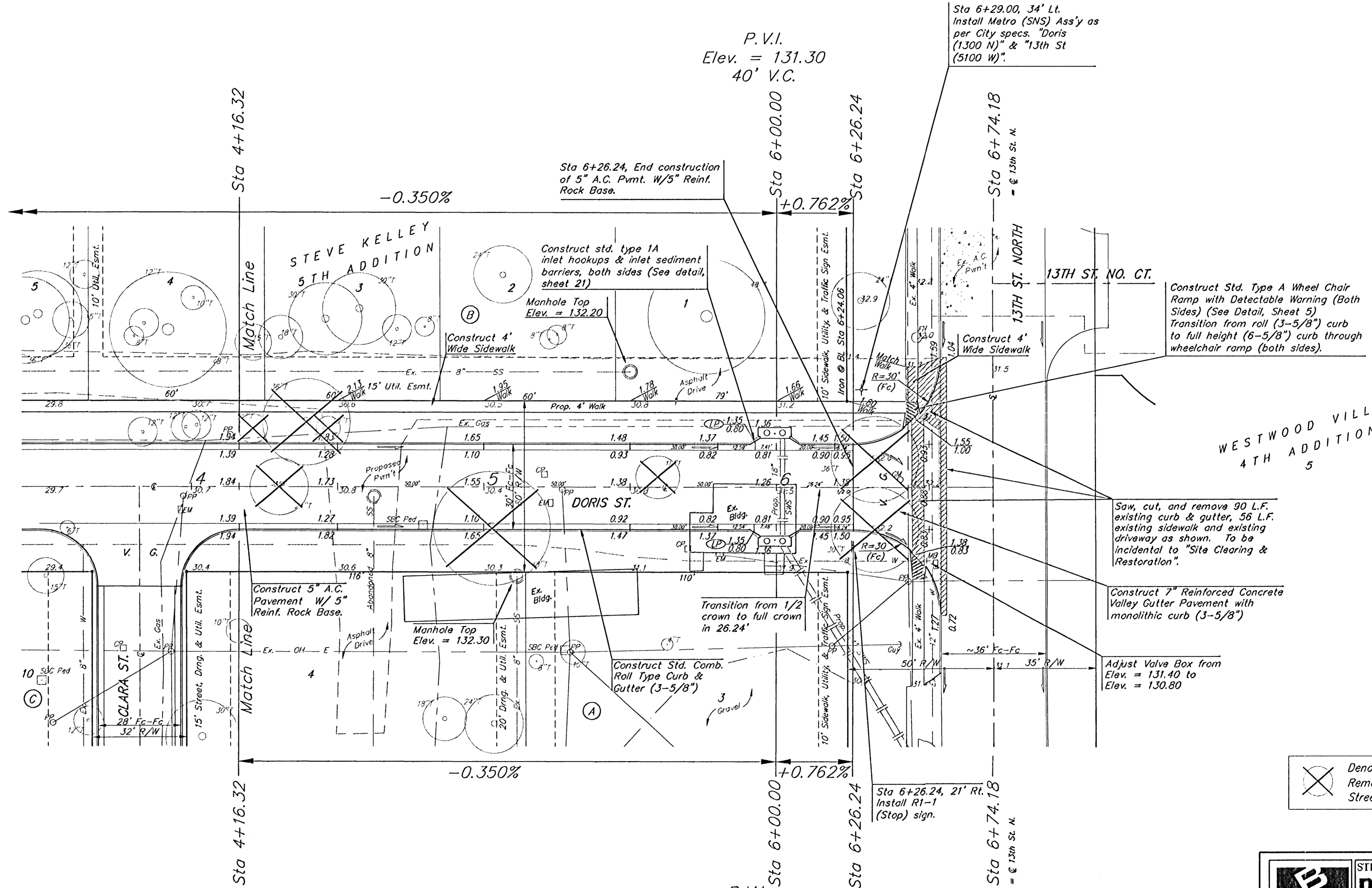

WESTWOOD VILLAGE
 4TH ADDITION
 5

Denotes Trees to be
 Removed by the
 Street Contractor

NOTE:
 ROLL TYPE CURB & GUTTER TO
 BE CONSTRUCTED ON THE
 PAVEMENT SHOWN ON THIS SHEET.
 TOP OF CURB ELEVATIONS ARE
 GIVEN FOR FULL HEIGHT CURB.

STEVE KELLEY 5TH ADDITION DORIS ST. STA 4+16.32 TO STA 6+74.18	
<small>Baughman Company, P.A. 315 E. St. Wichita, KS 67211 F316262-7271 F316262-0149 ENGINEERING SURVEYING PLANNING LANDSCAPE ARCHITECTURE</small>	
PROJECT NUMBER 412-83993	DESIGN MWS
REVISIONS	DRAWN DATE 06/04
SCALE Noted	
SHEET 7 OF 25	
<small>SteveKelley5th/5x2 04-05-E884</small>	