

LATERAL 8, MAIN 26 OF THE WAR INDUSTRIES SEWER IN THE CITY OF WICHITA, KANSAS

OCA NO. 744229
CITY OF WICHITA PROJECT NO. 468-84155
JAMES L. ARMOUR, P.E. - CITY ENGINEER

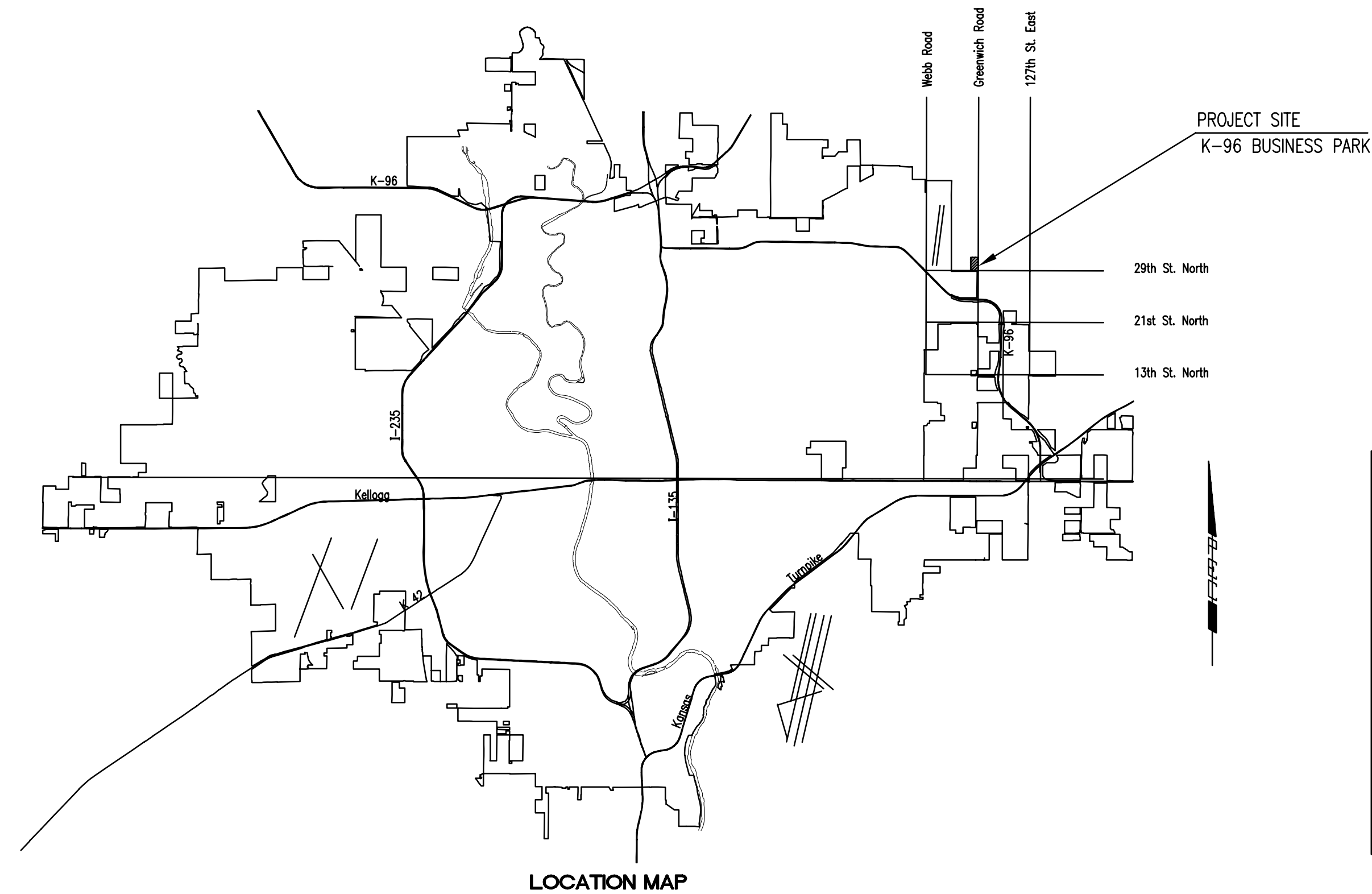

INDEX OF SHEETS

| | |
|----------------|------------------------------|
| SHEET NO. 1 | TITLE SHEET |
| SHEET NO. 2 | KEY MAP AND GENERAL NOTES |
| SHEET NO. 3 | PLAT AND PROJECT COORDINATES |
| SHEET NO. 4 | PLAN/PROFILE |
| SHEET NO. 5 | TYPE "P" MANHOLE DETAILS |
| SHEET NO. 6 | FRAME & COVER DETAILS |
| SHEET NO. 7 | RISER DETAILS |
| SHEET NO. 8-11 | SOIL EROSION BMP DETAILS |

CONSTRUCTION SCHEDULE/SEQUENCE

THE CONTRACTOR FOR EACH OF THE FOLLOWING K-96 BUSINESS PARK ADDITION PROJECTS SHALL COORDINATE THEIR EFFORTS WITH EACH OTHER SUCH THAT ANY NECESSARY SIMULTANEOUS CONSTRUCTION CAN PROCEED CONCURRENTLY WITHOUT CAUSING UNDUE DELAYS SO THAT ALL CONSTRUCTION CAN BE COMPLETED ON OR BEFORE THE DATES INDICATED.

SANITARY SEWER

THE CONTRACTOR SHALL COMPLETE THE K-96 BUSINESS PARK SANITARY SEWER CONSTRUCTION (PROJECT NO. 468-84155) BY JUNE 29, 2007.

WATERLINES

THE CONTRACTOR SHALL COMPLETE THE K-96 WATER SUPPLY LINE CONSTRUCTION (PROJECT NO. 448-90175) BY JULY 20, 2007.

APRIL 2007

PLANS PREPARED BY
PROFESSIONAL ENGINEERING CONSULTANTS, P.A.
ENGINEERS
WICHITA, KANSAS