

Benchmarks:
 BM #1: "□" Cut in Middle of Curb
 Inlet Top, North Curb of Conrey,
 Adjacent to SW Corner of Lot 14,
 Block A, Tyler's Landing 3rd Addition.
 Elev. = 150.29 (1337.69 M.S.L.)

BM #2: "□" Cut in Top of East Curb
 of High Point, 10' South of End of
 Return. Adjacent to Lot 1, Block D,
 Tyler's Landing Addition.
 Elev. = 155.28 (1342.68 M.S.L.)

Curve #6
 Curve Data Based on Centerline
 Rad. = 500' Delta = 20°16'55" Tangent = 89.43'
 Arc = 176.99' L.C. = 176.07' Def./Ft. = 3.43781 Min.

Station	Arc	Face Chord Lengths		Defl.	Total Defl.
		8' Left	8' Right		
-1+22.43	-	-	-	0°00'00"	0°00'00"
0+00.00	122.43'	128.23'	116.02'	7°00'53"	7°00'53"
0+25.00	25.00'	26.25'	23.75'	1°25'57"	8°26'50"
0+50.00	25.00'	26.25'	23.75'	1°25'57"	9°52'47"
0+54.56	4.56'	4.79'	4.33'	0°15'41"	10°08'28"

Curve #8
 Curve Data Based on Centerline
 Rad. = 88.09' Delta = 22°04'23" Tangent = 17.18'
 Arc = 33.94' L.C. = 33.73' Def./Ft. = 19.51066 Min.

Station	Arc	Face Chord Lengths		Defl.	Total Defl.
		8' Left	8' Right		
2+83.41	-	-	-	0°00'00"	0°00'00"
3+00.00	16.59'	21.26'	11.86'	5°23'41"	5°23'41"
3+17.35	17.35'	22.24'	12.40'	5°38'30"	11°02'11"

Scale: 1" = 20'
 • = Iron

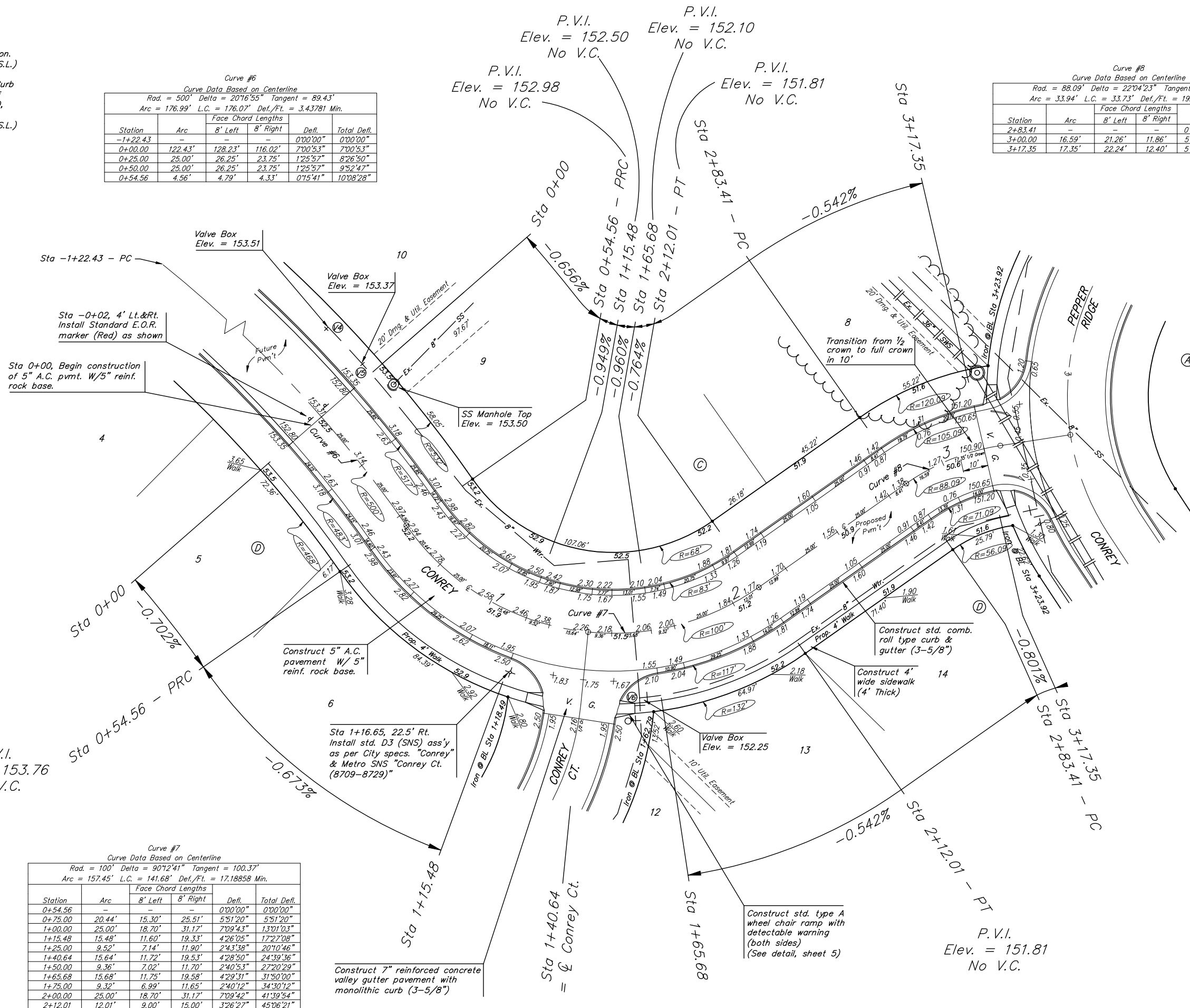

VALVE LOCATION TABLE

VALVE NUMBER	BASELINE STATION	OFFSET DISTANCE	OFFSET DIRECTION
V4	0-23.82	26'	Lt.
V5	0-04.81	26'	Lt.
V6	1+58.92	26'	Rt.

Paving contractor will be responsible to operate all water valves on the project, in the presence of the inspector, to ensure accessibility to the valves, and that all valves are left in the "ON" position when the project is completed.

NOTE: ROLL TYPE CURB & GUTTER TO BE CONSTRUCTED ON THE PAVEMENT SHOWN ON THIS SHEET. TOP OF CURB ELEVATIONS ARE GIVEN FOR FULL HEIGHT CURB.

Curve #7
 Curve Data Based on Centerline
 Rad. = 100' Delta = 90°12'41" Tangent = 100.37'
 Arc = 157.45' L.C. = 141.68' Def./Ft. = 17.18858 Min.

Station	Arc	Face Chord Lengths		Defl.	Total Defl.
		8' Left	8' Right		
0+54.56	-	-	-	0°00'00"	0°00'00"
0+75.00	20.44'	15.30'	25.51'	5°51'20"	5°51'20"
1+00.00	25.00'	18.70'	31.17'	7°09'43"	13°01'03"
1+15.48	15.48'	11.60'	19.33'	4°26'05"	17°27'08"
1+25.00	9.52'	7.14'	11.90'	2°43'38"	20°10'46"
1+40.64	15.64'	11.72'	19.53'	4°28'50"	24°39'36"
1+50.00	9.36'	7.02'	11.70'	2°40'53"	27°20'29"
1+65.68	15.68'	11.75'	19.58'	4°29'31"	31°50'00"
1+75.00	9.32'	6.99'	11.65'	2°40'12"	34°30'12"
2+00.00	25.00'	18.70'	31.17'	7°09'42"	41°39'54"
2+12.01	12.01'	9.00'	15.00'	3°26'27"	45°06'21"

Baughman Tyler's Landing 3rd Addition - Phase 2
Conrey
 STA 0+00 to STA 3+17.35

8 OF 22