

Benchmarks:
 BM #1: "□" Cut in Middle of Curb
 Inlet Top, North Curb of Conrey,
 Adjacent to SW Corner of Lot 14,
 Block A, Tyler's Landing 3rd Addition.
 Elev. = 150.29 (1337.69 M.S.L.)

BM #2: "□" Cut in Top of East Curb
 of High Point, 10' South of End of
 Return. Adjacent to Lot 1, Block D,
 Tyler's Landing Addition.
 Elev. = 155.28 (1342.68 M.S.L.)



Scale: 1" = 20'
 • = Iron

Subdivision Bench Marks

Street & Station	Location Description	Elevation
Pepper Ridge 4+07.12, 17.25' Lt.	Adjacent to Fire Hydrant Between Lots 3 and 4, Block C.	
Conrey Ct. 1+59.66, 14.25' Rt.	Adjacent to Fire Hydrant at SE End of NE Curb Return of Conrey and Conrey Ct.	
Pepper Ridge 4+95.90, 28.25' Lt.	Adjacent to Fire Hydrant at S. End of W. Curb Return of Pepper Ridge and 37th Street N.	

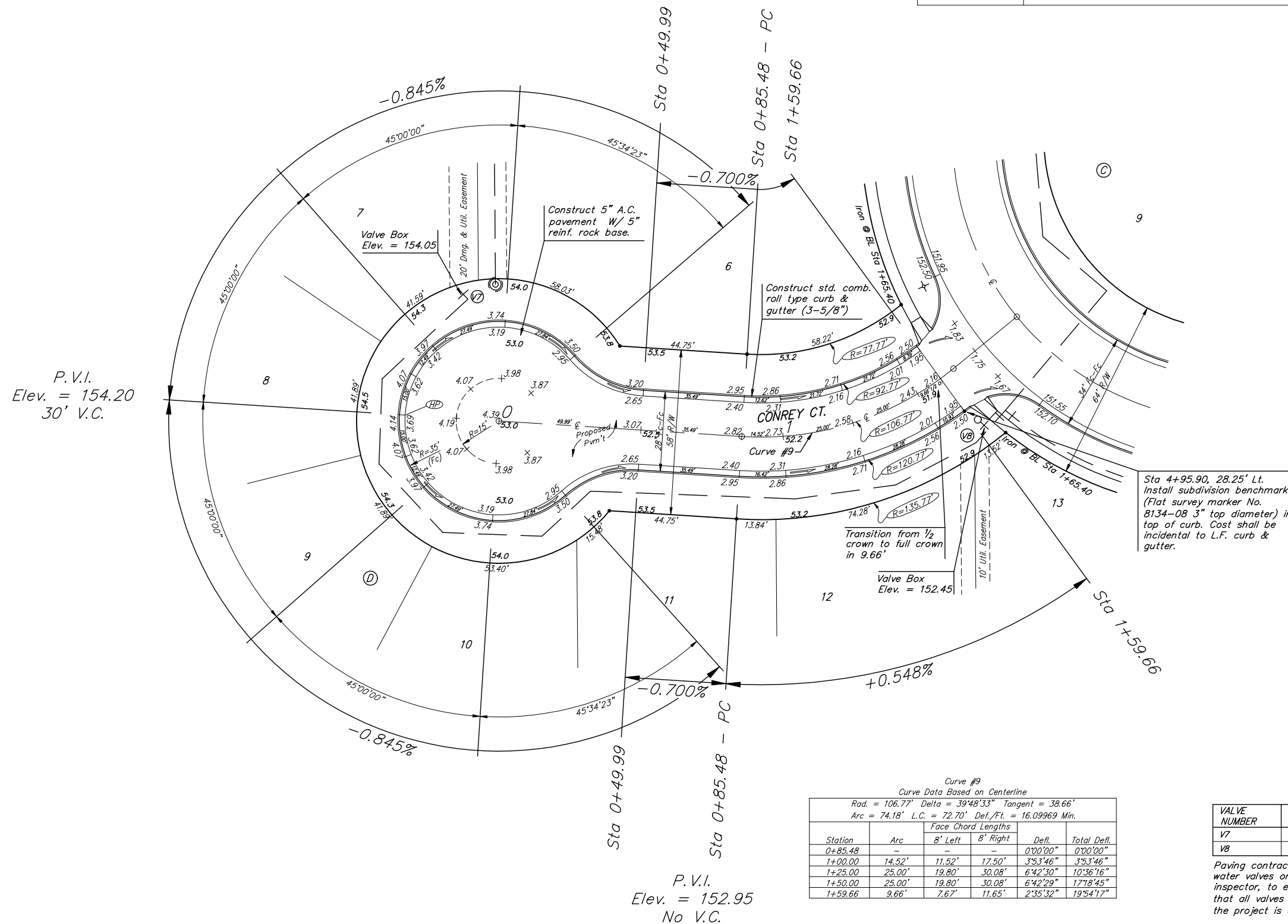

NOTE: ROLL TYPE CURB & GUTTER TO BE CONSTRUCTED ON THE PAVEMENT SHOWN ON THIS SHEET. TOP OF CURB ELEVATIONS ARE GIVEN FOR FULL HEIGHT CURB.

Baughman Tyler's Landing 3rd Addition - Phase 2
Conrey Ct.
 Sta 0+00 to 1+59.66

PROJECT NUMBER: 472-84263
 DESIGN: RDM/ABG
 DRAWN: RDM

APPROVED: AEG
 DATE: 4-25-07

SCALE: Noted
 SHEET: 9 OF 22

Tyler's Landing 3rd Phase 2\STR1.dwg 06-01-B454

Paving contractor will be responsible to operate all water valves on the project, in the presence of the inspector, to ensure accessibility to the valves, and that all valves are left in the "ON" position when the project is completed.