

37TH ST. N.

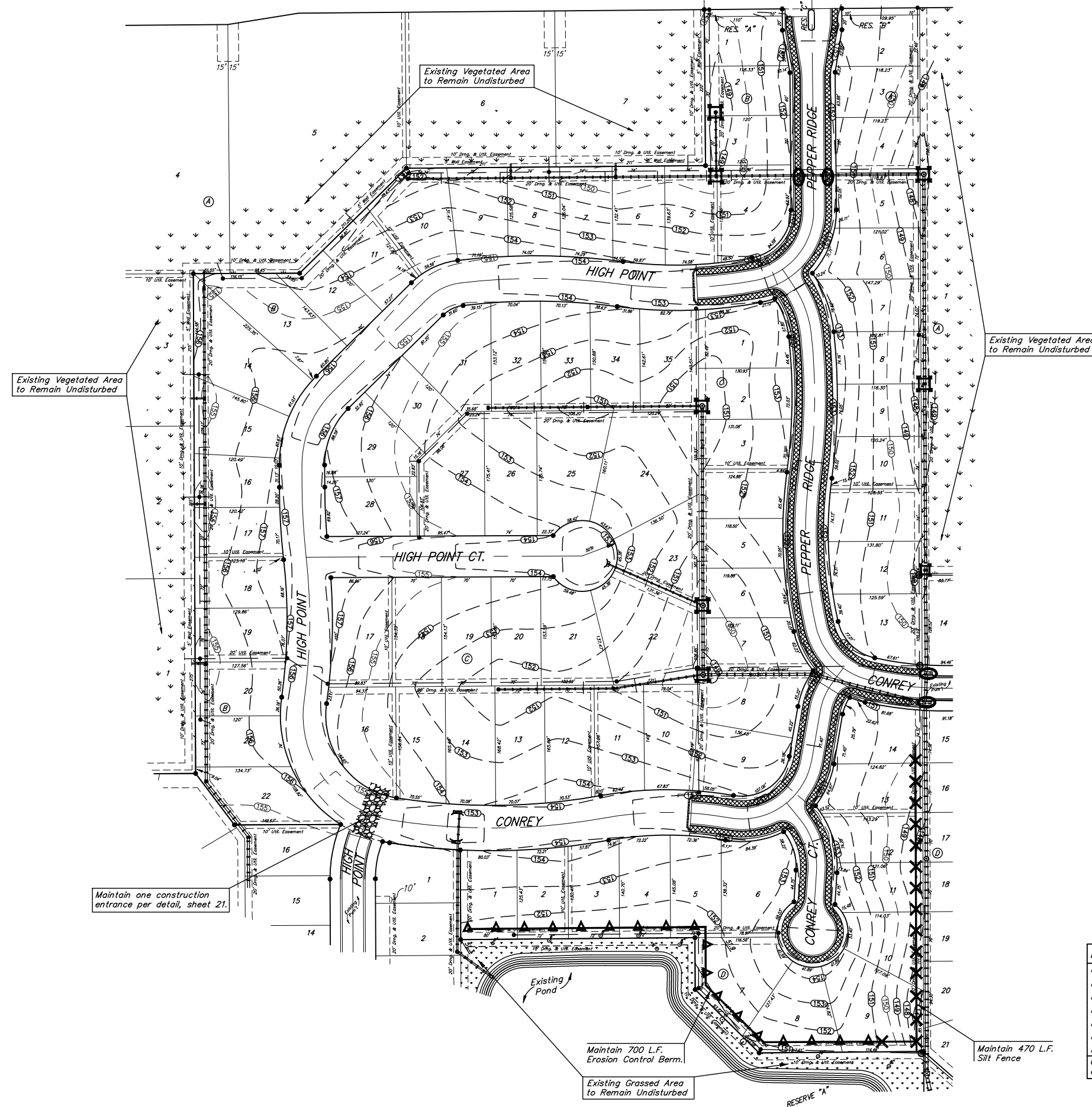

Scale: 1" = 80'



**EROSION CONTROL PLAN LEGEND**  
(SEE SHEETS 13-16 FOR BMP DETAILS)

- MAINTAIN CONSTRUCTION ENTRANCE
- MAINTAIN DROP INLET PROTECTION
- INSTALL/MAINTAIN CURB INLET PROTECTION
- MAINTAIN SILT FENCE
- MAINTAIN EROSION CONTROL BERM
- INSTALL STRAW BALE BARRIER
- EXISTING SANITARY SEWER
- EXISTING STORM SEWER
- EXISTING WATER LINE
- INSTALL CURLEX EROSION CONTROL MAT
- EX. VEGETATED AREA
- EX. GRASSED AREA

EROSION CONTROL MEASURE	UNITS	QUANTITY
Maintain Drop Inlet Protection	Ea.	8
Install Curb Inlet Protection	Ea.	2
Maintain Drop Inlet Protection	Ea.	2
Maintain Silt Fence	L.F.	470
Maintain Erosion Control Berm	L.F.	700
Maintain Construction Entrance	Ea.	1
Install Curlex Erosion Control Mat	S.Y.	2990

Quantities are For Information Only! Contractor shall verify quantities per final bid quantity sheet.

**Baughman** Tyler's Landing 3rd Addition Phase 2  
**EROSION CONTROL PLAN**  
STREET PAVING IMPROVEMENTS

Baughman Company, P.A. 315 8th St. W. W. Minn. 55 0711 P 316-262-7771 F 316-262-0149  
ENGINEERING | SURVEYING | PLANNING | LANDSCAPE ARCHITECTURE

PROJECT NUMBER 472-84263	DESIGN RDM/ABG	DRAWN RDM
REVISIONS:	APPROVED ABG	DATE 4-25-07
	SCALE Noted	
	SHEET	<b>12 OF 22</b>

\\Tyler's Landing 3rd\Phase 2\STR\STR\_EC\_Plan.dwg 06-01-E454