

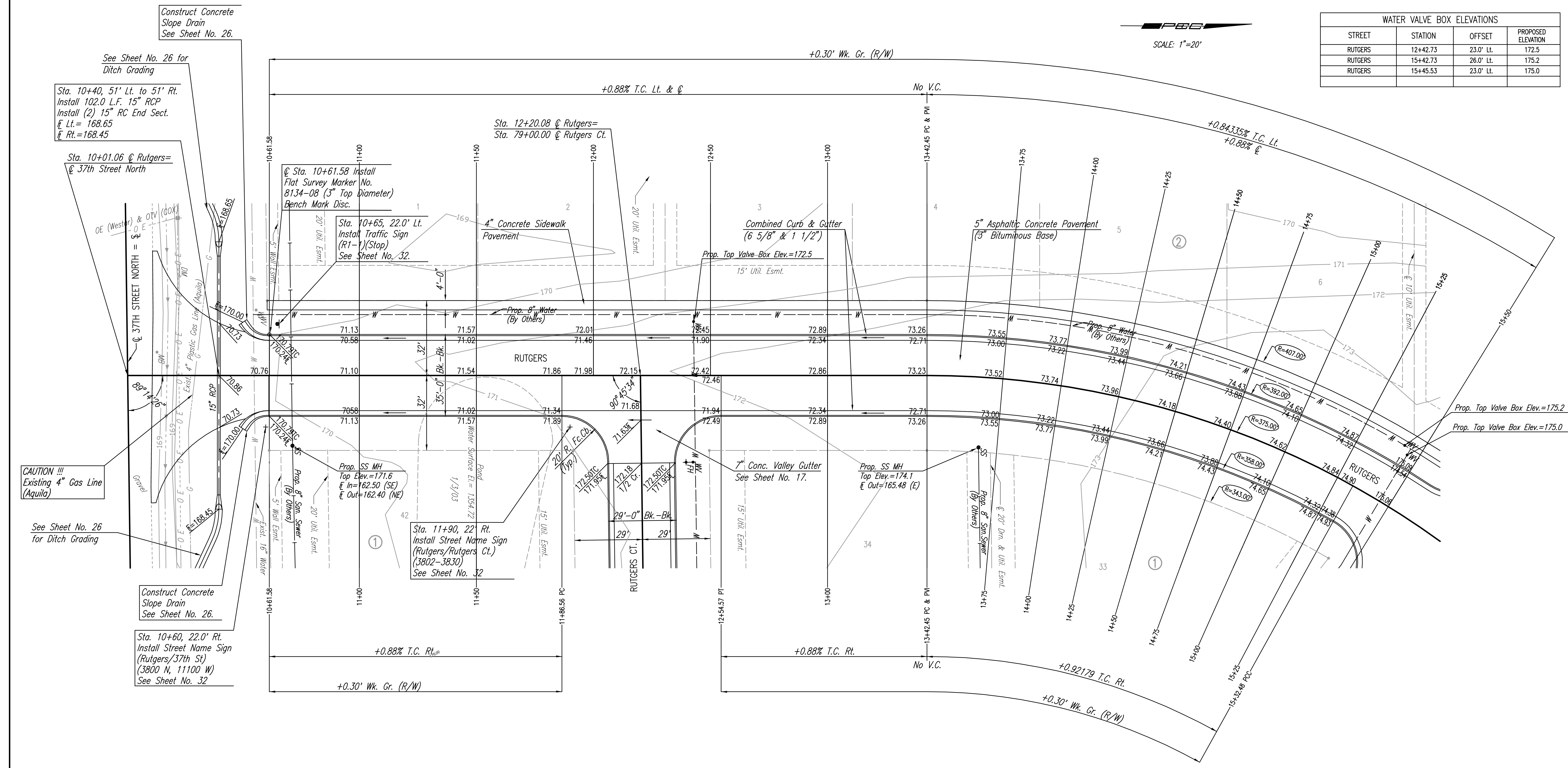

WATER VALVE BOX ELEVATIONS			
STREET	STATION	OFFSET	PROPOSED ELEVATION
RUTGERS	12+42.73	23.0' Lt.	172.5
RUTGERS	15+42.73	26.0' Lt.	175.2
RUTGERS	15+45.53	23.0' Lt.	175.0



SEE NEXT SHEET FOR @ CURVE DATA TABLE

Sowed 05-01-2007 6:00:10 PM by BEJ
 Plot Scale 1:20 05-02-2007 12:17:43 PM by BEJ
 J:\SENTOU\2006\06563\2007-05-01 to City\Street\DWG\09-STR-RUTGERS

No.	Revision	By	Date
PRAIRIE POINTE-PHASE 3 RUTGERS STA. 10+61.58 TO STA. 15+50.00 JAMES L. ARMOUR, P.E.-CITY ENGINEER CITY OF WICHITA PROJECT NO. 472-84043 Professional Engineering Consultants, P.A. 303 S. TOPEKA • WICHITA, KANSAS 67202 316-262-2691 • FAX 316-262-3003			
Designed by	BDB, BMM	Job No.	35-06563-000
Drawn by	BJS, TAT	Date	October 2006
			Sheet 9 of 56