

Benchmark:
 City of Wichita Benchmark Disc,
 Hydraulic and 55th Street South,
 42.00' North of Centerline, 40.70'
 West of Centerline, 3.70' North of
 centerline of Power Pole, 58.20'
 Northwest of Southeast Corner, Sec.
 21, Twp. 28-S, R-1-E.
 Elev. = 76.19 City Datum
 Elev. = 1263.59 (NGVD29)

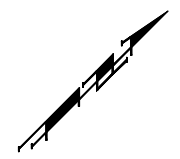

Scale: 1" = 20'
 • = Iron

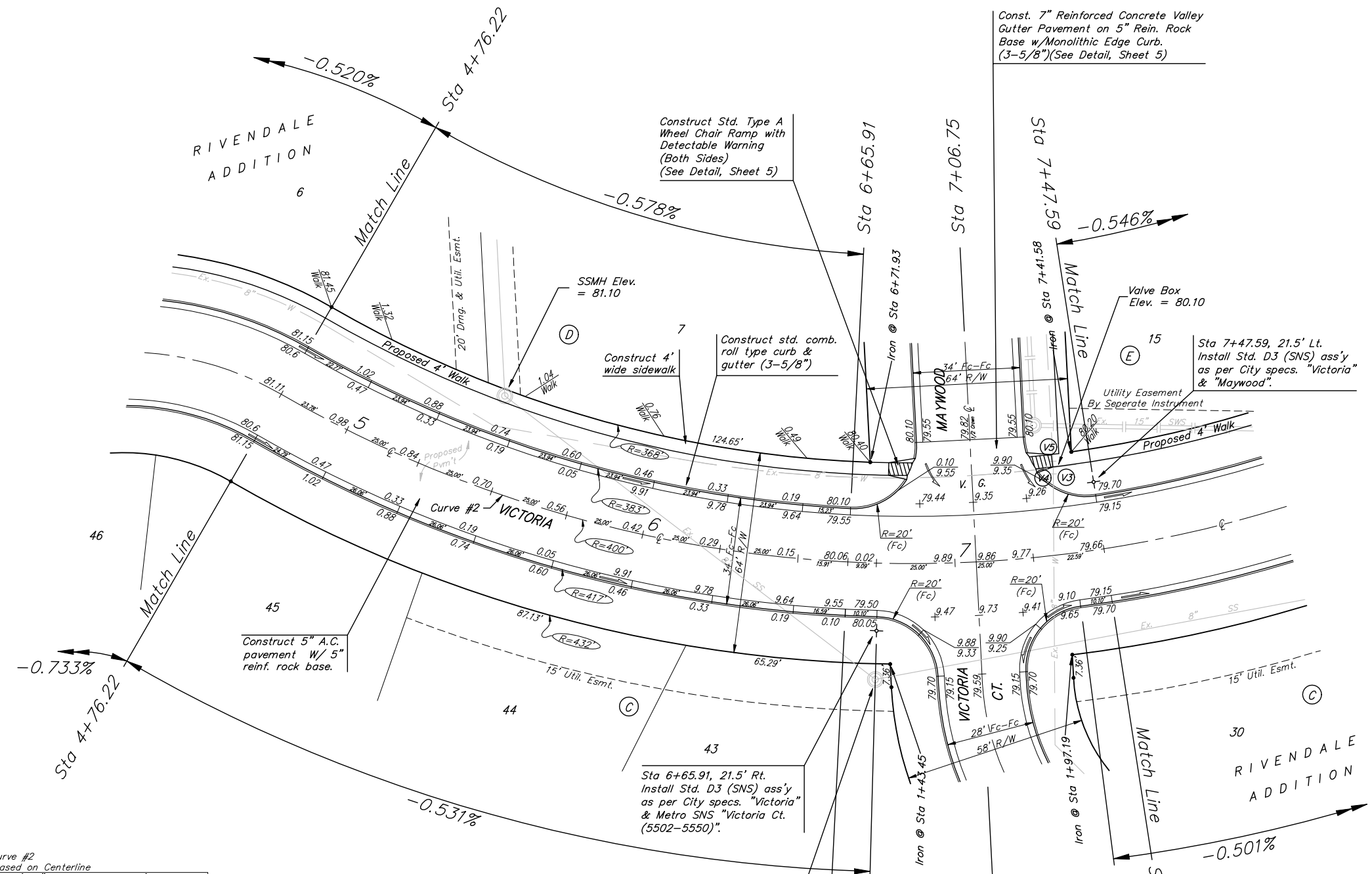

Curve #2
 Curve Data Based on Centerline
 Rad. = 400' Delta = 75°01'56" Tangent = 307.11'
 Arc = 523.82' L.C. = 487.19' Def/Ft. = 4.29721 Min.

Station	Arc	FACE CHORD LENGTHS		Defl.	T. Defl.
		8 Lt.	8 Rt.		
4+76.22	-	-	-	0'00"00"	0'00"00"
5+00.00	23.78'	22.29'	25.26'	1'42"11"	1'42"11"
5+25.00	25.00'	23.43'	26.56'	1'47"26"	3'29"37"
5+50.00	25.00'	23.43'	26.56'	1'47"26"	5'17"03"
5+75.00	25.00'	23.43'	26.56'	1'47"26"	7'04"29"
6+00.00	25.00'	23.43'	26.56'	1'47"25"	8'51"54"
6+25.00	25.00'	23.43'	26.56'	1'47"26"	10'39"20"
6+50.00	25.00'	23.43'	26.56'	1'47"26"	12'26"46"
6+65.91	15.91'	14.91'	16.90'	1'08"22"	13'35"08"
6+75.60	9.69'	9.08'	10.30'	0'41"58"	14'16"46"
7+00.00	24.40'	22.87'	25.92'	1'44"52"	16'01"58"
7+25.00	25.00'	23.43'	26.56'	1'47"25"	17'49"03"
7+50.00	25.00'	23.43'	26.56'	1'47"26"	19'36"29"
7+75.00	25.00'	23.43'	26.56'	1'47"26"	21'23"55"
8+00.00	25.00'	23.43'	26.56'	1'47"26"	23'11"21"
8+25.00	25.00'	23.43'	26.56'	1'47"26"	24'58"47"
8+50.00	25.00'	23.43'	26.56'	1'47"26"	26'46"13"
8+75.00	25.00'	23.43'	26.56'	1'47"25"	28'33"38"
9+00.00	25.00'	23.43'	26.56'	1'47"26"	30'21"04"
9+25.00	25.00'	23.43'	26.56'	1'47"26"	32'08"30"
9+50.00	25.00'	23.43'	26.56'	1'47"26"	33'55"56"
9+75.00	25.00'	23.43'	26.56'	1'47"26"	35'43"22"
10+00.04	25.04'	23.47'	26.60'	1'47"36"	37'30"58"

WATER VALVE LOCATION TABLE

VALVE NUMBER	BASELINE STATION	OFFSET DISTANCE	OFFSET DIRECTION
V3	7+34.71	26'	Lt.
V4	7+34.71	28'	Lt.
V5	7+34.71	30'	Lt.

Paving contractor will be responsible to operate all water valves on the project, in the presence of the inspector, to ensure accessibility to the valves, and that all valves are left in the "ON" position when the project is completed.

NOTE: ROLL TYPE CURB & GUTTER TO BE CONSTRUCTED ON THE PAVEMENT SHOWN ON THIS SHEET. TOP OF CURB ELEVATIONS ARE GIVEN FOR FULL HEIGHT CURB.

Baughman RIVENDALE ADDITION - PHASE 3
Victoria Street Paving
 ENGINEERING | SURVEYING | PLANNING | LANDSCAPE ARCHITECTURE

Baughman Company, P.A. 315 8th St. Wichita, KS 67211 P 3162627771 F 3162624149

PROJECT NUMBER 472-63868	DESIGN MWS	DRAWN RDM
REVISIONS	APPROVED MWS	DATE 5-4-07
	SCALE Noted	SHEET 7 OF 39

Rivendale Phase 3 STR1.dwg