

**BENCHMARKS:**

BM #1: "□" South end of Womer St. median approximately 565' south of 37th St. N.  
Elev. = 1324.11 NAVD88

BM #2: "□" Top of curb inlet, west side of Womer St. approximately 1,400' south of 37th St. N.  
Elev. = 1325.82 NAVD88

Baseline = CL 36th Cir. N/ 36th St. N.

Street & Station	Location Description	Elevation
36th St. N. 4+28.53, 14.25' Lt.	Adjacent to Fire Hydrant at E. End of SE Curb Return of Fairfax & 36th St. N.	

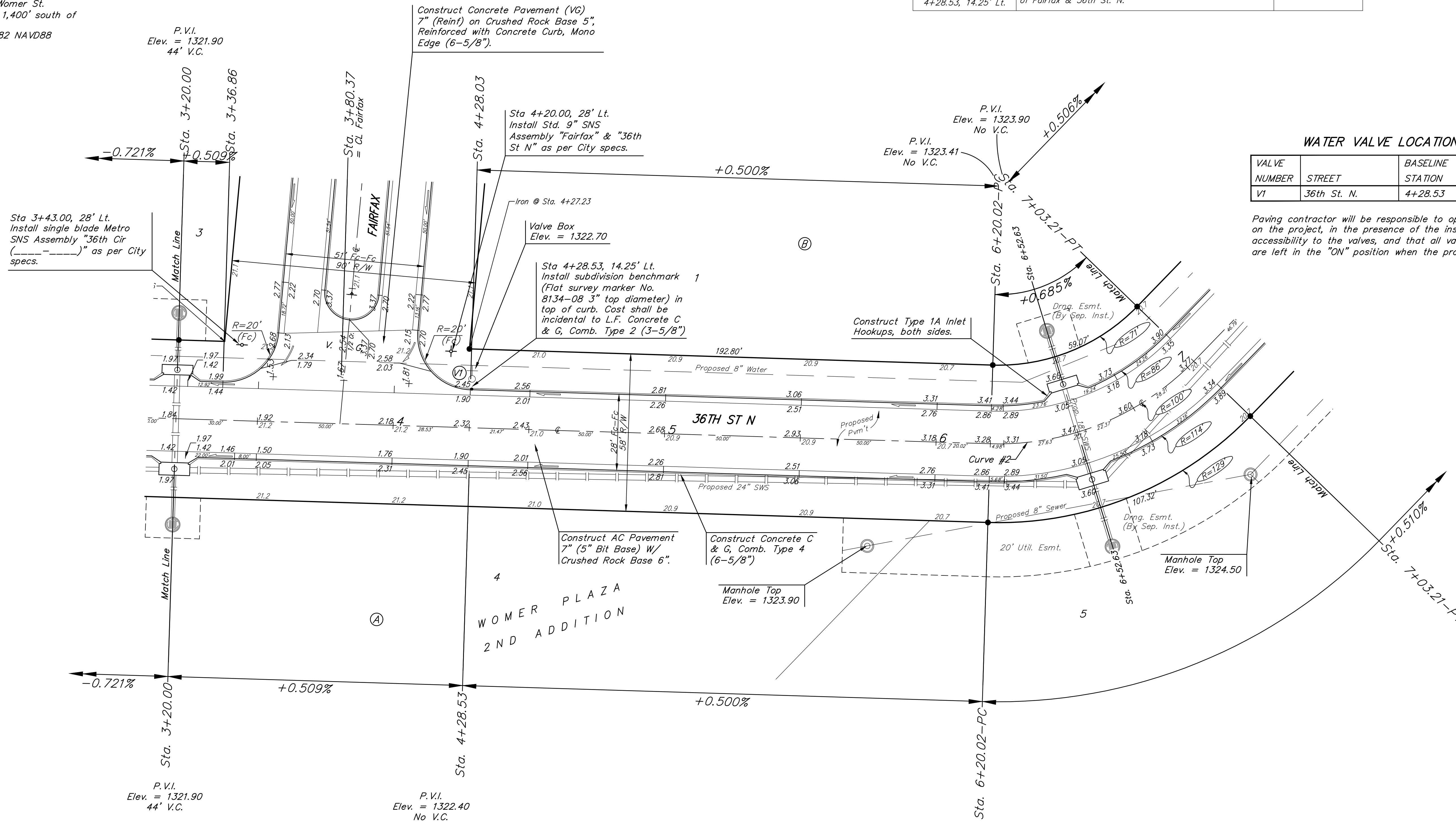
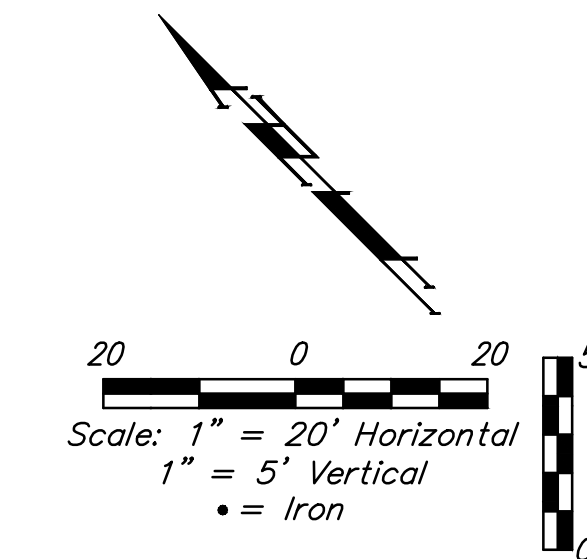

**WATER VALVE LOCATION TABLE**

VALVE NUMBER	STREET	BASELINE STATION	OFFSET DISTANCE	OFFSET DIRECTION
V1	36th St. N.	4+28.53	21'	Lt.

Paving contractor will be responsible to operate all water valves on the project, in the presence of the inspector, to ensure accessibility to the valves, and that all valves (except blowoffs) are left in the "ON" position when the project is completed.

Curve #2				
Curve Data Based on Centerline				
Rad. = 100' Delta = 47°39'58" Tangent = 44.17'				
Arc = 83.19' L.C. = 80.81' Def./Ft. = 17.18937 Min.				
Station	Arc	Face Chord Lengths		Total Defl.
		8' Left	8' Right	
6+20.02	-	-	-	0°00'00"
6+25.00	4.98'	3.88'	6.08'	1°25'36"
6+50.00	25.00'	19.45'	30.42'	7°09'44"
6+75.00	25.00'	19.45'	30.42'	15°45'04"
7+00.00	25.00'	19.45'	30.42'	22°54'48"
7+03.21	3.21'	2.50'	3.92'	23°49'59"

**Baughman Company, P.A.**  
 REGISTERED PROFESSIONAL ENGINEERS  
 ENGINEERING LICENSE NO. 11553  
 ARCHITECTURE LICENSE NO. 20100  
 36TH ST N  
 STREET IMPROVEMENTS

WOMER PLAZA 2ND ADD.  
**36TH ST N**  
 STREET IMPROVEMENTS