

**BENCHMARKS:**  
 BM #1 - City of Wichita Benchmark  
 Disc, SE Corner of Clifton and 55th  
 Street South, Southwest corner of  
 RCBC, on top of hubguard at the  
 West end.  
 Elev. = 1263.91 NAVD88

BM #2 - "□" Cut on top of curb,  
 north side of Shoffner, adjacent to  
 SE corner of Lot 14 Block B,  
 Meadowlake Beach Addition,  
 Sedgwick County, Kansas.  
 Elev. = 1264.80 NAVD88

**WATER VALVE LOCATION TABLE**

VALVE NUMBER	STREET	BASELINE STATION	OFFSET DISTANCE	OFFSET DIRECTION
V7	Maywood	1+52.05	26'	Rt.
V8	Maywood	1+85.54	26'	Rt.

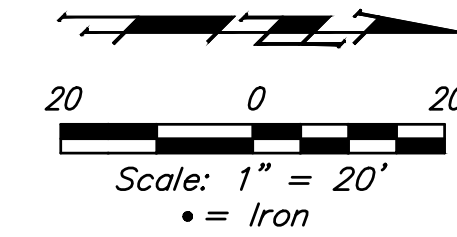

Paving contractor will be responsible to operate all water valves on the project, in the presence of the inspector, to ensure accessibility to the valves, and that all valves (except blowoffs) are left in the "ON" position when the project is completed.

Baseline = CL Maywood

All trees in public right-of-way, easements and lots in project benefit district shall be removed by contractor. To be paid for as lump sum bid item "Site Clearing"

All rubble and debris in public right-of-way, easements and lots in project benefit district shall be removed by contractor. To be paid for as lump sum bid item "Site Clearing"

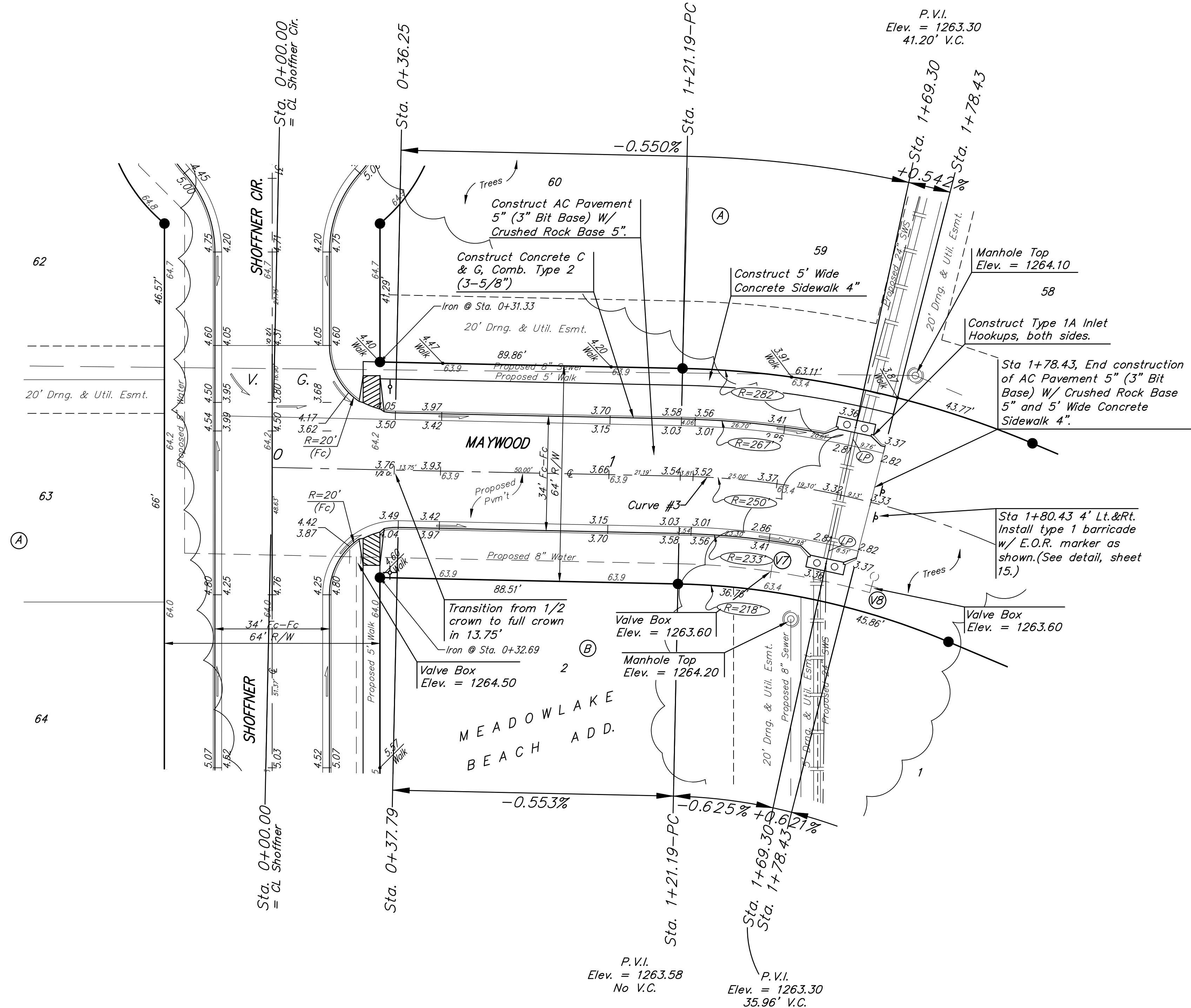

Curve #3					
Curve Data Based on Centerline					
Rad. = 250' Delta = 21°42'54" Tangent = 47.95'					
Arc = 94.75' L.C. = 94.18' Def./Ft. = 6.87546 Min.					
Face Chord Lengths					
Station	Arc	8' Left	8' Right	Defl.	Total Defl.
1+21.19	-	-	-	0°00'00"	0°00'00"
1+25.00	3.81'	4.19'	3.43'	0°26'12"	0°26'12"
1+50.00	25.00'	27.49'	22.49'	2°51'53"	3°18'05"
1+75.00	25.00'	27.49'	22.49'	2°51'53"	6°09'58"
1+78.43	3.43'	3.77'	3.09'	0°23'35"	6°33'33"
2+15.94	37.51'	41.22'	33.73'	4°17'54"	10°51'27"

NOTE: ROLL TYPE CURB & GUTTER (TYPE 2) TO BE CONSTRUCTED ON THE PAVEMENT SHOWN ON THIS SHEET. TOP OF CURB ELEVATIONS ARE GIVEN FOR FULL HEIGHT CURB (TYPE 4).

MEADOWLAKE BEACH ADD. - PH. 3A  
**MAYWOOD**  
 STREET IMPROVEMENTS  
 Baughman Company, P.A.  
 ENGINEERING, PLANNING, SURVEYING & ARCHITECTURE  
 1515 W. 17th St., Topeka, KS 66604  
 Phone: 785-233-8888 Fax: 785-233-8889  
 www.baughman.com  
 Date: 08/20/20