

GENERAL NOTES:

1. Contractor will be required to provide notice to utility companies a minimum of seventy-two (72) hours prior to any excavation, as follows:

Kansas One-Call 687-2470

The Contractor must notify the following in case of an emergency:

- Cox Communications 262-4270
- Kansas Gas Service 1-888-482-4950
- Westar Energy 383-8650
- Aquila Energy 1-800-303-0357
- ATT 268-2245
- City of Wichita Water Dept. 268-4563
- City of Wichita Sewer Maint. 268-4024
- City of Wichita Storm Sewer Maint. 268-4090
- City of Wichita Traffic Maint. 268-4034
- Conoco Phillips Pipeline Co. 1-877-267-2290
- Southern Star Pipeline Co. 529-6600
- Kinder-Morgan Pipeline Co. 1-888-844-3658

2. Utility service lines, poles, valve boxes, meters, and etcetera are to be adjusted as necessary by others prior to construction unless the plans specifically call for their adjustment by the Contractor or unless the plans specifically identify a utility to be adjusted by its owner during construction. Existing utilities and their location, as shown on the plans, represent the best information obtainable for design. The Contractor will be required to work around existing utilities within the right-of-way which do not conflict with proposed construction.

3. Rubble from the removal of miscellaneous structures and excess excavation which is to be wasted shall be disposed of on sites to be provided by the Contractor. These sites shall be approved by the Engineer as to suitability, appearance and site location. Locations, in the opinion of the Engineer, that will leave an unsightly appearance will not be approved. All disposal sites must be approved by the Kansas Department of Health and Environment. Material either stockpiled or disposed of in a flood plain would require a Kansas State Board of Agriculture permit. Any material dumped in waters of the United States or wetlands is subject to U.S. Corps of Engineers permitting regulations. Any material buried or stockpiled beyond approved construction limits would require additional archaeological investigations unless buried in a previously approved borrow location.

4. Trees and shrubs in public right-of-way which are in direct conflict with proposed new construction shall be removed by the Contractor ONLY with the Developer or Baughman Company approval. Trees and shrubs which are not in direct conflict with proposed new construction shall be saved and protected from damage.

5. The Contractor shall give all property owners and/or tenants of developed property abutting the construction of this project a minimum of ten (10) days notice prior to start of construction.

6. The Contractor shall be responsible for preserving property irons. The Contractor will be required to re-establish any property irons which are damaged or destroyed by his construction operations. Such irons shall be re-established by a licensed Land Surveyor in accordance with state laws.

7. All existing and proposed erosion control measures including silt fencing, erosion control mat, straw bales, inlet barriers, and const. entrance shall be maintained throughout construction by the Contractor until project is accepted by the City of Wichita. The on-site Engineer shall complete weekly reports on the status of erosion control measures. The Contractor shall be required to comply with maintenance and/or replacement of erosion control measures as determined by the on-site Engineer until project is accepted by City of Wichita.

8. A saw cut of at least one-half the depth of existing surface courses or one-fourth the depth of the existing total pavement thickness shall be provided at locations where proposed construction abuts the existing surface course or pavement for which partial removal of that surface or pavement is required. Sawed joint to facilitate removal within three (3) feet of existing joints will not be permitted and for such instances the limits of removal shall extend to the existing joint. Such saw cuts will not be paid for directly and this cost shall be considered as subsidiary to the removal of the surface or pavement.

9. All areas within Res. "B" and Res. "D" disturbed during construction shall be seeded as follows:

Seed -- Kansas Premium Fescue Blend; 8 lbs. PLS/1000 Sq. Ft.
Annual Rye grass; 3 lbs./1000 Sq. Ft.
Fertilizer -- 12-24-12 Ratio; 45 Lbs./Ac.
Mulch -- 2 Tons Prairie Hay/Ac.

All others areas disturbed during construction shall be seeded as follows:

Seed -- Rye grass (PLS) -- 5 Lbs./1,000 Sq Ft.

10. The Contractor shall adjust valve boxes as necessary to match proposed grade.

11. The Contractor shall drain any standing water in sump areas of the proposed pavement. Contractor shall overexcavate and recompact these areas as required to maintain compaction of 95% Standard Proctor Density. Costs to be included in the Excavation, Compacted Fill bid and/or Reinforced Rock Base bid items.

12. Limits of earthwork shall match existing ground elevations at the right-of-way line unless otherwise noted on the plans with a new finished grade elevation. When a new finished grade elevation is shown, the earthwork shall extend one foot beyond the right-of-way line and then slope up or down using permissible slopes to match the existing ground surface.

13. The Developer for this project is Jay Russell
P.O. Box 75450, Wichita, KS 67275
PH# (316) 722-2417 jay.russell@russellco.com

14. All excess excavation shall remain on-site and be spread or stockpiled at a location determined by the project engineer.

15. Sidewalk construction and project seeding shall be completed after the installation of Every trenching and conduit installation.

Street Paving for Bradford Street with Incidental Storm Water Sewer to serve

R.F. ADDITION - PHASE II

BRADFORD ST: From the West Line of Lot 12, Block B, East to the East Line of Lot 18, Block B

DALTON ST: From the North Line of Bradford St, North to the East Line of Capri St

CAPRI CT: From the Northeasterly Line of Capri St, East to and including the Cul-de-sac

CITY OF WICHITA, KANSAS

Gary Janzen, P.E. City Engineer

Project Number: 472-2019-085534 OCA Number: 810029

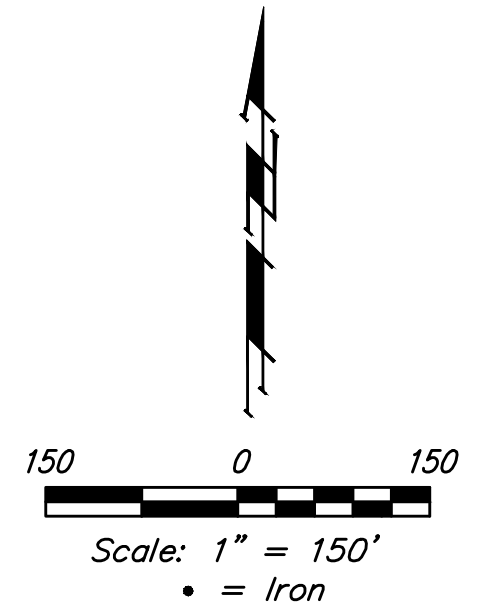

SHEET INDEX

Title Sheet	1
Asphalt Paving Detail	2
Wheelchair Ramp Details	3
Curb & Gutter Details	4
Sign Details	5
Drive Details	6
Bradford St.	7-8
Dalton St.	9-11
Capri Ct.	12
SWS Line 1	13
SWS Line 2	14
SWS Line 3	15
SWS Line 4	16
Erosion Control & Esmt. Grading Plan	17
Erosion Control BMP Details	18-22
Std. Type 1A Curb Inlet Detail	23
Backyard Inlet Detail	24
Frame and Cover Details	25
Drive Inlet Detail	26
Cross Sections	27-33
Coordinate Sheet	34-35
Copy of Plat	36

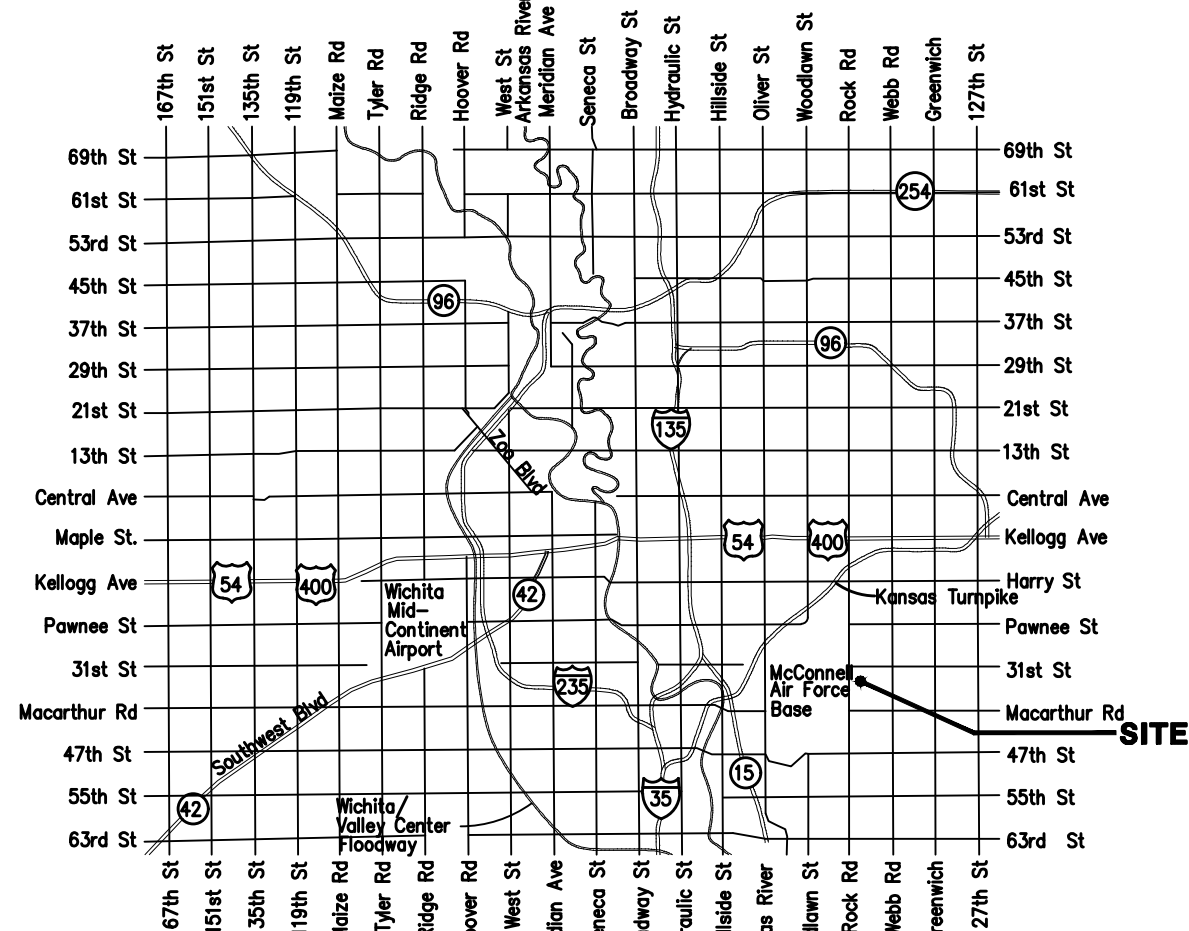
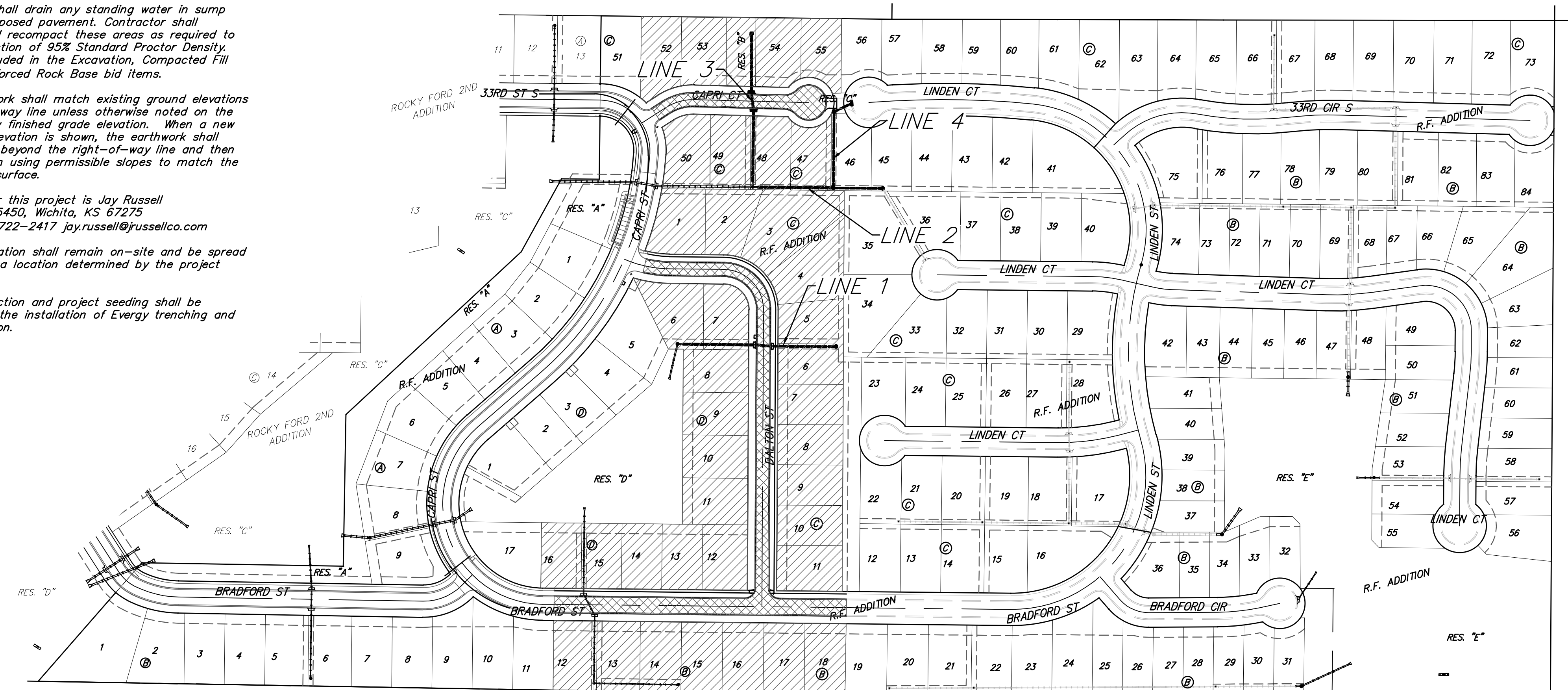

Project Earthwork Totals (CY unadjusted)	Excavation		
	Compacted Fill	Loose Fill	
Street (R/W)	965	17	656
Total Project Length	1,763 L.F. = 0.33 Miles		

BENCHMARKS

- #1: "□" CUT CHISELED ON CURB, 15.2' S. OF SW COR., LOT 6, BLOCK A, ROCKY FORD 2ND ADDITION. ELEV. = 1385.10 NAVD88
- #2: "□" CUT CHISELED ON CURB, 8.6' N. & 11.7' W. OF SW COR., LOT 14, BLOCK C, ROCKY FORD 2ND ADDITION. ELEV. = 1380.11 NAVD88



VICINITY MAP

BENEFIT DISTRICT



Proposed Streets:



Baughman Company, P.A. 315 Ellis St. Wichita, KS 67211 P 316-262-7271 F 316-262-0148
ENGINEERING | SURVEYING | PLANNING | LANDSCAPE ARCHITECTURE