

NORTHEAST FOOTBALL FIELDS REALIGNMENT IRRIGATION LAYOUT PLAN

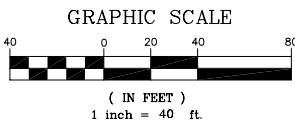
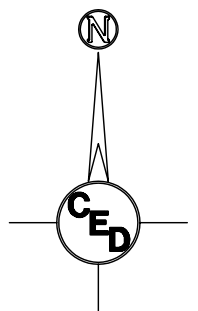

- LEGEND**
- G = GAS MAIN
 - W = WATER MAIN
 - SS = SANITARY SEWER
 - SWS = STORM WATER SEWER
 - UGE = UNDER GROUND ELECTRIC
 - UGT = UNDER GROUND TELEPHONE
 - FOT = BURRIED FIBER OPTIC TELEPHONE

- ⊙ B.M. BENCH MARK
- E.B. ELECTRIC BOX
- ← GUY ANCHOR
- G.R. GROUND ROD
- HIGH LINE POLE
- L.P. LIGHT POLE
- POST
- POWER POLE
- ⊓ SIGN
- SAV = 1/2" REBAR W/SAVOY CAP (SET)

Bench Mark: Square Cut on S. Curb Return E. Side Jewett Street @ Drive Entrance to Parking Lot on S. Side of Fees Street.
 Elevation = 1328.29 NGVD

Bench Mark #2: Square Cut on top of W. Curb line of Jewett Street across from Drive Entrance to Parking Lot on S. Side of Fees Street.
 Elevation = 1328.35 NGVD

CTL PT#1
 N 19743.574
 E 19698.116

CTL PT#2
 N 19333.862
 E 20362.772

- New Irrigation Legend**
- ⊓ = 2" Electric Valve
 - = 1" Quick Coupling Valve
 - = Sprinkler Head

All Irrigation pipe is Sch. 40 PVC.

- Materials to be Used:
- *Hunter I-25 Rotors
 - *Rainbird PGA Electric Valves
 - *Rainbird ESP 12-MC Controller

- ▨ - Proposed Playing Field Turf Area
- ▩ - Proposed Concrete Pavement (Driveway, Sidewalk and Curb & Gutter)

UTILITIES SHOWN REPRESENT THE BEST INFORMATION AVAILABLE FOR DESIGN. ADDITIONAL UTILITIES MAY BE PRESENT ON THIS PROJECT. THE CONTRACTOR SHALL BE RESPONSIBLE FOR DETERMINING THE EXACT LOCATION, DEPTH AND SIZE OF ALL UNDERGROUND UTILITIES PRIOR TO CONSTRUCTION. THE CONTRACTOR SHALL BE LIABLE FOR ANY DAMAGE CAUSED BY THE FAILURE TO DO SO.

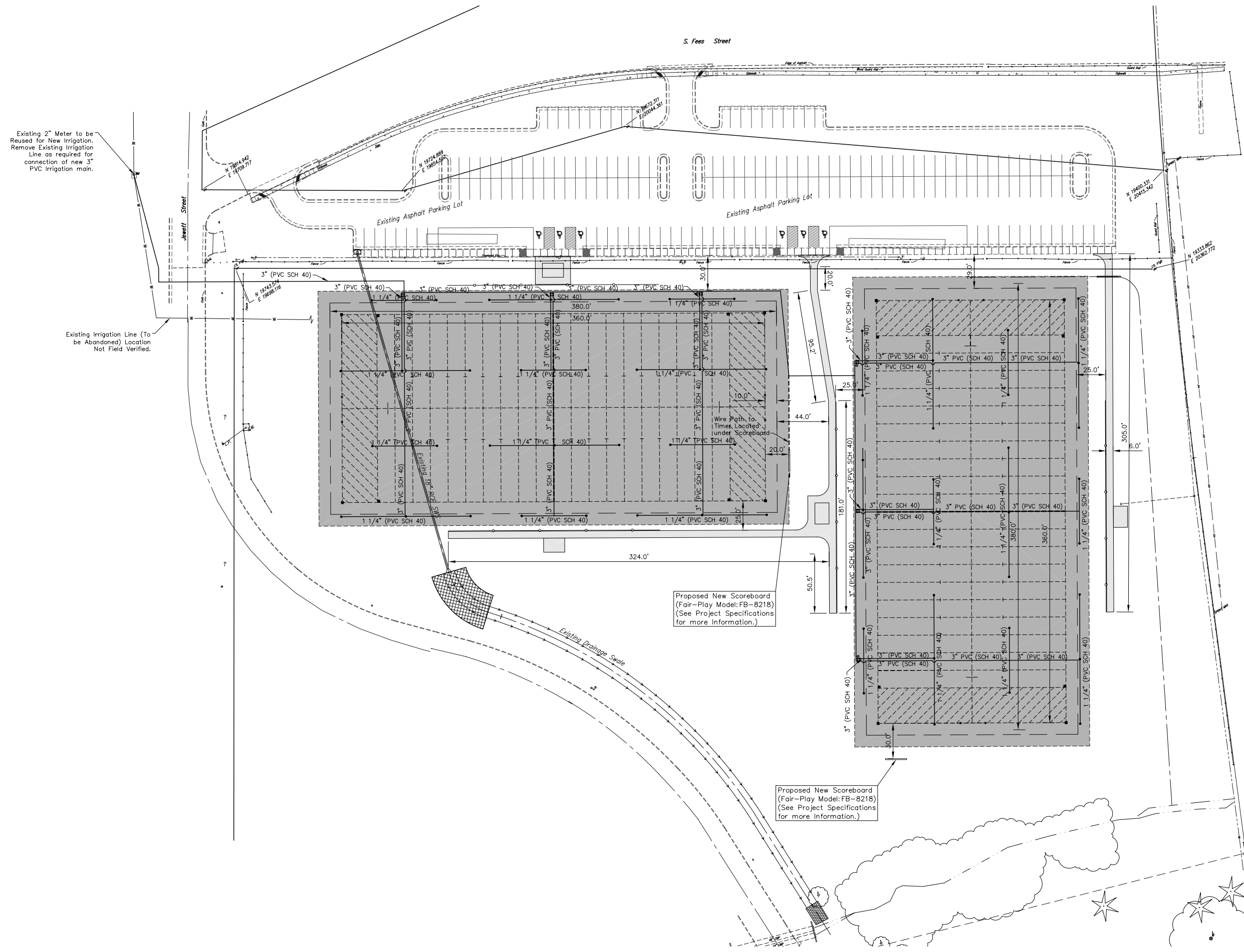

Existing 2" Meter to be Reused for New Irrigation. Remove Existing Irrigation Line as required for connection of new 3" PVC Irrigation main.

Existing Irrigation Line (To be Abandoned) Location Not Field Verified.

Proposed New Scoreboard (Fair-Play Model: FB-8218) (See Project Specifications for more information.)

Proposed New Scoreboard (Fair-Play Model: FB-8218) (See Project Specifications for more information.)

NORTHEAST FOOTBALL FIELDS
IRRIGATION LAYOUT PLAN
 PLANEVIEW PARK, WICHITA, KANSAS
 CED PROJ. NO.: 20051351
CERTIFIED ENGINEERING DESIGN, P.A.
 810 WEST DOUGLAS, SUITE C
 WICHITA, KANSAS 67203
 PH.(316)262-8808 FAX.(316)262-1669

DESIGNED: HDF	SCALE: 1"=40'	SHEET
DRAWN: CKW	DATE: 6/06	18
CHECKED: HDF	CED FILE: Planeview-Suppl	TOTAL 26