

Saved: 08-14-2020 3:51:23 PM by ROY THOMAS
 Plot Scale: 1:1 08-14-2020 3:58:27 PM by ROY THOMAS
 U:\Wichita-Civil\2018\180189\001\Main\Drawings\Minisa\180189-01-LS-01-Overall Landscape Plan

JEANETTE AVENUE

JEANETTE AVENUE

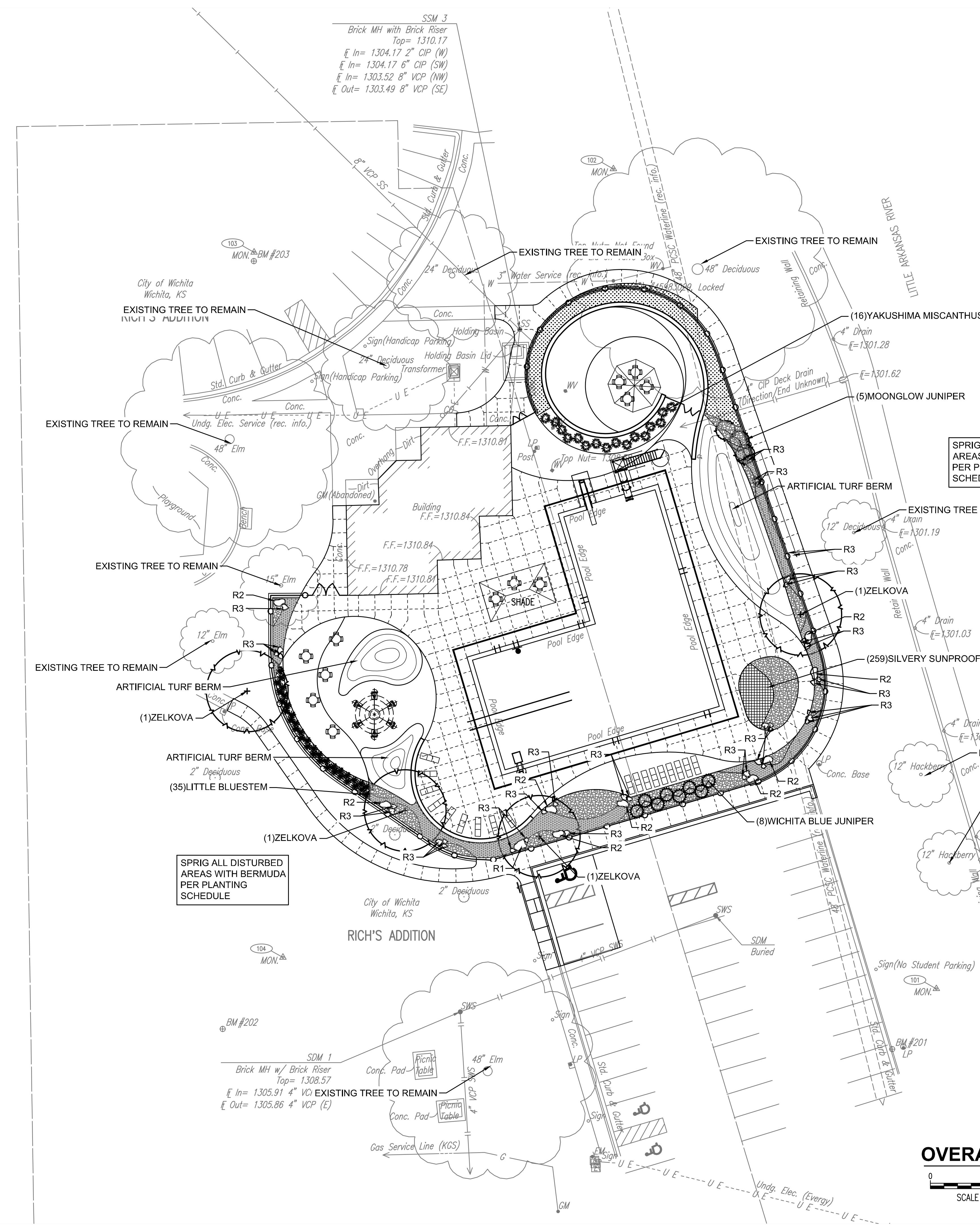

LEGEND

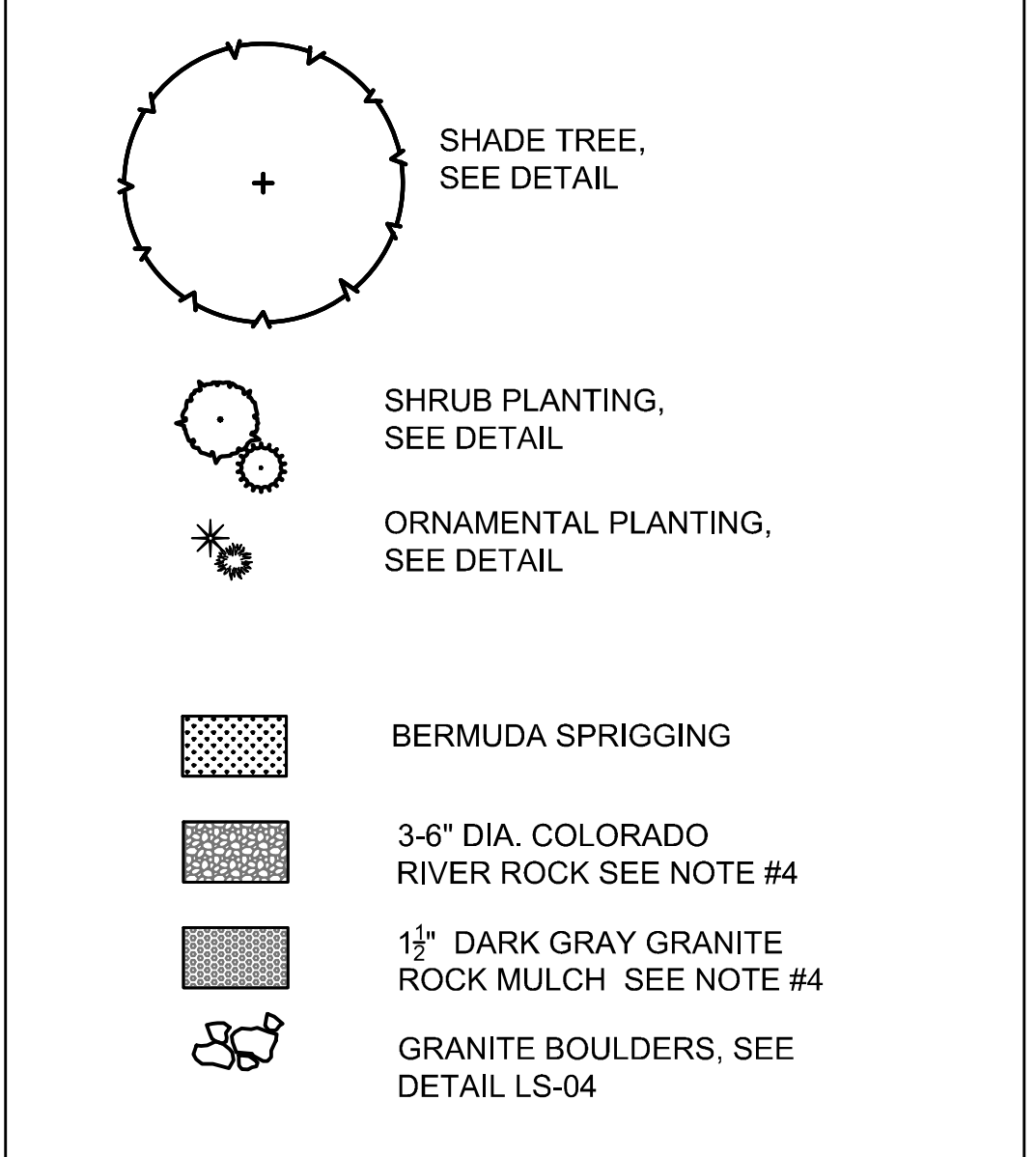

NOTES:

- SEE SHEET LS-04 FOR PLANTING DETAILS AND PLANT LIST.
- SEE SHEET LS-01 FOR PLANT LIST
- ALL SEEDING OPERATIONS SHALL BE PERFORMED PER THE REQUIREMENTS OF THE CITY STANDARD LANDSCAPE SPECIFICATION.
- ROCK MULCH SHALL BE PLACED OVER 5 OZ. NON-WOVEN GEOTEXTILE FABRIC. COORDINATE WITH GRADING PLAN AND ROCK SIZES TO ENSURE A MINIMUM MULCH DEPTH TO ALLOW FOR 2 LAYERS OF ROCK. THE CONTRACTOR SHALL ENSURE THAT NO PORTION OF GEOTEXTILE IS VISIBLE.
- CONTRACTOR SHALL FOLLOW CITY OF WICHITA STANDARD SPECIFICATIONS AND STANDARD SPECIAL PROVISIONS TO THE CITY OF WICHITA STANDARD SPECIFICATIONS FOR LANDSCAPE.
- SPRIG ALL DISTURBED AREAS WITH LATITUDE 36 BERMUDA AT A RATE OF 5 BUSHELS PER ACRE, PER CITY STANDARD SPECIFICATION.
- PROTECT ALL TREES TO REMAIN PER CITY STANDARD SPECIFICATIONS

TREES					
Quercus Phellos Zelkova serrata	Willow Oak Japanese Zelkova	2 1/2\" Cal. 2 1/2\" Cal.	b&b b&b		
Upright Junipers Juniperus scopulorum 'Wichita blue' Juniperus scopulorum 'Moonglow'	Wichita Blue Juniper Moonglow Juniper	6 ft. Height 6 ft. Height	b&b b&b		
PERENNIAL/ GROUND COVER Liriope muscari 'Silvery Sunproof'	Silvery Sunproof Liriope	Perennial	#1	Container	Plant @ 12\" o.c.
ORNAMENTAL GRASSES Miscanthus sinensis Variegatus' Pennisetum orientale 'Karley Rose'	Silver Miscanthus Karley Rose Fountain Grass	Orn. Grass Orn. Grass	#1 #1	Container container	Full & Healthy Full & Healthy
SPRIGGING Latitude 36 sourced locally	Sprig at 5 bushels per acre. Sprigging shall meet the City of Wichita Standard Landscape specification requirements				

BOULDER SCHEDULE

SYMBOL	AVG. SIZE	
	DIA.	HT.
R-1	48\"	48\"
R-2	36\"-48\"	24\"-48\"
R-3	34\"-36\"	12\"-36\"

OVERALL LANDSCAPE PLAN

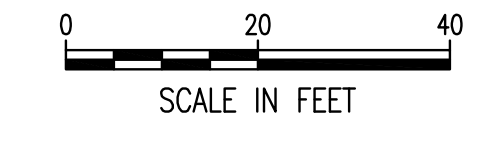

WICHITA, KANSAS
Pool Improvements
MINISA PARK

Seal:

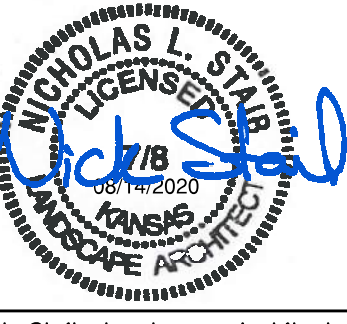

Nick Stalder - Landscape Architect
LICENSE #0718
Date: 08-14-20 Job #: 18-512
Drawn: RFT Checked: NLS
Issue: FOR BID

OVERALL LANDSCAPE PLAN

LS-01