

SWS POINTS			
Point Table			
Point #	Northing	Easting	Desc.
7001	28,214.79	26,264.79	End Sec
7002	28,132.88	26,202.83	MH
7003	27,964.37	26,203.18	CEN 1/S FC
7004	27,967.50	25,897.87	CEN 1/S FC
7005	27,989.91	25,538.57	MH
7006	27,971.90	25,528.07	INLET
7007	27,989.77	25,398.33	MH
7008	27,989.52	25,144.17	MH
7009	28,254.64	25,143.91	MH
7010	28,255.38	24,951.71	MH
7011	28,418.34	24,951.55	INLET
7012	28,429.16	24,913.80	MH
7013	28,552.34	24,951.42	INLET
7014	28,374.50	25,119.43	CEN 1/S FC
7015	28,305.25	25,264.66	INLET
7016	28,536.79	25,264.44	INLET
7017	28,627.85	26,279.78	End Sec
7018	28,665.44	26,238.18	MH
7019	28,799.72	26,205.67	CEN 1/S FC
7020	28,759.04	26,041.20	CEN 1/S FC
7021	28,971.45	25,970.43	INLET
7022	28,971.23	25,812.55	CEN 1/S FC
7023	28,957.36	25,774.75	CEN 1/S FC
7024	28,961.13	25,622.65	INLET
7025	28,986.17	25,627.03	INLET
7026	28,985.98	25,434.17	CEN 1/S FC
7027	28,981.56	25,401.83	CEN 1/S FC
7028	28,981.44	25,274.00	INLET
7029	29,075.88	25,273.91	INLET
7030	29,077.18	25,125.08	CEN 1/S FC
7031	29,077.15	25,092.74	CEN 1/S FC
7032	29,077.01	24,948.91	INLET
7033	27,926.16	26,206.12	CEN 1/S FC
7034	28,166.64	25,898.80	INLET
7035	28,322.64	25,898.65	INLET
7036	28,069.37	25,584.89	INLET
7037	28,195.37	25,584.77	INLET
7038	28,400.86	25,584.57	INLET
7039	28,114.17	25,354.20	CEN 1/S FC
7040	28,741.08	25,584.24	INLET

SWS POINTS			
Point Table			
Point #	Northing	Easting	Desc.
7041	28,698.13	25,584.28	INLET
7042	28,697.98	25,434.45	CEN 1/S FC
7043	28,697.95	25,402.11	CEN 1/S FC
7044	27,413.46	26,820.26	EXMH
7045	27,414.35	26,489.77	MH
7046	27,414.69	26,361.94	CEN 1/S FC
7047	27,414.84	26,303.60	CEN 1/S FC
7048	27,415.16	26,185.77	CEN 1/S FC
7049	27,415.58	26,025.77	CEN 1/S FC
7050	27,416.06	25,848.94	CEN 1/S FC
7051	27,416.89	25,535.53	CEN 1/S FC
7052	27,633.16	26,186.35	INLET
7053	27,543.95	26,021.11	CEN 1/S FC
7054	27,554.75	25,725.47	CEN 1/S FC
7055	27,554.69	26,672.72	CEN 1/S FC
7056	29,369.27	26,830.87	END SEC
7057	29,569.87	26,703.15	CEN 1/S FC
7058	29,595.21	26,683.05	CEN 1/S FC
7059	29,746.94	26,614.87	INLET
7060	29,889.14	26,551.35	CEN 1/S FC
7061	29,914.48	26,514.55	CEN 1/S FC
7062	30,081.33	26,513.44	MH
7063	30,104.18	26,403.69	END SEC
7064	29,974.43	26,201.39	END SEC
7065	29,801.25	26,231.53	CEN 1/S FC
7066	29,761.35	26,228.16	CEN 1/S FC
7067	29,645.40	26,236.47	INLET
7068	29,567.52	26,241.92	INLET
7069	30,209.67	25,491.52	END SEC
7070	30,229.91	25,400.20	CEN 1/S FC
7071	30,201.57	25,374.19	CEN 1/S FC
7072	30,223.56	25,273.05	CEN 1/S FC
7073	30,262.19	25,239.87	CEN 1/S FC
7074	30,208.65	24,948.51	MH
7075	30,228.26	24,918.01	MH
7076	30,379.79	25,233.82	INLET
7077	30,127.65	25,272.89	INLET
7078	30,279.13	25,917.19	END SEC
7079	30,360.18	25,895.40	CEN 1/S FC
7080	30,392.40	25,898.27	CEN 1/S FC

SWS POINTS			
Point Table			
Point #	Northing	Easting	Desc.
7081	30,524.70	25,910.09	INLET
7082	29,475.92	24,950.52	END SEC
7083	29,756.65	24,950.25	INLET
7084	29,475.90	25,103.52	END SEC
7085	29,633.49	25,103.37	CEN 1/S FC
7086	29,473.98	25,273.52	END SEC
7087	29,683.67	25,273.32	INLET
7088	29,388.51	25,552.78	END SEC
7089	29,236.81	25,509.17	CEN 1/S FC
7090	29,199.96	25,498.58	CEN 1/S FC
7091	29,285.90	25,927.84	END SEC
7092	29,563.57	25,916.96	INLET
7093	29,237.73	26,096.04	END SEC
7094	29,408.60	26,080.21	CEN 1/S FC
7095	29,187.88	26,412.61	END SEC
7096	29,189.72	26,453.51	CEN 1/S FC
7097	29,187.87	26,497.65	CEN 1/S FC
7098	29,178.52	26,412.69	END SEC
7099	29,189.00	26,543.39	END SEC
7100	29,179.64	26,543.47	END SEC
7101	30,338.87	25,467.51	END SEC
7102	30,431.78	25,388.06	END SEC
7103	29,661.70	27,155.79	EXMH
7104	29,645.80	27,015.17	CEN 1/S FC
7105	30,250.09	26,429.12	END SEC
7106	30,285.41	26,388.85	CEN 1/S FC
7107	28,587.44	26,623.16	END SEC
7108	28,502.86	26,766.08	CEN 1/S FC
7109	30,444.27	26,483.71	END SEC
7110	30,418.33	26,478.63	END SEC
7111	30,431.78	26,474.62	CL WEIR
7112	30,432.74	26,454.64	CL WEIR
7113	30,070.89	26,141.81	END SEC
7114	30,065.22	26,078.07	END SEC
7115	30,112.95	26,090.56	CL WEIR
7116	30,098.01	26,091.89	CL WEIR
7117	30,099.20	25,760.93	END SEC
7118	30,101.39	25,693.97	END SEC
7119	30,127.11	25,717.32	CL WEIR
7120	30,112.11	25,716.83	CL WEIR

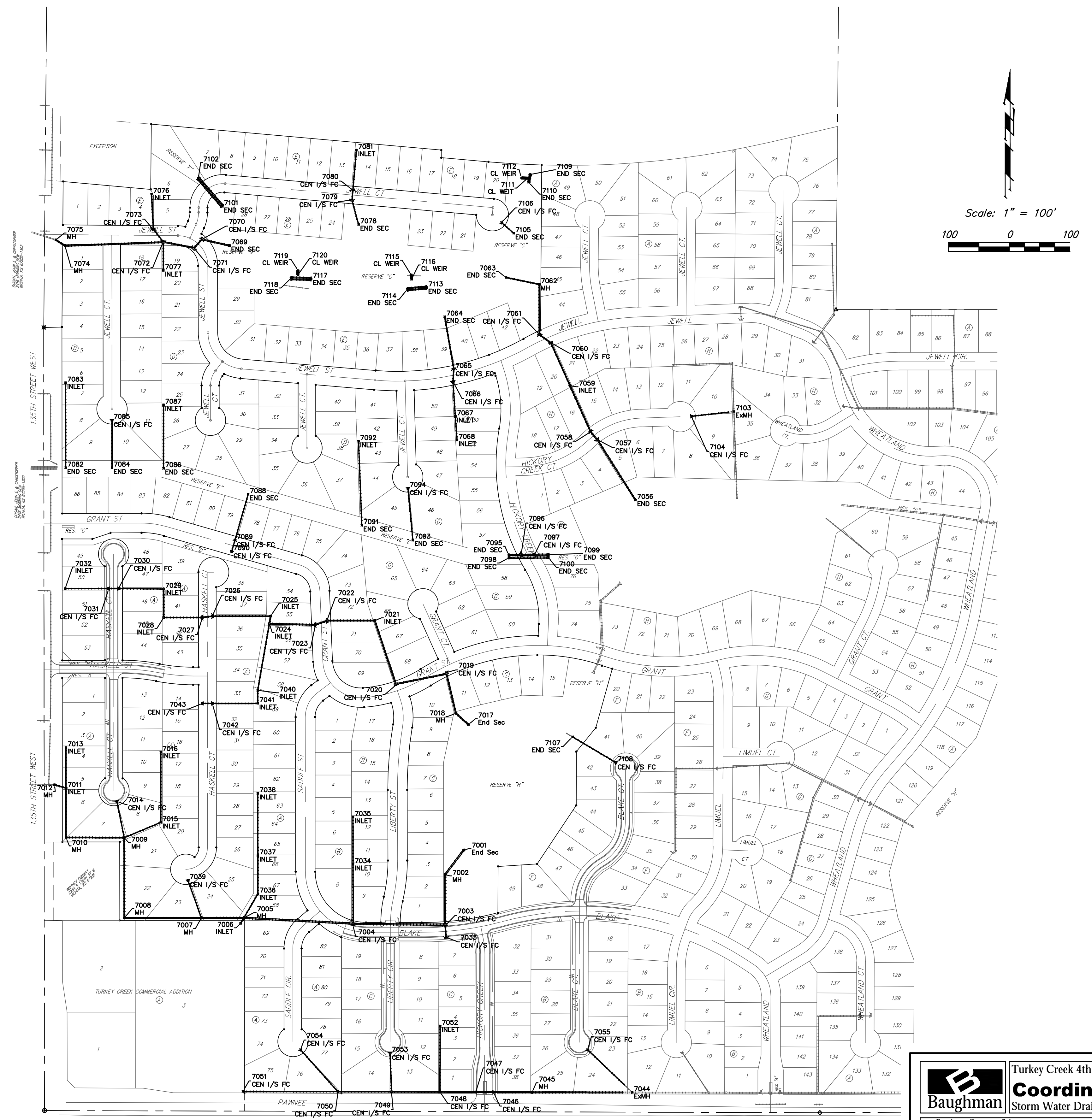

	Turkey Creek 4th Addition Coordinate Sheet Storm Water Drain #467
	<small>Baughman Company, P.A. 315 Ellis St. Wichita, KS 67211 P 316-262-7271 F 316-262-0149 ENGINEERING SURVEYING PLANNING LANDSCAPE ARCHITECTURE</small>
PROJECT NUMBER 468-2020-085444	DESIGN DRAWN DMV JAK
REVISIONS:	APPROVED DATE 9/11/2020
	SCALE Noted
	SHEET 63 OF 65