

BENCHMARKS:
 RR spike in asphalt, SW COR., N1/2, SW1/4, Sec. 34, TWP. 26-S, R-2-E.
 Elev. = 1400.59 NAVD88

RR spike in E. face of power pole,
 174± N. of S. line, N1/2, SW1/4 &
 49± E. of W. line, SW1/4,
 Sec. 34, TWP. 26-S, R-2-E.
 Elev. = 1398.64 NAVD88

RR spike in S. face of power pole,
 294± S. of N. line, SW1/4, &
 48± E. of W. line, SW1/4,
 Sec. 34, TWP. 26-S, R-2-E.
 Elev. = 1386.14 NAVD88

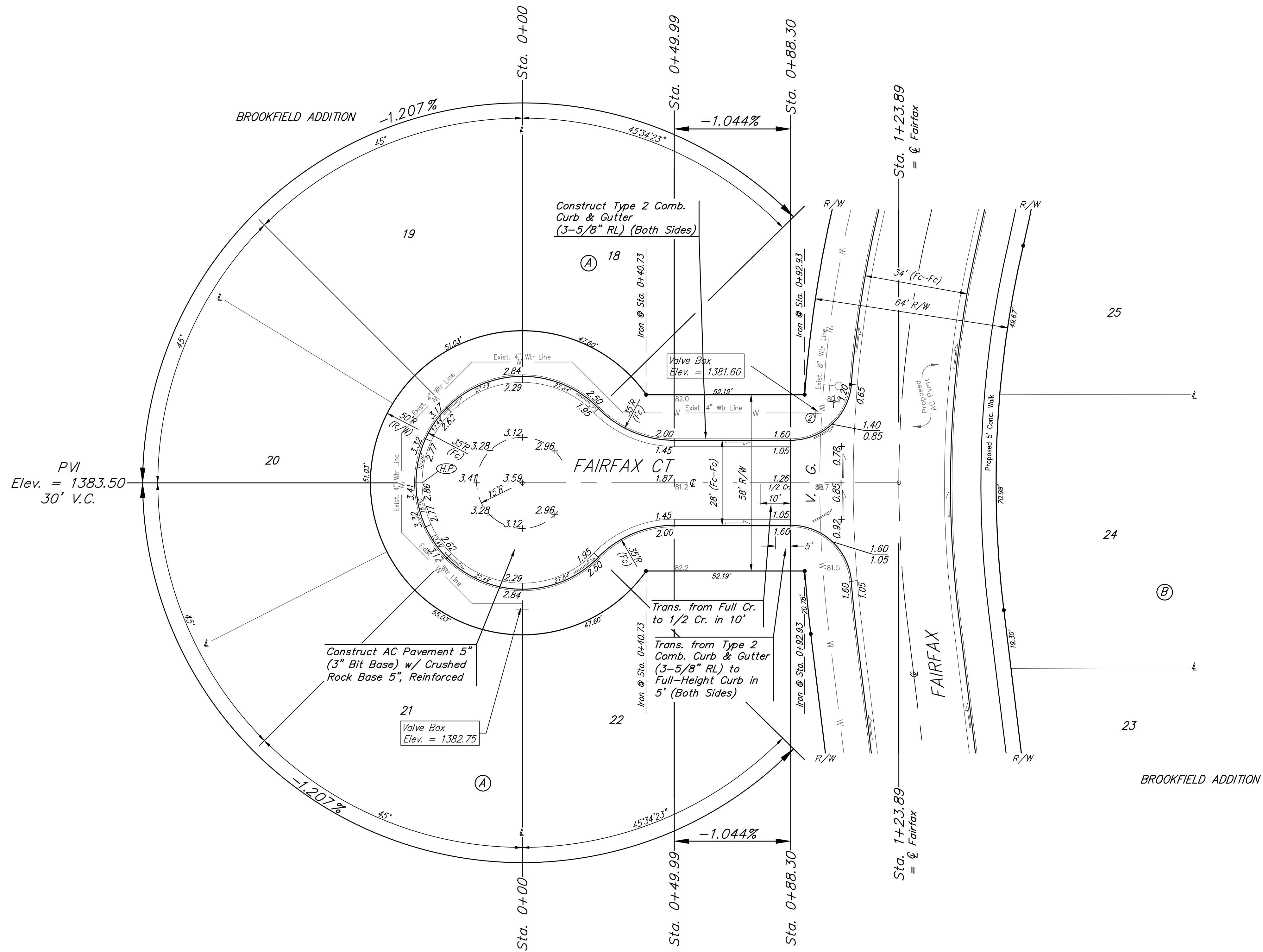
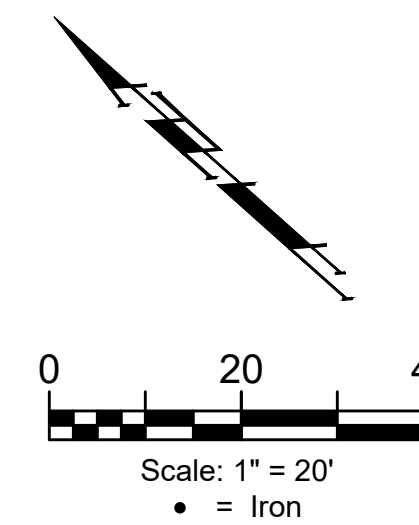

Subdivision Benchmarks

| Street & Station | Location Description | Elevation |
|----------------------------------|---|-----------|
| Fairfax 9+39.82, 17.25' Lt. | Adjacent to Fire Hydrant at the Northeast End of the Northeast Return Fairfax & Fairfax Ct, SE Cor., Lot 18, Blk A, Brookfield Addn. | |
| Crest Cir 2+40.24, 14.25' Rt. | Adjacent to Fire Hydrant West of the NW Cor., Lot 32, Blk A, Brookfield Addn. | |

VALVE LOCATION TABLE

| VALVE NUMBER | STREET | BASELINE STATION | OFFSET DISTANCE | OFFSET DIRECTION |
|--------------|---------------|------------------|-----------------|------------------|
| 1 | Crest | 6+01.64 | 28' | Lt. |
| 2 | Fairfax | 9+30.07 | 28' | Lt. |
| 3 | Brookview Cir | 9+77.49 | 23' | Lt. |
| 4 | Winston Cir. | 5+85.77 | 24' | Lt. |

Roll type curb & gutter to be constructed on the pavement on this sheet.
 Top of curb elevation are given for full height curb.

| | | |
|--|--|--------------------------|
| | Brookfield Addition - Phase 2A | |
| | FAIRFAX CT. Lot 16 - Lot 22, Block B | |
| <small>Baughman Company, P.A. 315 Ellis St. Wichita, KS 67211 P 316-262-7271 F 316-262-0149 ENGINEERING SURVEYING PLANNING LANDSCAPE ARCHITECTURE</small> | | |
| PROJECT NUMBER 472-2020-085623 | DESIGN AEG | DRAWN JAK |
| REVISIONS: | APPROVED | DATE Oct. 19, 2020 |
| | SCALE Noted | SHEET 13 OF 39 |