

**BENCHMARKS**  
 BM#3 - City of Wichita Bench Mark Disc,  
 Located at  
 29th Street, 1/2 mile West of Maize Road.  
 Elev. = 1365.69 MSL (178.29 City Datum)

PRWA REGION NO.	STATE	PROJECT NO.	FISCAL YEAR	SHEET NO.	TOTAL SHEETS
7	KANSAS	87N-0348-01	2007	12	135

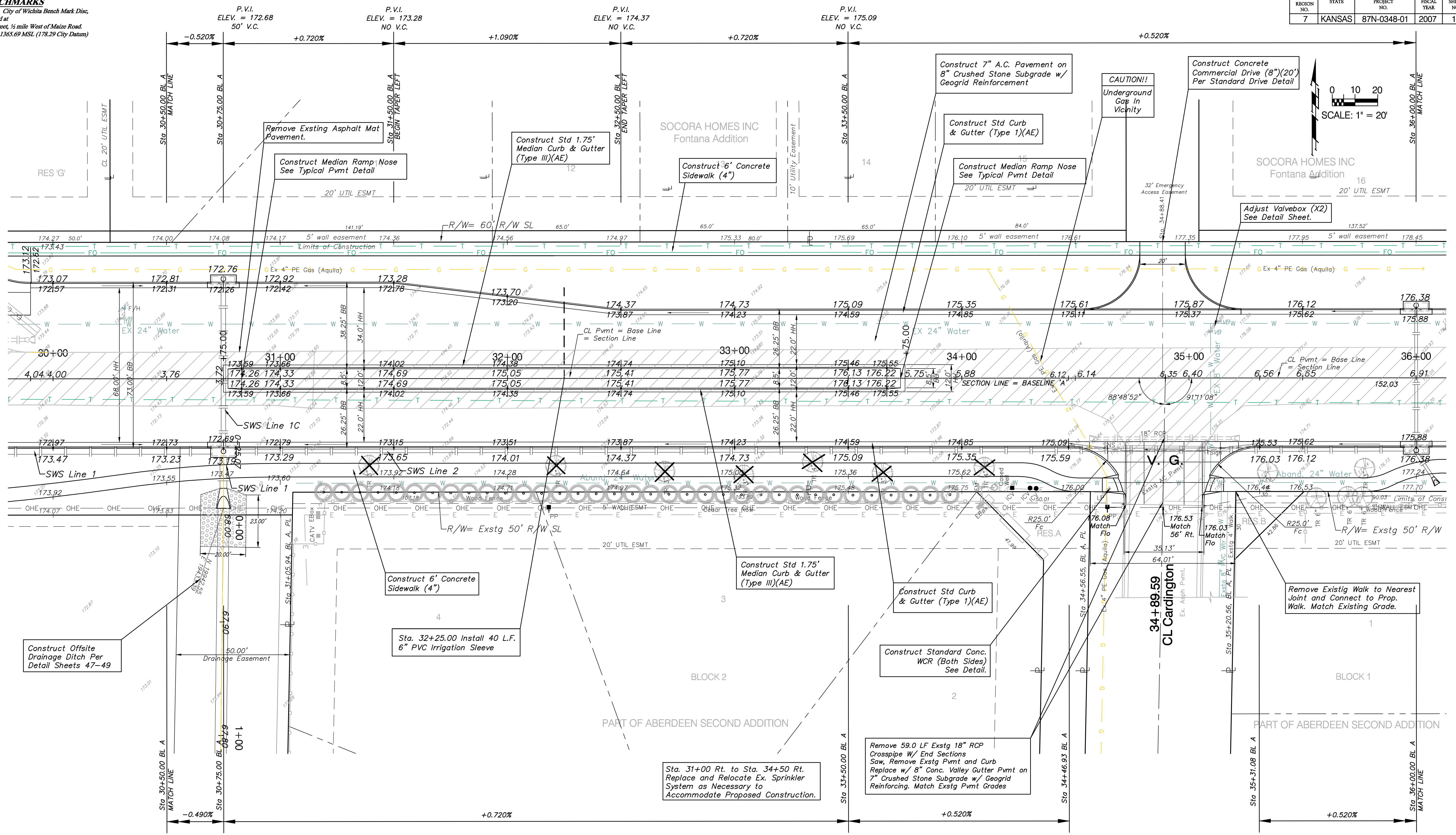

Construct Offsite Drainage Ditch Per Detail Sheets 47-49

P.V.I.  
ELEV. = 173.11  
50' V.C.

P.V.I.  
ELEV. = 175.09  
NO V.C.

**Note:**  
Trees/Shrubs to be removed are marked thus:

**Note:**  
Pavement, Sidewalks, and Etc. To Be Removed Are Indicated By:

Drawing File: F:\eng\29th (Maize-119th)\(Pav06)  
 Design: AZIERE  
 Drawn: SONNY  
 Approved: JFB  
 Scale: NOTED

CAPITAL IMPROVEMENT PROJECT  
**29th Street Paving Plan**  
 Sta. 30+50 to Sta. 36+00  
 29th Street Paving Project - Maize Road to 119th Street

**Baughman Company, P.A.**  
 315 Ellis St. Wichita, KS 67211 P 316-262-7271 F 316-262-0149  
 ENGINEERING | SURVEYING | PLANNING | LANDSCAPE ARCHITECTURE

May, 2007  
 SHEET  
**12**  
 OF  
**135**