

SCALE:  
1" = 40'

EMERY PARK ~ City of Wichita

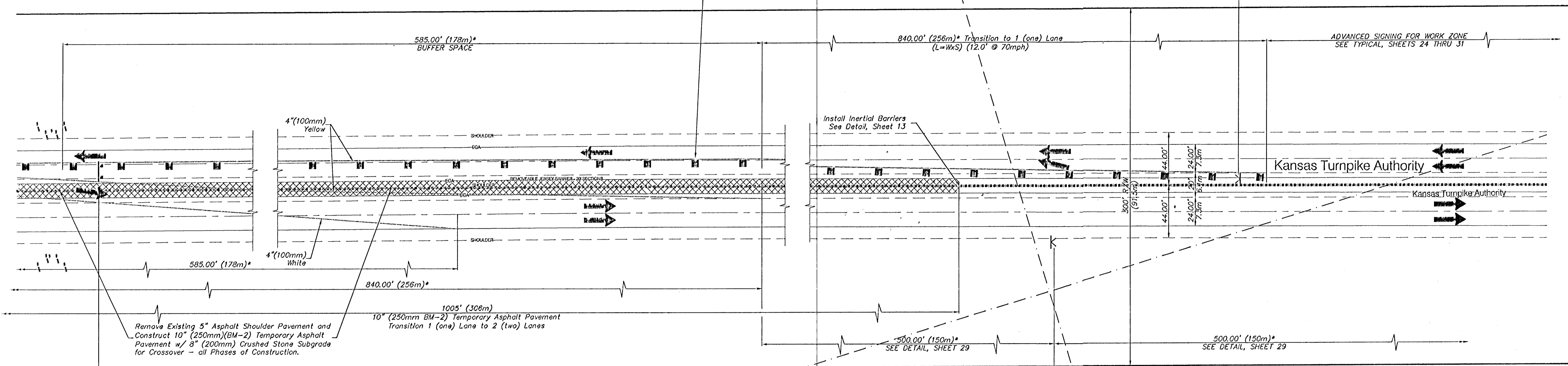
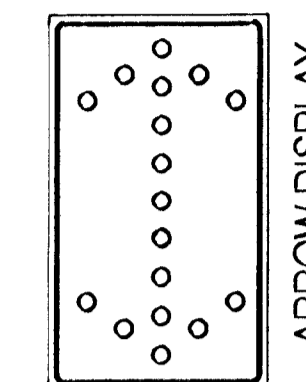

Remove Existing 5" Asphalt Shoulder Pavement and Construct 10" (250mm)(BM-2) Temporary Asphalt Pavement w/ 8" (200mm) Crushed Stone Subgrade for Crossover - all Phases of Construction.

1005' (306m)  
10" (250mm BM-2) Temporary Asphalt Pavement  
Transition 1 (one) Lane to 2 (two) Lanes

500.00' (150m)\*  
SEE DETAIL, SHEET 29

500.00' (150m)\*  
SEE DETAIL, SHEET 29

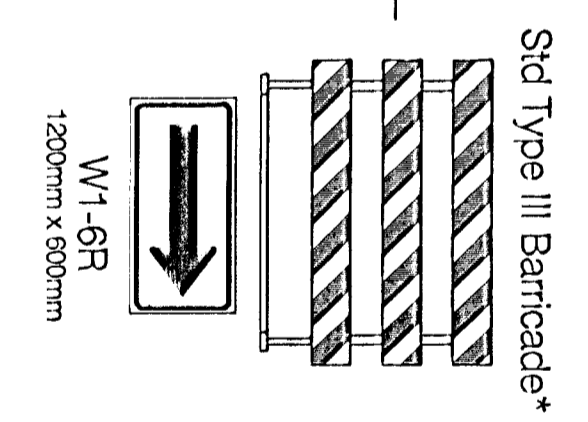

KTA

\*NOTE: All Signing and Channelization on this Project shall be done in accordance with specifications set forth in the current Manual on Uniform Traffic Control Devices and referenced KDOT TYPICAL SHEETS (See Sheets 24 thru 31)

NOTE:  
Existing Concrete Median Barrier to Remain In Place Throughout all Phases of Construction except where removal is necessary for Traffic Control and Construction Excavation. Removed Concrete Median Barrier to be Stockpiled on Site away from Traffic and Construction Operations until Re-installed.

Boeing Property

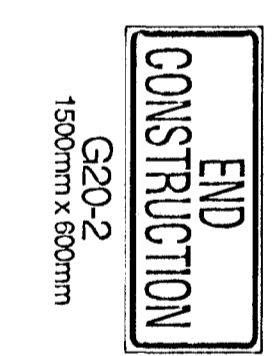

PROJECT NUMBER 472-76-245-83324		SHEET NAME TC03	ENGINEERING DIRECTORY F:\Hydraulic\KTA	CAPITAL IMPROVEMENT PROJECT		SHEET 11 OF 36
DESIGN TPV	DRAWN STAFF	APPROVED JFB	DATE FEB 2001	SCALE NOTED	BAUGHMAN NO 99-09-E543	

TRAFFIC CONTROL PLAN in conjunction  
with RCBC CONSTRUCTION UNDER K.T.A.  
HYDRAULIC AVENUE PAVING - INCIDENTAL DRAINAGE IMPROVEMENTS - PHASE 1

BAUGHMAN COMPANY, P.A.  
ENGINEERING, SURVEYING, & PLANNING  
318-262-7271 • 315 ELLIS • WICHITA, KANSAS 67211