

BENCHMARK:

BM #4 - RR Spike in West face of 2nd HLP, South of 43rd St. South, East side of Hydraulic. Sta. 16+05, 34' Rt. Elev. = 82.34 (City Datum)

BM #5 - City of Wichita Bench Mark Disc, 35' South and 25' East of Centerlines Hydraulic and 43rd St. South. Elev. = 82.13 (City Datum)

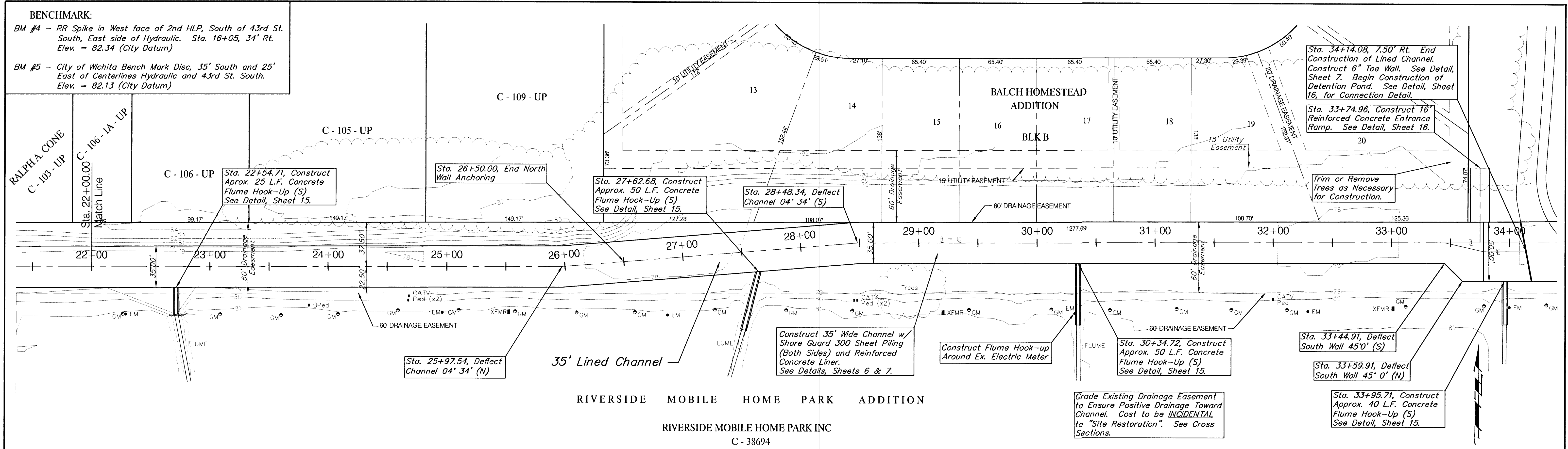

SCALE:
1" = 40' HORIZONTAL
1" = 5' VERTICAL

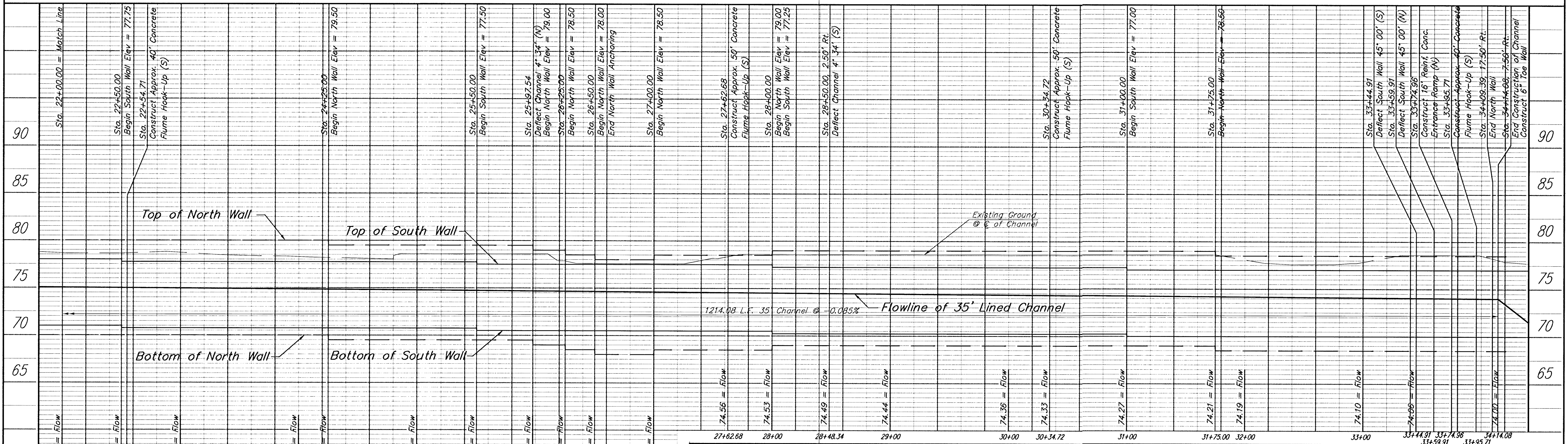

PROJECT NUMBER 472-76-245-83324		SHEET NAME Channel02		ENGINEERING DIRECTORY F:\Hydraulic\Pond	
DESIGN TPV/JFB	DRAWN TPV	APPROVED JFB	DATE Sept 2001	SCALE Noted	BAUGHMAN NO 99-09-E453

CAPITAL IMPROVEMENT PROJECT
35' Channel Plan and Profile
Sta. 22+00 to Sta 34+14.08
HYDRAULIC AVENUE PAVING - INCIDENTAL DRAINAGE PROJECT - PHASE 1

BAUGHMAN COMPANY, P.A.
ENGINEERING, SURVEYING, & PLANNING
318-262-7271 • 315 ELLIS • WICHITA, KANSAS 67211